

1400 Colonial Blvd., Suite 1  
Fort Myers, FL 33907



P: 239.938.1813 | F: 239.938.1817  
www.swfRPC.org

## COUNCIL MEETING AGENDA

September 20, 2018

9:00am – 11:00am

### **Mission Statement:**

*To work together across neighboring communities to consistently protect and improve the unique and relatively unspoiled character of the physical, economic and social worlds we share...for the benefit of our future generations.*

<b>1</b>	<b>INVOCATION</b>	
<b>2</b>	<b>PLEDGE OF ALLEGIANCE</b>	
<b>3</b>	<b>ROLL CALL</b>	
<b>4</b>	<b>PUBLIC COMMENTS</b>	
<b>5</b>	<b>AGENDA</b>	Page 1
<b>6</b>	<b>MINUTES OF THE JUNE 21, 2018 MEETING</b>	Page 16
<b>7</b>	<b>REGIONAL IMPACT</b>	Page 24
	a) Palmer Ranch Increment 28 Staff Assessment	Page 40
<b>8</b>	<b>CONSENT AGENDA</b>	Page 52
	a) Intergovernmental Coordination and Review	Page 54
	b) CEDS Annual Update	Page 57
<b>9</b>	<b>PRESENTATIONS</b>	
	a) Council Relevancy	
	b) Southwest Florida Full-Scale HazMat Exercise	
<b>10</b>	<b>DIRECTOR'S REPORT</b>	Page 77
	a) Budget Amendments	Page 80
	b) May-July 2018 Financials	Page 82
	c) Promise Zone Update	
	d) Disaster Recovery Coordinator Update	
	e) Biosolids Resolution	Page 104
<b>11</b>	<b>STAFF SUMMARIES</b>	
	a) Grant Activity Sheet (Information Only)	Page 114
<b>12</b>	<b>COMMITTEE REPORTS</b>	
	a) Executive Committee – <b>Chair Thomas Perry</b>	
	- Budget & Finance Committee	
	- Legislative Affairs Committee	
	- Economic Development Committee	
	b) Promise Zone Steering Committee	

Two or more members of the Peace River Basin Management Advisory Committee and Charlotte Harbor National Estuary Program may be in attendance and may discuss matters that could come before the Peace River Basin Management Advisory Committee and Charlotte Harbor National Estuary Program, respectively, for consideration.

In accordance with the Americans with Disabilities Act (ADA), any person requiring special accommodations to participate in this meeting should contact the Southwest Florida Regional Planning Council 48 hours prior to the meeting by calling (239) 338-2550; if you are hearing or speech impaired call (800) 955-8770 Voice/(800) 955-8771 TDD.

1400 Colonial Blvd., Suite 1  
Fort Myers, FL 33907



P: 239.938.1813 | F: 239.938.1817  
www.swfRPC.org

- c) Estero Bay Agency on Bay Management Committee – **Mr. James Beever**
- d) Quality of Life & Safety Committee – **Commissioner Willie Shaw**
- e) Regional Transportation Committee – **Ms. Margaret Wuerstle**
- f) Council Relevancy & Restructuring Committee
- g) Water Quality & Water Resources Management - **Vice Mayor Mick Denham**

**13 NEW BUSINESS**

**14 STATE AGENCIES COMMENTS/REPORTS**

**15 COUNCIL LEGAL CONSULTANT'S COMMENTS**

**16 COUNCIL MEMBERS' COMMENTS**

**17 ADJOURN**

**NEXT SWFRPC MEETING DATE: OCTOBER 18, 2018**

Two or more members of the Peace River Basin Management Advisory Committee and Charlotte Harbor National Estuary Program may be in attendance and may discuss matters that could come before the Peace River Basin Management Advisory Committee and Charlotte Harbor National Estuary Program, respectively, for consideration.

In accordance with the Americans with Disabilities Act (ADA), any person requiring special accommodations to participate in this meeting should contact the Southwest Florida Regional Planning Council 48 hours prior to the meeting by calling (239) 338-2550; if you are hearing or speech impaired call (800) 955-8770 Voice/(800) 955-8771 TDD.

# SOUTHWEST FLORIDA REGIONAL PLANNING COUNCIL MEMBERSHIP

## ***OFFICERS***

***Mr. Thomas Perry, Chair***

***Commissioner Willie Shaw, Vice-Chair***

***Commissioner Donna Storter-Long, Secretary***

***Mr. Donald McCormick, Treasurer***

## ***CHARLOTTE COUNTY***

## ***COLLIER COUNTY***

Commissioner Joe Tiseo, Charlotte BCC

Commissioner Bill McDaniel, Collier BCC

Commissioner Ken Doherty, Charlotte BCC

Commissioner Penny Taylor, Collier BCC

Vice-Mayor Gary Wein, City of Punta Gorda

Councilman Reg Buxton, City of Naples

Mr. Donald McCormick, Governor Appointee

(City of Marco Island Vacancy)

Ms. Suzanne Graham, Governor Appointee

Mr. Robert "Bob" Mulhere, Governor Appointee

(Governor Appointee Vacancy)

## ***GLADES COUNTY***

## ***HENDRY COUNTY***

Commissioner Donna Storter-Long, Glades BCC

Commissioner Emma Byrd, Hendry BCC

Commissioner Donald Strenth, Glades BCC

Commissioner Mitchell Wills, Hendry BCC

Councilwoman Pat Lucas, City of Moore Haven

Vice-Mayor Michael Atkinson, City of Clewiston

Mr. Thomas Perry, Governor Appointee

Commissioner Julie Wilkins, City of LaBelle

Mr. Mel Karau, Governor Appointee

## ***LEE COUNTY***

## ***SARASOTA COUNTY***

Commissioner Brian Hamman, Lee BCC

Commissioner Mike Moran, Sarasota BCC

Commissioner Cecil Pendergrass, Lee BCC

Commissioner Charles Hines, Sarasota BCC

Councilman Fred Burson, City of Fort Myers

Commissioner Willie Shaw, City of Sarasota

Councilmember Anita Cereceda, Town of Fort Myers  
Beach

Councilmember Mitzie Fiedler, City of Venice

Vice-Mayor Mick Denham, City of Sanibel

Mr. Felipe Colon, Governor Appointee

Councilman Greg DeWitt, City of Bonita Springs

(Governor Appointee Vacancy)

(Governor Appointee Vacancy)

(Governor Appointee Vacancy)

## ***EX-OFFICIO MEMBERS***

Jon Iglehart, FDEP

Wayne Gather, FDOT

Phil Flood, SFWMD

Dennis Ragosta, SWFWMD

## ***STAFF***

Margaret Wuerstle, Executive Director

Beth Nightingale, Legal Consultant

James Beever

Rebekah Harp

Charles Kammerer

Sean McCabe

## **SOUTHWEST FLORIDA REGIONAL PLANNING COUNCIL (SWFRPC) ACRONYMS**

ABM - Agency for Bay Management - Estero Bay Agency on Bay Management

ADA - Application for Development Approval

ADA - Americans with Disabilities Act

AMDA -Application for Master Development Approval

BEBR - Bureau of Economic Business and Research at the University of Florida

BLID - Binding Letter of DRI Status

BLIM - Binding Letter of Modification to a DRI with Vested Rights

BLIVR -Binding Letter of Vested Rights Status

BPCC -Bicycle/Pedestrian Coordinating Committee

CAC - Citizens Advisory Committee

CAO - City/County Administrator Officers

CDBG - Community Development Block Grant

CDC - Certified Development Corporation (a.k.a. RDC)

CEDS - Comprehensive Economic Development Strategy (a.k.a. OEDP)

CHNEP - Charlotte Harbor National Estuary Program

CTC - Community Transportation Coordinator

CTD - Commission for the Transportation Disadvantaged

CUTR - Center for Urban Transportation Research

DEO - Department of Economic Opportunity

DEP - Department of Environmental Protection



DO - Development Order

DOPA - Designated Official Planning Agency (i.e. MPO, RPC, County, etc.)

EDA - Economic Development Administration

EDC - Economic Development Coalition

EDD - Economic Development District

EPA – Environmental Protection Agency

FAC - Florida Association of Counties

FACTS - Florida Association of CTCs

FAR - Florida Administrative Register (formerly Florida Administrative Weekly)

FCTS - Florida Coordinated Transportation System

FDC&F -Florida Department of Children and Families (a.k.a. HRS)

FDEA - Florida Department of Elder Affairs

FDLES - Florida Department of Labor and Employment Security

FDOT - Florida Department of Transportation

FHREDI - Florida Heartland Rural Economic Development Initiative

FIAM – Fiscal Impact Analysis Model

FLC - Florida League of Cities

FQD - Florida Quality Development

FRCA -Florida Regional Planning Councils Association

FTA - Florida Transit Association

IC&R - Intergovernmental Coordination and Review

IFAS - Institute of Food and Agricultural Sciences at the University of Florida

JLCB - Joint Local Coordinating Boards of Glades & Hendry Counties

JPA - Joint Participation Agreement

JSA - Joint Service Area of Glades & Hendry Counties

LCB - Local Coordinating Board for the Transportation Disadvantaged

LEPC - Local Emergency Planning Committee

MOA - Memorandum of Agreement

MPO - Metropolitan Planning Organization

MPOAC - Metropolitan Planning Organization Advisory Council

MPOCAC - Metropolitan Planning Organization Citizens Advisory Committee

MPOTAC - Metropolitan Planning Organization Technical Advisory Committee

NADO – National Association of Development Organizations

NARC -National Association of Regional Councils

NOPC -Notice of Proposed Change

OEDP - Overall Economic Development Program

PDA - Preliminary Development Agreement

REMI – Regional Economic Modeling Incorporated

RFB - Request for Bids

RFI – Request for Invitation

RFP - Request for Proposals

RPC - Regional Planning Council

SHIP -State Housing Initiatives Partnership

SRPP – Strategic Regional Policy Plan

TAC - Technical Advisory Committee

TDC - Transportation Disadvantaged Commission (a.k.a. CTD)

TDPN - Transportation Disadvantaged Planners Network

TDSP - Transportation Disadvantaged Service Plan

USDA - US Department of Agriculture

WMD - Water Management District (SFWMD and SWFWMD)



Apalachee • Central Florida  
 East Central Florida • North Central Florida  
 Northeast Florida • South Florida • Southwest Florida  
 Tampa Bay • Treasure Coast • West Florida • Withlacoochee

104 West Jefferson Street, Tallahassee, FL 32301-1713 • 850.224.3427

## Regional Planning Council Functions and Programs

March 4, 2011

- **Economic Development Districts:** Regional planning councils are designated as Economic Development Districts by the U. S. Economic Development Administration. From January 2003 to August 2010, the U. S. Economic Development Administration invested \$66 million in 60 projects in the State of Florida to create/retain 13,700 jobs and leverage \$1 billion in private capital investment. Regional planning councils provide technical support to businesses and economic developers to promote regional job creation strategies.
- **Emergency Preparedness and Statewide Regional Evacuation:** Regional planning councils have special expertise in emergency planning and were the first in the nation to prepare a Statewide Regional Evacuation Study using a uniform report format and transportation evacuation modeling program. Regional planning councils have been preparing regional evacuation plans since 1981. Products in addition to evacuation studies include Post Disaster Redevelopment Plans, Hazard Mitigation Plans, Continuity of Operations Plans and Business Disaster Planning Kits.
- **Local Emergency Planning:** Local Emergency Planning Committees are staffed by regional planning councils and provide a direct relationship between the State and local businesses. Regional planning councils provide thousands of hours of training to local first responders annually. Local businesses have developed a trusted working relationship with regional planning council staff.
- **Homeland Security:** Regional planning council staff is a source of low cost, high quality planning and training experts that support counties and State agencies when developing a training course or exercise. Regional planning councils provide cost effective training to first responders, both public and private, in the areas of Hazardous Materials, Hazardous Waste, Incident Command, Disaster Response, Pre- and Post-Disaster Planning, Continuity of Operations and Governance. Several regional planning councils house Regional Domestic Security Task Force planners.
- **Multipurpose Regional Organizations:** Regional planning councils are Florida's only multipurpose regional entities that plan for and coordinate intergovernmental solutions on multi-jurisdictional issues, support regional economic development and provide assistance to local governments.
- **Problem Solving Forum:** Issues of major importance are often the subject of regional planning council-sponsored workshops. Regional planning councils have convened regional summits and workshops on issues such as workforce housing, response to hurricanes, visioning and job creation.
- **Implementation of Community Planning:** Regional planning councils develop and maintain Strategic Regional Policy Plans to guide growth and development focusing on economic development, emergency preparedness, transportation, affordable housing and resources of regional significance. In addition, regional planning councils provide coordination and review of various programs such as Local Government Comprehensive Plans, Developments of Regional Impact and Power Plant Ten-year Siting Plans. Regional planning council reviewers have the local knowledge to conduct reviews efficiently and provide State agencies reliable local insight.

- **Local Government Assistance:** Regional planning councils are also a significant source of cost effective, high quality planning experts for communities, providing technical assistance in areas such as: grant writing, mapping, community planning, plan review, procurement, dispute resolution, economic development, marketing, statistical analysis, and information technology. Several regional planning councils provide staff for transportation planning organizations, natural resource planning and emergency preparedness planning.
- **Return on Investment:** Every dollar invested by the State through annual appropriation in regional planning councils generates 11 dollars in local, federal and private direct investment to meet regional needs.
- **Quality Communities Generate Economic Development:** Businesses and individuals choose locations based on the quality of life they offer. Regional planning councils help regions compete nationally and globally for investment and skilled personnel.
- **Multidisciplinary Viewpoint:** Regional planning councils provide a comprehensive, multidisciplinary view of issues and a forum to address regional issues cooperatively. Potential impacts on the community from development activities are vetted to achieve win-win solutions as council members represent business, government and citizen interests.
- **Coordinators and Conveners:** Regional planning councils provide a forum for regional collaboration to solve problems and reduce costly inter-jurisdictional disputes.
- **Federal Consistency Review:** Regional planning councils provide required Federal Consistency Review, ensuring access to hundreds of millions of federal infrastructure and economic development investment dollars annually.
- **Economies of Scale:** Regional planning councils provide a cost-effective source of technical assistance to local governments, small businesses and non-profits.
- **Regional Approach:** Cost savings are realized in transportation, land use and infrastructure when addressed regionally. A regional approach promotes vibrant economies while reducing unproductive competition among local communities.
- **Sustainable Communities:** Federal funding is targeted to regions that can demonstrate they have a strong framework for regional cooperation.
- **Economic Data and Analysis:** Regional planning councils are equipped with state of the art econometric software and have the ability to provide objective economic analysis on policy and investment decisions.
- **Small Quantity Hazardous Waste Generators:** The Small Quantity Generator program ensures the proper handling and disposal of hazardous waste generated at the county level. Often smaller counties cannot afford to maintain a program without imposing large fees on local businesses. Many counties have lowered or eliminated fees, because regional planning council programs realize economies of scale, provide businesses a local contact regarding compliance questions and assistance and provide training and information regarding management of hazardous waste.
- **Regional Visioning and Strategic Planning:** Regional planning councils are conveners of regional visions that link economic development, infrastructure, environment, land use and transportation into long term investment plans. Strategic planning for communities and organizations defines actions critical to successful change and resource investments.
- **Geographic Information Systems and Data Clearinghouse:** Regional planning councils are leaders in geographic information systems mapping and data support systems. Many local governments rely on regional planning councils for these services.

# Agenda Item

1

Invocation

1

1

_____	Agenda
_____	Item

2

Pledge of Allegiance

2

2

# Agenda Item

3

Roll Call

3

3



# Agenda Item

4

Public Comments

4

4

# Agenda Item

5

Agenda

5

5

# Agenda Item

6

Minutes

6

6

**MINUTES OF THE  
SOUTHWEST FLORIDA REGIONAL PLANNING COUNCIL  
JUNE 21, 2018 MEETING**

The meeting of the Southwest Florida Regional Planning Council was held on June 21, 2018 at the offices of the Southwest Florida Regional Planning Council-1400 Colonial Boulevard, Suite #1 in Fort Myers, Florida. Chair Perry called the meeting to order at 9:01 AM. Commissioner Shaw then led an invocation and the Pledge of Allegiance. Ms. Margaret Wuerstle conducted the roll call and announced that a quorum was not present.

**MEMBERS PRESENT**

**Charlotte County:** Commissioner Ken Doherty, Commissioner Joe Tiseo, Vice-Mayor Gary Wein

**Collier County:** Commissioner Bill McDaniel, Mr. Bob Mulhere

**Glades County:** Commissioner Donna Storter-Long, Commissioner Donald Strenth, Mr. Thomas Perry

**Hendry County:** Commissioner Emma Byrd, Commissioner Julie Wilkins, Mr. Mel Karau

**Lee County:** Vice-Mayor Mick Denham, Councilman Fred Burson, Councilman Greg DeWitt,

**Sarasota County:** Commissioner Charles Hines, Commissioner Willie Shaw

**Ex-Officio:** David Agacinski-FDOT

**MEMBERS ABSENT**

**Charlotte County:** Mr. Don McCormick, Ms. Suzanne Graham

**Collier County:** Commissioner Penny Taylor, Councilman Reg Buxton

**Glades County:** Councilwoman Pat Lucas

**Hendry County:** Commissioner Mitchell Wills, Vice-Mayor Michael Atkinson,

**Lee County:** Commissioner Cecil Pendergrass, Commissioner Brian Hamman, Councilwoman Anita Cereceda

**Sarasota County:** Commissioner Michael Moran, Councilmember Mitzie Fielder, Mr. Felipe Colón

**Ex-Officio:** Mr. Phil Flood-SFWMD, Mr. Jon Iglehart-FDEP,  
Mr. Dennis Ragosta- SWFWMD

**AGENDA ITEM #4  
PUBLIC COMMENTS**

No public comments were made at this time.

**AGENDA ITEM #5  
AGENDA**

There were no changes made to the June 21, 2018 agenda.

**AGENDA ITEM #8  
DIRECTOR'S REPORT**

**AGENDA ITEM #8(f)  
Disaster Recovery Coordinator Update**

Ms. Wuerstle announced that Mr. Sean McCabe has been hired to fill the Disaster Recovery Coordinator position. The previous coordinator accepted a full-time position with the City of Bonita Springs. Mr. McCabe explained that the purpose of the coordinator is to communicate with local governments and alert them to funding opportunities and strategies to help with long term recovery from Hurricane Irma and gaining economic resiliency. He has already met with a few governments and discussed topic such as affordable housing.

**AGENDA ITEM #8(e)  
Promise Zone Update**

Ms. Wuerstle reiterated that communities outside of the Promise Zone can receive bonus points on their grants if the project creates a direct benefit for Promise Zone communities. The RPC was asked by the VISTA program to take on three additional VISTA volunteers, one for Dress for Success, one for the Harry Chapin Food Bank, and one for clinic in East Naples.

**At this point in the meeting the Council gained a quorum.**

**AGENDA ITEM #8(a)  
FY 19 Proposed Budget**

Ms. Wuerstle presented the proposed FY 19 SWFRPC budget. She explained that the loss of revenue from local assessments is \$324,706. The deficit in the budget is \$369,633, which the Council hopes to make up with grant funding. Ms. Wuerstle explained that this deficit amount is consistent with the past few years and those deficits have been filled with additional grant funding.

Vice-Mayor Denham was concerned about the Council's revenues. He asked about the risk of the local assessment figure being decreased further. Ms. Wuerstle explained that the budgeted amount only includes the counties and cities that have not given any indication that they will pull funding. Vice-Mayor Denham then asked about the risk of not meeting the Program Development amount (the deficit that needed to be filled by additional grant funds), since over a third of total revenue is in this line item. Ms. Wuerstle responded that the Council has over \$500,000 of currently pending potential grant funding. The RPC will continue to apply for grants to fill that deficit and the RPC has a track record of filling similarly sized deficits. However, there is no guarantee that the deficit will be filled. Vice-Mayor Denham asked if the decreased role of the RPCs in state planning will affect the RPC's ability to secure grant funding.

Commissioner McDaniel requested that the vote be made soon so that he could get back to the Collier County budget meeting. He believed that this conversation, while valid, has gone off track of voting on the budget. Vice-Mayor Denham explained that the conversation is on topic and necessary for his understanding of the proposed budget. Mr. Perry recognized Commissioner McDaniel's request to expedite this discussion and explained that most of the RPC's grant funding is federal and the change in state statutes does not affect the RPC's ability to receive federal funding. Commissioner Doherty added that the budget shows roughly \$700,000 in investments that could be used to fill any deficit that cannot be filled by grant funding. He added that he shares Vice-Mayor Denham's concern, but also recognizes that there is a safety net in place. Commissioner Wilkins also added that budget amendments could be made throughout the year. Chair Perry noted that only a small amount of the Council's revenue comes from its members and the grant funding is imperative.

**A motion was made by Councilman Burson to approve the FY 19 Proposed Budget as presented. The motion was seconded by Commissioner Shaw and passed.**

#### **AGENDA ITEM #8(c) Audit Report**

Mr. Jeff Tuscan gave the report on the FY 2016-2017 audit. They gave an 'unmodified opinion', which is the highest possible opinion. However, there is a 'matter of emphasis' section about the counties and cities withdrawing funding from the RPC. He stated that the finances of the RPC are a concern. By rule, the entity must survive a year from the date of the audit which would be through FY 2019. Chair Perry and Ms. Wuerstle were confident in the RPC's ability to survive past that time, so Mr. Tuscan did not qualify the report for a going concern issue, but it was noted.

**A motion was made by Mr. Mulhere to approve the Audit Report as presented. The motion was seconded by Commissioner Shaw and passed unanimously.**

There is an accompanying resolution (SWFRPC Resolution #2018-02) that acknowledges compliance with the Florida Statutes regarding any surplus funds. Ms. Wuerstle explained that the RPC has always done what is required and the resolution confirms that.

**A motion was made by Mr. Mulhere to approve SWFRPC Resolution #2018-02 as presented. The motion was seconded by Commissioner Shaw and passed unanimously.**

**AGENDA ITEM #7  
CONSENT AGENDA**

A motion was made by Mr. Mulhere to approve the consent agenda as presented. The motion was seconded by Commissioner Shaw and passed unanimously.

**AGENDA ITEM #6  
MINUTES OF THE MAY 17, 2018 MEETINGS**

A motion was made by Commissioner Wilkins to approve the May 17, 2018 minutes as presented. The motion was seconded by Commissioner Shaw and passed unanimously.

**AGENDA ITEM #8(b)  
April 2018 Financials**

Ms. Wuerstle presented the financials. She explained that the Council is right on schedule and there are no inconsistencies with previous years.

A motion was made by Mr. Mulhere to approve budget amendments as presented. The motion was seconded by Commissioner Shaw and passed unanimously.

**AGENDA ITEM #8(d)  
July-August 2018 Meeting Dates**

Ms. Wuerstle explained that historically it has been difficult to gain a quorum in July and August because the County Commissions and City Councils are on break.

A motion was made by Commissioner Wilkins to cancel the July and August 2018 Meetings. The motion was seconded by Commissioner Strenth and passed unanimously.

**AGENDA ITEM #9  
STAFF SUMMARIES**

**AGENDA ITEM #9(a)  
Grant Activity Sheet**

This item was for informational purposes only.

**AGENDA ITEM #10  
COMMITTEE REPORTS**

**AGENDA ITEM #10(a)  
Executive Committee**

Chair Perry explained that the Executive Committee has been busy during the last month. They have met to discuss the budget and audit.

**AGENDA ITEM #10(b)**  
**Promise Zone Steering Committee**

No report was given at this time. They are trying to determine a meeting date.

**AGENDA ITEM #10(c)**  
**Estero Bay Agency on Bay Management (EBABM) Committee**

There is a poll out to determine a meeting date and time.

**AGENDA ITEM #10(d)**  
**Quality of Life & Safety Committee**

No report was given at this time.

**AGENDA ITEM #10(e)**  
**Regional Transportation Committee**

Mr. Tim Walker is continuing to add to the Regional Transportation Map.

**AGENDA ITEM #10(f)**  
**Council Relevancy & Restructuring Committee**

Chair Perry stated that the Committee had a productive meeting and plans to meet again in late July, or early August. He invited all Council members to attend. There will be a presentation at the Council meeting in September.

**AGENDA ITEM #10(g)**  
**Water Quality and Water Resources Management Committee**

Vice-Mayor Denham handed out copies of letters sent to the Army Corps of Engineers and the Water Management District. They expressed concern about the water issues that have taken place in recent days regarding the releases from Lake Okeechobee that affect the water quality of the estuaries. This has major impacts on the tourism of the coastal communities. Almost a billion dollars have been spent to refurbish the dike and it still can't hold any additional water. He stated that holding a few more inches of water would have a tremendous impact in the estuaries. He added that he does not endorse any risk to property or personal well-being of anyone south of the Lake.

Chair Perry added that he and Vice-Mayor Denham have found a lot of common ground on this issue. There must be changes in the management that can accommodate the well-being of both the inland and coastal communities.

Mr. Mulhere asked if the final decision in releases rests with the Army Corps of Engineers. Vice-Mayor Denham explained that it's a combination of the Corps and the Water Management District. Vice-Mayor Denham believed that they have had a successful legislative session regarding water quality, but those projects are all 5-7 years away. Mr. Mulhere asked if the Congressional



Delegation should have been added. Commissioner Wilkins suggested contacting the President. Vice-Mayor Denham explained that the Delegation and Governor were copied, and they are going to Washington next month. He added that Congressman Rooney has been fantastic. He has also met with sugar farmers and understands their plight.

#### **AGENDA ITEM #11 NEW BUSINESS**

There was no new business brought to the Council.

#### **AGENDA ITEM #12 STATE AGENCIES COMMENTS/REPORTS**

Mr. Agacinski announced that the SIS Implementation Group will conduct a statewide SIS designation webinar on June 27. It will present the revisions to the SIS designation criteria and include recommendations on existing SIS facilities. Commissioner Wilkins explained that because SR 29 through downtown LaBelle is a SIS facility, it limits what the City can do. Mr. Mulhere added that this is also true of Immokalee.

#### **AGENDA ITEM #13 COUNCIL LEGAL CONSULTANT'S COMMENTS**

No comments were made at this time.

#### **AGENDA ITEM #14 COUNCIL MEMBER'S COMMENTS**

Commissioner Doherty asked for clarification on the Relevancy Committee membership. Chair Perry explained that the committee consists of the Executive Committee with a few additional members and invited Commissioner Doherty or anyone else to join.

Mr. Mulhere is frustrated by the continuing difficulty in gaining a quorum every meeting. Today there was a need to rush through the meeting to vote on items and that is not the best way to do business. Vice-Mayor Denham fully supports that sentiment and he wished to have a more detailed discussion of the budget.

Commissioner Strenth explained a key piece in the water quality discussion is to get the communities around Orlando to accept responsibility for their part of the issue. The Lake and the reservoirs can only hold so much.

**AGENDA ITEM #15  
ADJOURNMENT**

The next meeting will be on September 20, 2018. The meeting adjourned at 10:02 a.m.

---

Commissioner Donna Storter-Long, Secretary

The meeting was duly advertised in the June 4, 2018 issue of the **FLORIDA ADMINISTRATIVE REGISTER**, Volume 44, Number 108.

# --- Agenda --- Item

7

Regional Impact

7

7

# **DEVELOPMENT OF REGIONAL IMPACT ASSESSMENT FOR PALMER RANCH INCREMENT XXVIII**

- The applicant, DiVosta Homes for Increment XXVIII is proposing a 500-unit, single family residential development consisting of attached and detached units on a 289.4± acre portion of Palmer Ranch Parcel 6A. The parcel is located west of Honore Avenue, and approximately 0.5± mile south of the intersection of SR 681 and Honore Avenue (see Attachment I).
- The residential development includes an amenity center, lakes and preservation/restoration areas, and a proposed access to the Legacy Trail. The overall density will be 1.73 units per acre with 58.60% of the site preserved as open space (See Attachment II and III, Development Plans).
- The planned single-family residential development is consistent with the Sarasota County Comprehensive Plan and Future Land Use Map, which designates this parcel as Moderate Density Residential.

- The development can be served by existing urban services and facilities including water, sewer, solid waste, police, fire, and health care.
- Residential construction on Parcel 6A is anticipated to commence in 2019 with buildout expected by the end of 2025, subject to market conditions.

## **IMPACT ASSESSMENT FOR INCREMENT XXVIII**

### **Land Use**

- The planned single-family residential development is consistent with the Sarasota County Comprehensive Plan and Future Land Use Map, which designates this parcel as Moderate Density Residential.

## PALMER RANCH INCREMENT MAP

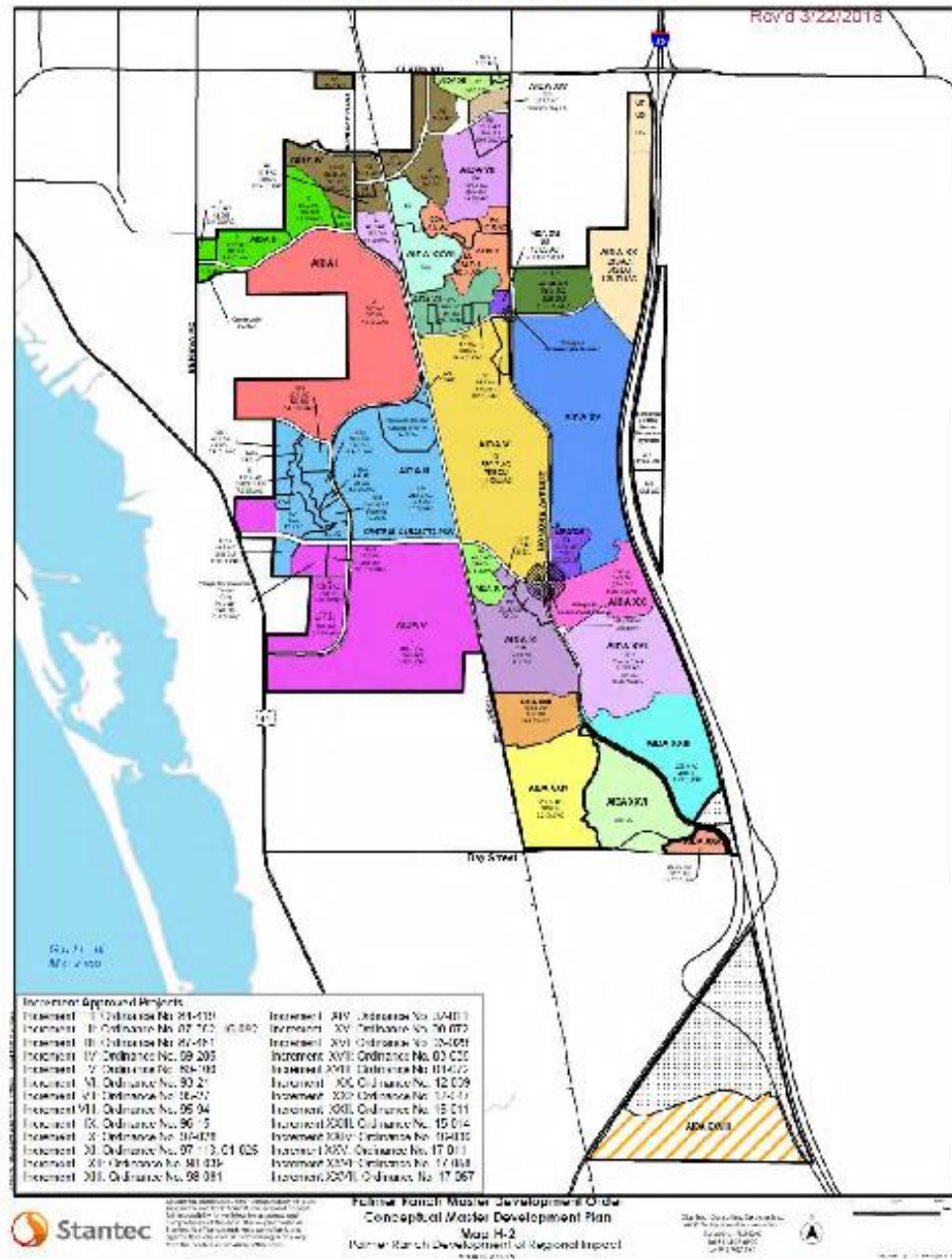

## Received June 21, 2018

17-18417

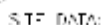

ORDER WORKS	988,517.00 AC
RESIDENTIAL DEVELOPMENT	119,022 AC
LAKES/AUTOMOBIL AREAS/MADE BY	40,671 AC
RECREATION/RECREATION	40,115 AC
WETLAND PROTECTION	27,120 AC

- |                                    |        |
|------------------------------------|--------|
| 1. TOTAL NUMBER OF RESIDENTS, LOTS | 500    |
| 2. OPEN SPACES                     | 60,000 |

**LEGEND:**

POLICE: 904-937-1111  
 FIRE: 904-937-2222  
 AMBULANCE: 904-937-3333  
 CITY OF JACKSONVILLE  
 1000 N. GULF BLVD.  
 JACKSONVILLE, FL 32202

PROJECT: PALMER RANCH 6A      ORI INCREMENT XXVIII  
CLIENT: DIVOS A EDM-S

**Stantec**

APCC Professional Parkway East, Sarasota, FL 34236-3414  
Phone 941-407-6900 • Fax 941-407-6910  
Certification Authorization #000000 • [www.apcc.org](http://www.apcc.org)

The Congressional bill also allows state health departments to sue for health care coverage if a health plan is found to be in violation of the law. The Department of Health and Human Services, in partnership with the Department of Justice, is currently reviewing the bill and will be submitting a response to Congress by the end of the year.

## MASTER DEVELOPMENT PLAN

DATE	1 <sup>st</sup> = 1000	DATE	03/2018
TIME	10:00	TIME	10:00
LOCATION	215514268	LOCATION	215514268
WIND	10:00	WIND	10:00

[illegible]

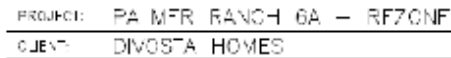
Received PDS August 29, 2018  
RZ 18-07

©2003 Pearson Education, Inc. Publishing as Pearson Education, Inc. 0-02-030546-4  
 Please Visit [www.pearsoned.com](http://www.pearsoned.com) or call 1-800-822-0600  
 Copyright of author(s) in the U.S.A. • [www.pearsoned.com](http://www.pearsoned.com)

The German shrew, with its long snout, is the only shrew in the world with a bill. The shrews are small mammals of the order Eulipotyphla. The shrews are found in all parts of the world, except in the Arctic and Antarctic regions. The shrews are small mammals of the order Eulipotyphla. The shrews are found in all parts of the world, except in the Arctic and Antarctic regions.

ENDING DEVELOPMENT CONCEPT PLAN			
NO. 1	1000	03/2018	
13.18	389	18E,10E	
PROJECT NO.		15514200	
DATE DRAFTED		1/2018	
DRAWN BY		1/2018	
CHECKED BY		1/2018	
APPROVED BY		1/2018	



## **Native Habitat Protection/Vegetation and Wildlife**

- Parcel 6A is currently undeveloped and has been used for the agricultural purpose of grazing cattle (see Attachment IV Aerial and Attachment V Native Habitat Preservation Alteration & Mitigation Plan).
- The project design includes 57.13 acres of wetland preservation and 62.15 acres of buffers/other open space some of which is to protect a bald eagle nest that will be designated as a conservation area.
- No impacts to Sarasota County-regulated upland habitats will occur from development of the project.
- Native habitats to be preserved will include preserved and mitigation wetlands and their associated upland buffers and upland areas which support Grand Trees. These areas are reflected on Map F-2 (Attachment V).

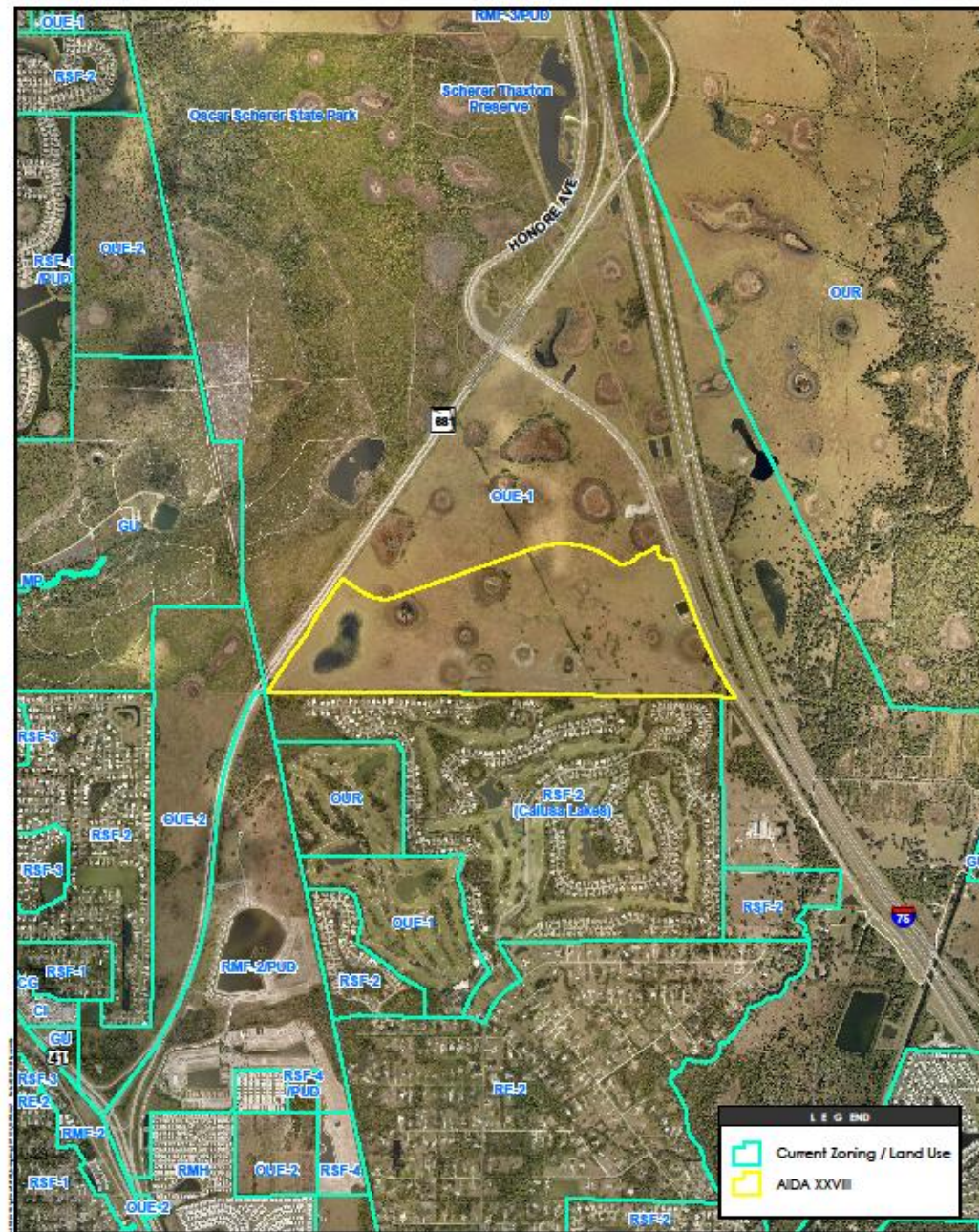

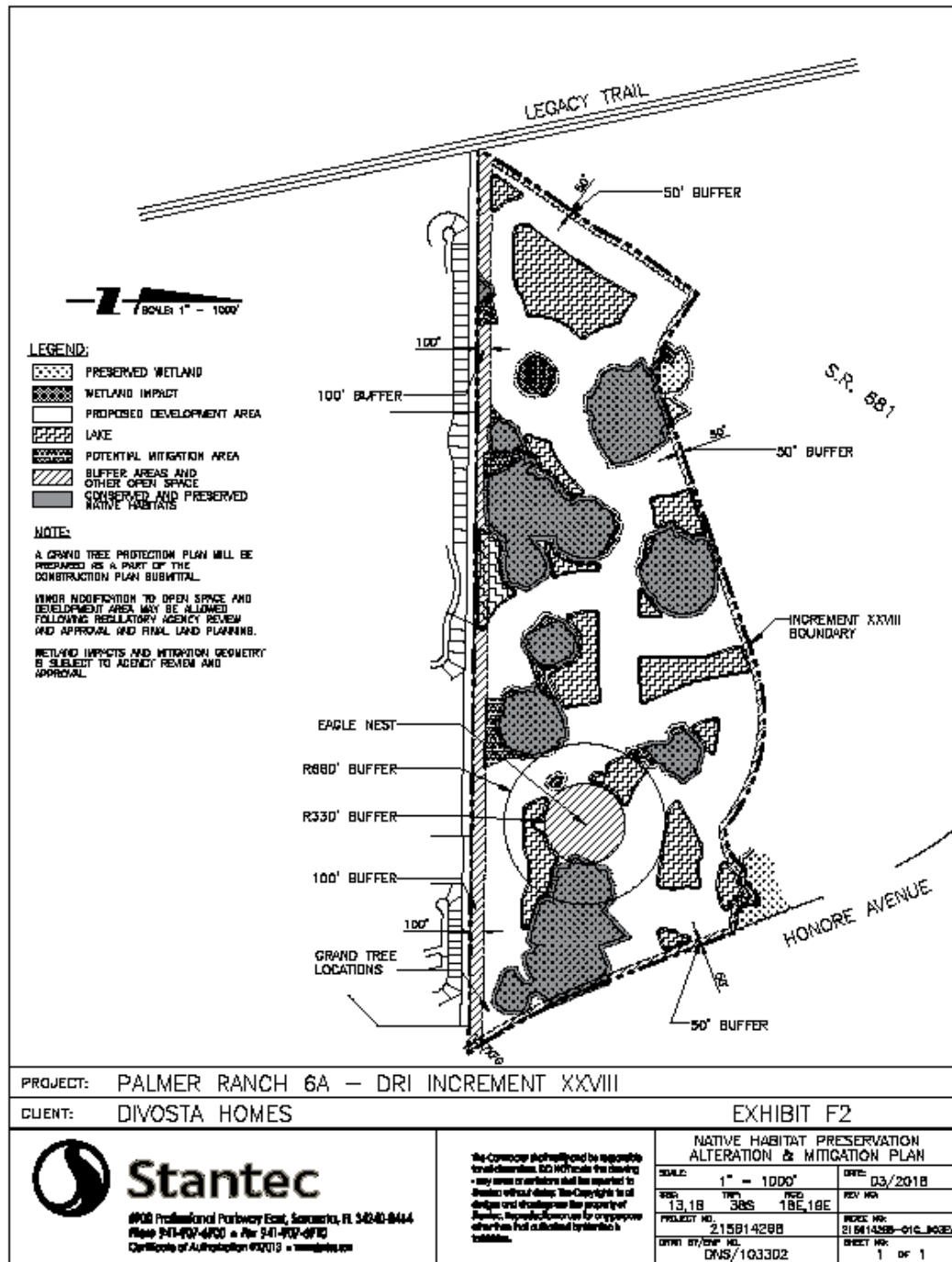

- No listed plant species or significant plant community is present within the project site.
- It is anticipated that wetland-dependent species, such as listed wading birds and American alligators, will benefit from habitat enhancement and management to occur in post-development wetlands.
- A permit from FFWCC will be obtained for the relocation of any gopher tortoise in burrows which cannot be avoided. It is anticipated that the gopher tortoise and commensals will be relocated to an off-site recipient area in accordance with FFWCC permitting criteria.
- Sherman's fox squirrels have been documented on the project site. All development activities will follow the FFWCC Conservation Measures and Permitting Guidelines applicable to the species.

- This increment lies within both the Little Sarasota Bay and Dona Bay Watersheds.
- The Surface Water Management Plan proposes to provide treatment, attenuation and floodplain compensation from the developable portions of Parcel 6A using multiple stormwater lakes located at strategic locations.
- The proposed stormwater system is required to provide treatment for the first one inch of rainfall for the development area. Although SWFWMD no longer requires littoral zones in stormwater lakes, Sarasota County still requires littoral zones of 30% of the minimum lake area required for treatment.
- It is the intent of the proposed stormwater management system to maintain existing drainage patterns of the two watersheds and to not have adverse offsite impacts downstream of the site.

- The impacts of Parcel 6A were accounted for in the Palmer Ranch 2015 Transportation Re-Analysis, approved in July 2016. Similar to previous Transportation Reanalysis, the 2015 Transportation Re-Analysis demonstrates that the roads included in the Master Development Order provide a benefit greater than the impact of the approved Palmer Ranch land uses at buildout.
- The development proposes two full access points: one to Honore Avenue and one to SR 681. The proposed access point to SR 681 is consistent with “Full Median Opening #2” shown in the adopted FDOT/Sarasota County’s SR 681 Access Management Plan (AMP).
- Because the 2015 Transportation Re-Analysis accounted for 1,752 single-family detached units, 100,000 square feet of office, and 150,000 square feet of retail, and it demonstrated that the construction of roadways through the DRI will outweigh the transportation impacts of the Palmer Ranch DRI, no off-site transportation improvements are required as part of this project.



- This development can be served by existing urban services and facilities including water, sewer, solid waste, police, fire, and health care required to be addressed under this Increment.
- Development is required to connect to Sarasota County Public Utilities water, wastewater and reclaimed water systems in accordance with current County rules and regulations.
- The development is responsible for providing all on-site and off-site infrastructure that will be needed to serve the project.

## **RECOMMENDED INCREMENT XXVIII DEVELOPMENT ORDER CONDITONS**

### **A. GENERAL**

1. The Palmer Ranch Increment XXVIII development shall occur in substantial accordance with the Palmer Ranch Master Development Order and Incremental Development Order Conditions.

2. All references made in the following Conditions for Development Approval pertaining to “Applicant”, shall also include any successors in interest of areas covered under this Development Order.
3. Access to the Palmer Ranch Increment XXVIII project site by Sarasota County government agents and employees shall be granted for the purpose of monitoring the implementation of the Development Order.
4. Pursuant to Chapter 380.06(5), Florida Statutes, the Applicant may be subject to credit for contributions, construction, expansion, or acquisition of public facilities, if the Applicant is also subject by local ordinances to impact fees or exactions to meet the same needs. The local government and the Applicant may enter into a capital contribution front-ending agreement to reimburse the Applicant for voluntary contributions in excess of the fair share.



## **B. LAND USE**

1. All development shall occur in substantial accordance with the Master Development Plan date stamped June 21, 2018, and attached hereto as Exhibit B (Attachment II). This does not imply or confer any deviations from applicable zoning or land development regulations.

## **C. NATIVE HABITAT PROTECTION/VEGETATION AND WILDLIFE**

1. The wetlands and associated upland vegetative buffers shall be maintained in accordance with management guidelines contained within the Comprehensive Plan as a preserve and labeled a preserve on all plans as shown on Map F-2 Exhibit C (Attachment V). All activities including but not limited to filling, excavating, well drilling, altering vegetation (including trimming of both trees and understory) and storing of materials shall be prohibited within preservation areas, unless written approval is first obtained from Environmental Permitting. Exception may be granted by Environmental Permitting to facilitate implementation of approved habitat management plans or the hand removal of nuisance/invasive vegetation.

2. A resource management plan that maintains the functions and values of the on-site preservation areas and is consistent with the Guiding Principles of the Comprehensive Plan and the Environmental Technical Manual shall be submitted to Environmental Protection Division with preliminary or site and development plans.

#### **D. WATER QUALITY AND DRAINAGE**

1. The Master Surface Water Management Plan shall be consistent with the South Creek (Little Sarasota Bay Watershed) and Cowpen Slough (Dona Bay Watershed) Basin Master Plans.

**RECOMMENDED ACTION:** The staff of the Southwest Florida Regional Planning Council recommends Conditional Approval for the Palmer Ranch Increment XXVIII DRI to be further conditioned on a finding of Consistency with the Local Government Comprehensive Plan by the Sarasota County Board of County Commissioners.

# --- Agenda --- Item

7a

Palmer Ranch Increment 28  
Staff Assessment

7a

7a

# **DEVELOPMENT OF REGIONAL IMPACT ASSESSMENT FOR PALMER RANCH INCREMENT XXVIII**

## **BACKGROUND**

The Palmer Ranch Master Development of Regional Impact (DRI) is an approved 7,002-acre master planned development generally located west of I-75, south of Clark Road, east of US 41, and north of Bay Street in Sarasota County. Sarasota County originally approved the Palmer Ranch DRI on December 18, 1984 (Resolution No. 84-418) and amended and restated the DRI under Resolution No. 91-170, and again under Ordinance No. 2015-010. The Palmer Ranch DRI is approved for 1,450,000 square feet of commercial/office uses, 550,000 square feet of industrial uses (Palmer Park of Commerce), and 14,200 residential units. The Application for Master Development Order (AMDO) review process requires that Applications for Incremental Development Approval (AIDA) be submitted to approve specific land uses. To date 643,178 square feet of commercial, 164,002 square feet of industrial, and 13,528 residential dwelling units have been approved for construction in 27 Increments (see Attachment I).

The applicant, DiVosta Homes for Increment XXVIII is proposing a 500-unit, single family residential development consisting of attached and detached units on a 289.4± acre portion of Palmer Ranch Parcel 6A. The parcel is located west of Honore Avenue, and approximately 0.5± mile south of the intersection of SR 681 and Honore Avenue (see Attachment I). Primary access to the development is from Honore Avenue, with a second access from SR 681. The residential development includes an amenity center, lakes and preservation/restoration areas, and a proposed access to the Legacy Trail. The overall density will be 1.73 units per acre with 58.6% of the site preserved as open space (See Attachment II and III, Development Plans).

Parcel 6A is currently undeveloped and has been used for the agricultural purpose of grazing cattle (see Attachment IV Aerial and Attachment V Native Habitat Preservation Alteration & Mitigation Plan). The planned single-family residential development is consistent with the Sarasota County Comprehensive Plan and Future Land Use Map, which designates this parcel as Moderate Density Residential. The development can be served by existing urban services and facilities including water, sewer, solid waste, police, fire, and health care. Residential construction is anticipated to commence in 2019 with buildout expected by the end of 2025, subject to market conditions.

## **IMPACT ASSESSMENT**

The Council staff usually provides a detailed assessment of all the regional and local issues within Appendix I and II of a DRI Assessment Report. However, because Sarasota County has received Limited DRI Certification under 380.065 F.S., Administrative Rule 28-10 and a "Memorandum of Understanding Regarding Sarasota County's Limited DRI Certification Program" between the Sarasota County and the SWFRPC signed on April 4, 1989, the Sarasota County staff assessment is approved by SWFRPC staff as the recommended SWFRPC Staff Assessment. No additional analysis and recommendations are being added to the regional issues by SWFRPC.

The regional recommendations below for the "Palmer Ranch Increment XXVIII DRI Assessment" have been prepared by Sarasota County Planning staff and the Southwest Florida Regional Planning Council staff as required by Chapter 380.06, Florida Statutes. A determination by Sarasota County and the applicant has been made not to reiterate word for word the applicable MDO conditions that applied to Increment XXVIII but to reference within the Increment XXVIII development order the applicable MDO conditions. The DRI assessment is largely based on

information supplied in the AIDA and the Sarasota County Staff Assessment. Additional information was obtained by consulting official plans, and by reviewing reports related to specific issues in the impact assessment. Sarasota County's staff assessment and recommendations were integrated into various elements of the regional recommendations. The Southwest Florida Water Management District reviewed Water-related elements with no specific recommendations for the DO. A Florida Department of Transportation final review letter was provided to the applicant to coordinate a full access onto State Road 681, encourages the use of multimodal transportation alternatives. Also, because the site encompassing Parcel 6A is near the Legacy Trail (Sarasota to Venice Rail Trail), FOOT encourages the applicant to coordinate with Sarasota County and FOOT to ensure sufficient multimodal facilities are in place to provide safe access to the regional trail system. These recommendations have been addressed in the Incremental Application.

Regarding consistency with the Regional Policy Plan Council staff has reviewed the Increment relative to the regional plan DRI review list and normally the plan consistency checklist is provided in this section. However, since the Regional Policy Plan checklist for the SWFRPC adopted Palmer Ranch Increment XXIII Assessment Report would be the same, in an effort to reduce paper work, refer to the Increment XXIII Assessment Report. Staff finds that without appropriate mitigation actions and conditions the project could have a net negative impact on the regional resources and infrastructure. The regional recommendations presented within this assessment are intended to neutralize the negative and questionable impacts.

The Council's staff assessment for Increment XXVIII only contains regional issues. The recommendations for these issues are formal conditions to be included by the local government in any Development Order that has jurisdiction within a particular county.

The findings of this evaluation and the Southwest Florida Regional Planning Council's recommendations are not intended to foreclose or abridge the legal responsibility of local government to act pursuant to applicable local laws and ordinances. Copies of any "Incremental Development Order" (an order granting, denying, or granting with conditions an Application of Development Approval) issued with regard to the proposed development should be transmitted to the Southwest Florida Regional Planning Council and the Florida Department of Economic Opportunity.

### **Application for Incremental Development Approval**

Increment XXVIII proposal is a 500-unit, single family residential development consisting of attached and detached units on a 289.4± acre portion of Palmer Ranch Parcel 6A. The parcel is located west of Honore Avenue, and approximately 0.5± mile south of the intersection of SR 681 and Honore Avenue (see Attachment I). Primary access to the development is from Honore Avenue, with a second access from SR 681. The residential development includes an amenity center, lakes and preservation/restoration areas, and a proposed access to the Legacy Trail. The overall density will be 1.73 units per acre with 58.60% of the site preserved as open space. (See Attachment II and III, Development Plans).

### **Land Use**

The planned single-family residential development is consistent with the Sarasota County Comprehensive Plan and Future Land Use Map, which designates this parcel as Moderate Density Residential (between 2 and less than 5 dwelling units per acre). Future Land Use Policy 1.2.14 permits Medium and High Density Residential development "... within Developments of Regional Impact, where such residential development may be approved as part of a Planned District (PD), and where such residential development may be approved as part of a Planned Unit Development (PUD), in

accordance with the Sarasota County Zoning Regulations.” As such, the requested RSF-1/PUD zone district is consistent with the Comprehensive Plan. The subject parcel is centrally located within the County, with public infrastructure and access to services, is compatible with surrounding development, and adequate levels of service have been demonstrated.

### **Native Habitat Protection/Vegetation and Wildlife**

A principle of the environmental design and permitting of the Palmer Ranch DRI has been the creation of environmental/habitat corridors throughout the project to aggregate and maximize ecological functions and habitat values of preserved natural systems. Parcel 6A is characterized by mixed rangeland and improved pasture on which cattle are grazed and contains a number of freshwater marshes and wet prairies. A borrow pit excavated for the construction of State Road 681 exists on the western end of the parcel. A stormwater pond and wetland mitigation areas created to serve the extension of Honore Avenue exist within a portion of Parcel 6A. A power line corridor traverses the southeastern corner of the parcel.

The project design includes 57.13 acres of wetland preservation and 62.15 acres of buffers/other open space. The project proposes impacts to portions of ten (10) wetlands and the other surface water / borrow pit. It is anticipated the wetland mitigation will be comprised of a combination of wetland creation and enhancement of preserved wetlands with reduced habitat values. The final acreage and configuration of each alteration area will be refined during detailed project design and regulatory agency review and approval during the local, state, and federal wetland permitting processes. According to county staff, the applicant proposes to preserve most of on-site wetlands within Parcel A6. Wetland impacts within Parcel A6 are due to required entrance access to the property and site geometry constraints. All areas proposed from impact are currently poor-quality wetland areas.

No impacts to Sarasota County-regulated upland habitats will occur from development of the project. Native habitats to be preserved will include preserved and mitigation wetlands and their associated upland buffers and upland areas which support Grand Trees. Upland areas set aside to buffer and protect a bald eagle nest will be designated as a conservation area. These areas are reflected on Map F-2 (Attachment V). A Resource Management Plan (RMP) for Palmer Ranch Increment XXVIII was prepared to address the long-term protection of native habitats consistent with Sarasota County requirements outlined in Section D of the Environmental Technical Manual and consistent with previous plans prepared for earlier increments on Palmer Ranch.

No listed plant species or significant plant community is present within the project site. It is anticipated that wetland-dependent species, such as listed wading birds and American alligators, will benefit from habitat enhancement and management to occur in post-development wetlands. A permit from FFWCC will be obtained for the relocation of any gopher tortoise in burrows which cannot be avoided. It is anticipated that the gopher tortoise and commensals will be relocated to an off-site recipient area in accordance with FFWCC permitting criteria. Sherman’s fox squirrels have been documented on the project site. All development activities will follow the FFWCC Conservation Measures and Permitting Guidelines applicable to the species. Prior to any land clearing activities, nest surveys will be conducted to identify all active nest trees. Any active nesting tree will be preserved according to the guidelines.

### **Water Quality and Stormwater**

This increment lies within both the Little Sarasota Bay and Dona Bay Watersheds. The Surface Water Management Plan proposes to provide treatment, attenuation and floodplain compensation from the developable portions of Parcel 6A using multiple stormwater lakes located at strategic

locations. The proposed stormwater system is required to provide treatment for the first one inch of rainfall for the development area. Although SWFWMD no longer requires littoral zones in stormwater lakes, Sarasota County still requires littoral zones of 30% of the minimum lake area required for treatment. The littoral zones can be provided along the perimeter of the proposed stormwater systems. It is the intent of the proposed stormwater management system to maintain existing drainage patterns of the two watersheds and to not have adverse offsite impacts downstream of the site.

### **Transportation**

Transportation impacts on Palmer Ranch are analyzed on a Ranch-wide basis every five-year consistent with the MDO and 2015 Transportation Reanalysis reflecting the current transportation reanalysis. The purpose of this study is to assess system-wide impacts created by the Palmer Ranch Development and to establish the timing of the construction of certain County thoroughfares identified in the MDO through Palmer Ranch. The impacts of Parcel 6A were accounted for in the Palmer Ranch 2015 Transportation Re-Analysis, approved in July 2016. The development intensity assumed in the Palmer Ranch 2015 Transportation Re-Analysis for the entire South 660 was 1,752 single-family detached units, 100,000 square feet of office, and 150,000 square feet of retail. The 500 single-family detached units are within and significantly less than the development intensity approved.

Sarasota County requires two driveway connections at the time development constructs more than 100 dwelling units. The development proposes two full access points: one to Honore Avenue and one to SR 681. The proposed access point to SR 681 is consistent with “Full Median Opening #2” shown in the adopted FDOT/Sarasota County’s SR 681 Access Management Plan (AMP). The access point to Honore Avenue is approximately 500 feet north of an existing median opening. Since the existing driveway connection to Honore Avenue is in proximity to the existing median opening, the existing median opening will need to be closed. Once the existing median opening on Honore Avenue is closed, the new median opening associated with the project will meet Sarasota County’s Access Management Standards.

Similar to previous Transportation Reanalysis, the 2015 Transportation Re-Analysis demonstrates that the roads included in the Master Development Order provide a benefit greater than the impact of the approved Palmer Ranch land uses at buildout. Because the 2015 Transportation Re-Analysis accounted for 1,752 single-family detached units, 100,000 square feet of office, and 150,000 square feet of retail, and it demonstrated that the construction of roadways through the DRI will outweigh the transportation impacts of the Palmer Ranch DRI, no off-site transportation improvements are required as part of this project.

### **Urban Services**

This development can be served by existing urban services and facilities including water, sewer, solid waste, police, fire, and health care required to be addressed under this Increment. Specific provisions for service are approved under their respective sections of the AIDA and subsequent permitting, as required. Development is required to connect to Sarasota County Public Utilities water, wastewater and reclaimed water systems in accordance with current County rules and regulations. The development is responsible for providing all on-site and off-site infrastructure that will be needed to serve the project.

## **Recommended Increment XXVIII Development Order Conditions**

### **A. GENERAL**

1. The Palmer Ranch Increment XXVIII development shall occur in substantial accordance with the Palmer Ranch Master Development Order and Incremental Development Order Conditions.
2. All references made in the following Conditions for Development Approval pertaining to “Applicant”, shall also include any successors in interest of areas covered under this Development Order.
3. Access to the Palmer Ranch Increment XXVIII project site by Sarasota County government agents and employees shall be granted for the purpose of monitoring the implementation of the Development Order.
4. Pursuant to Chapter 380.06(5), Florida Statutes, the Applicant may be subject to credit for contributions, construction, expansion, or acquisition of public facilities, if the Applicant is also subject by local ordinances to impact fees or exactions to meet the same needs. The local government and the Applicant may enter into a capital contribution front-ending agreement to reimburse the Applicant for voluntary contributions in excess of the fair share.

### **B. LAND USE**

1. All development shall occur in substantial accordance with the Master Development Plan date stamped June 21, 2018 and attached hereto as Exhibit B (Attachment II). This does not imply or confer any deviations from applicable zoning or land development regulations.

### **C. NATIVE HABITAT PROTECTION/VEGETATION AND WILDLIFE**

1. The wetlands and associated upland vegetative buffers shall be maintained in accordance with management guidelines contained within the Comprehensive Plan as a preserve and labeled a preserve on all plans as shown on Map F-2, attached hereto as Exhibit “C” (Attachment V). All activities including but not limited to filling, excavating, well drilling, altering vegetation (including trimming of both trees and understory) and storing of materials shall be prohibited within preservation areas, unless written approval is first obtained from Environmental Permitting. Exception may be granted by Environmental Permitting to facilitate implementation of approved habitat management plans or the hand removal of nuisance/invasive vegetation.
2. A resource management plan that maintains the functions and values of the on-site preservation areas and is consistent with the Guiding Principles of the Comprehensive Plan and the Environmental Technical Manual shall be submitted to Environmental Protection Division with preliminary or site and development plans.

### **D. WATER QUALITY AND DRAINAGE**

1. The Master Surface Water Management Plan shall be consistent with the South Creek (Little Sarasota Bay Watershed) and Cowpen Slough (Dona Bay Watershed) Basin Master Plans.



**RECOMMENDED ACTION:** The staff of the Southwest Florida Regional Planning Council recommends Conditional Approval for the Palmer Ranch Increment XXVIII DRI to be further conditioned on a finding of Consistency with the Local Government Comprehensive Plan by the Sarasota County Board of County Commissioners.

9/20/2018

## PALMER RANCH INCREMENT MAP

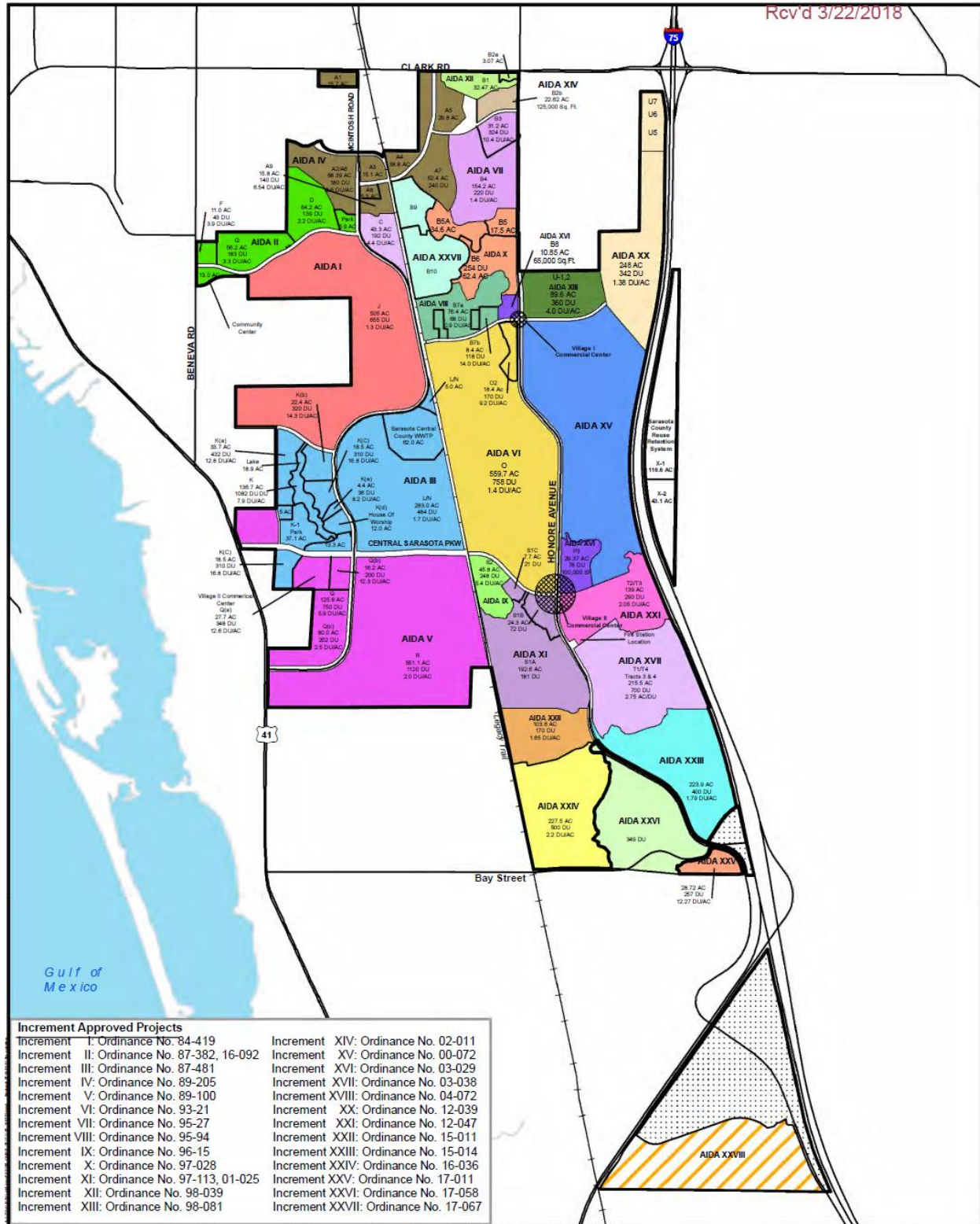

# **PALMER RANCH INCREMENT XXVIII** **Proposed Master Development Plan**

Received June 21, 2018

RZ 18-07

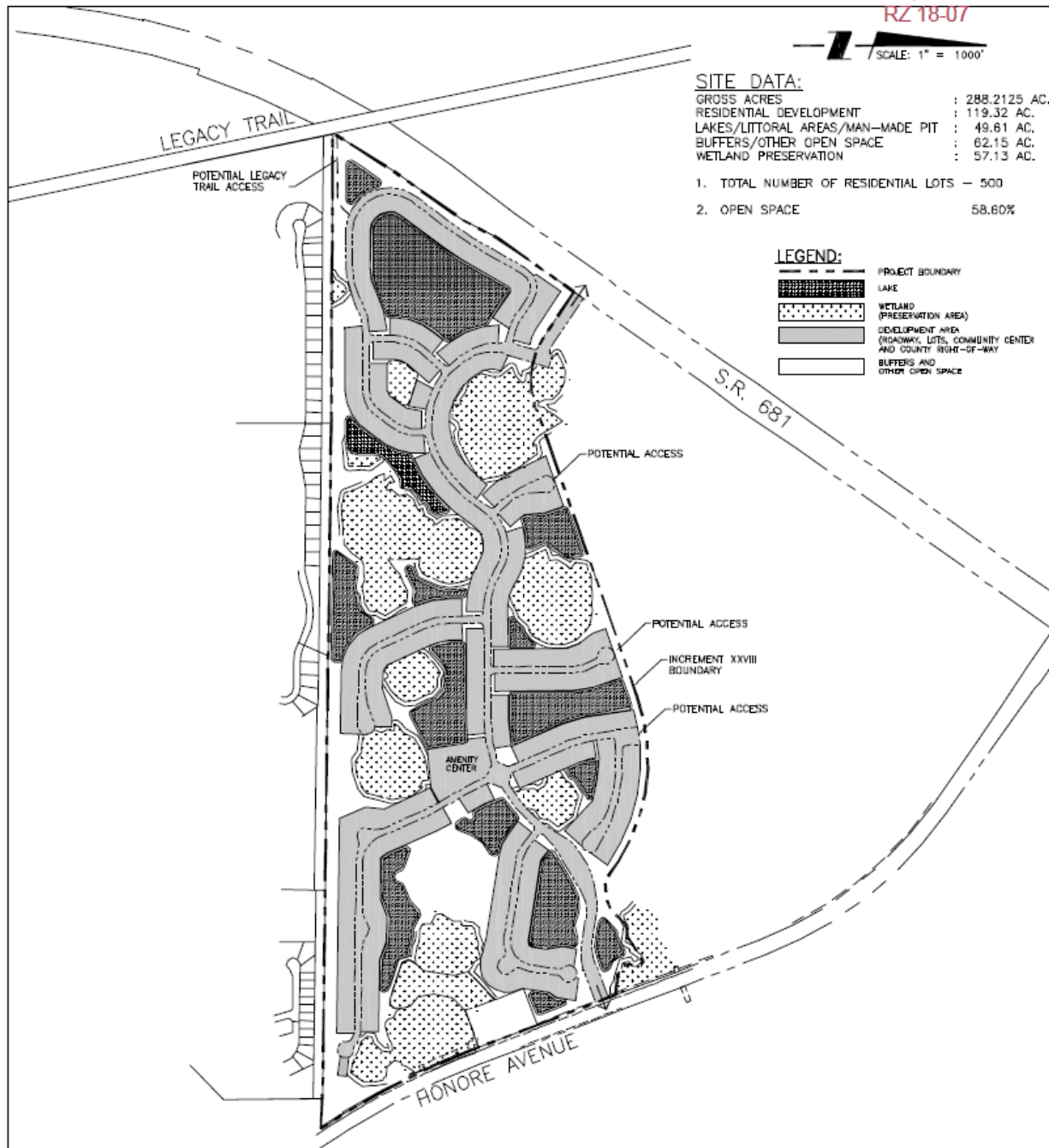

PROJECT: PALMER RANCH 6A — DRI INCREMENT XXVIII

CLIENT: DIVOSTA HOMES

**Stantec**

6900 Professional Parkway East, Sarasota, FL 34240-8414  
 Phone 941-907-6900 • Fax 941-907-6910  
 Certificate of Authorization #27013 • www.stantec.com

The Contractor shall verify and be responsible for all dimensions. DO NOT scale the drawing - any errors or omissions shall be reported to Stantec without delay. The Copyright to all designs and drawings are the property of Stantec. Reproduction or use for any purpose other than that authorized by Stantec is forbidden.

## **MASTER DEVELOPMENT PLAN**

SCALE: 1" = 1000'	DATE: 03/2018
SEG: 13,18	REV NO:
TWP: 38S	RGE: 18E,19E
PROJECT NO: 215614268	INDEX NO: 215614268-01C_902EX
DRWN BY/BAP NO: DNS/103302	SHEET NO: C-3

Saved: 6/15/2018 10:18:28 AM DSEFKE | Plotted: 6/18/2018 10:22:50 AM DSEFKE | V:\2156\active\215614268\planning\drawing\01\_Zoning\215614268-01C\_902EX.dwg\Layout1

## Binding Development Concept Plan

Received PDS August 29, 2018

RZ 18-07

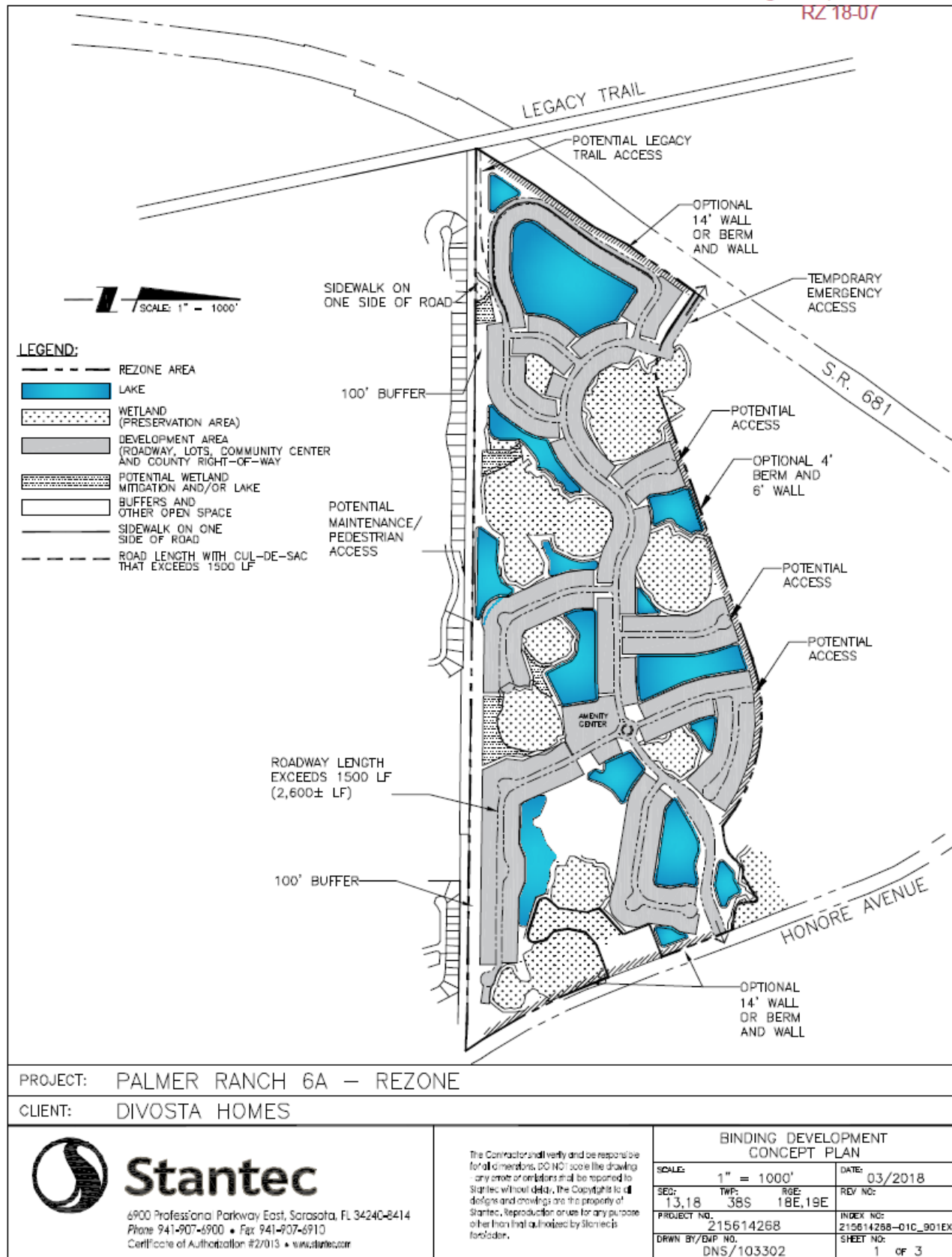



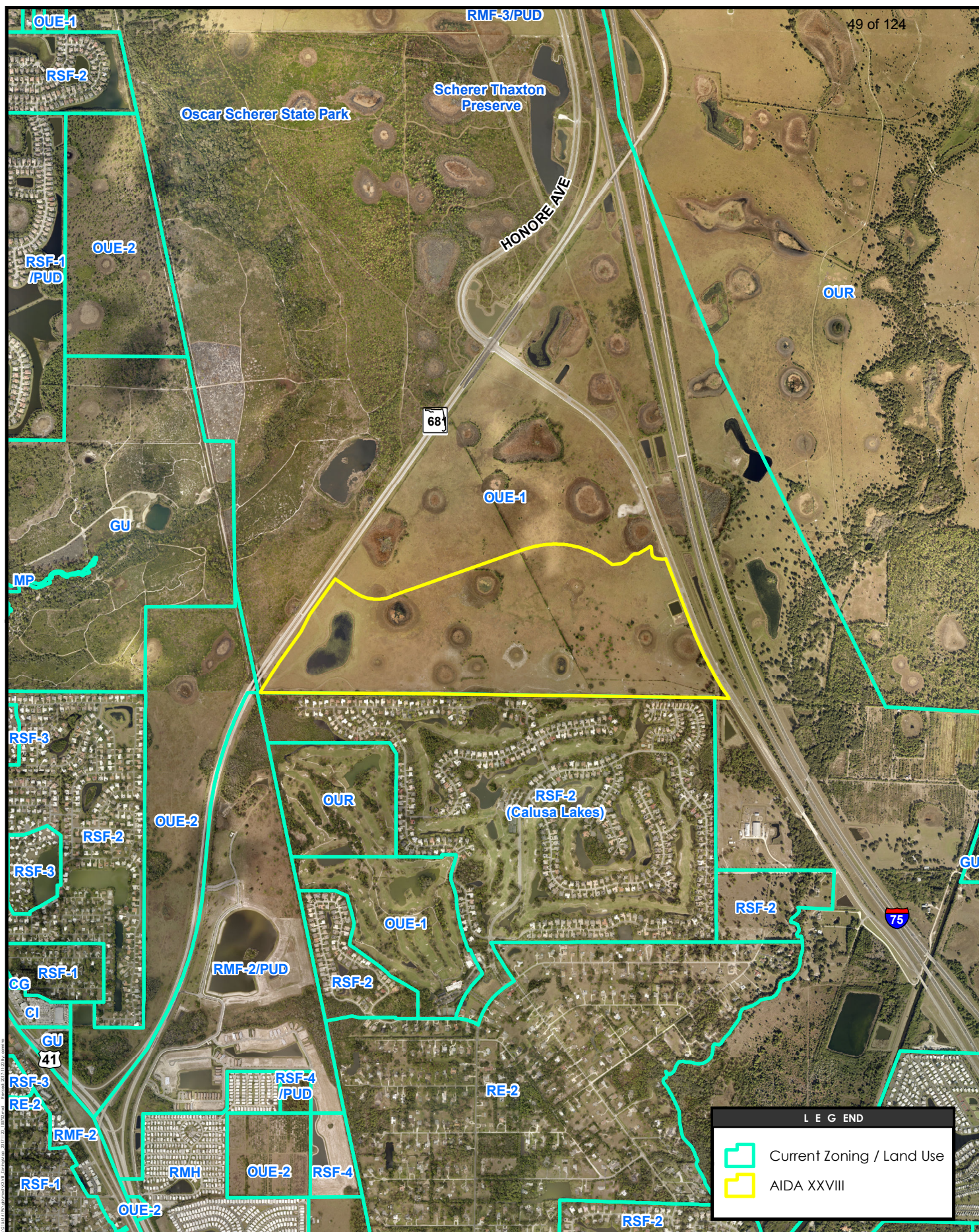



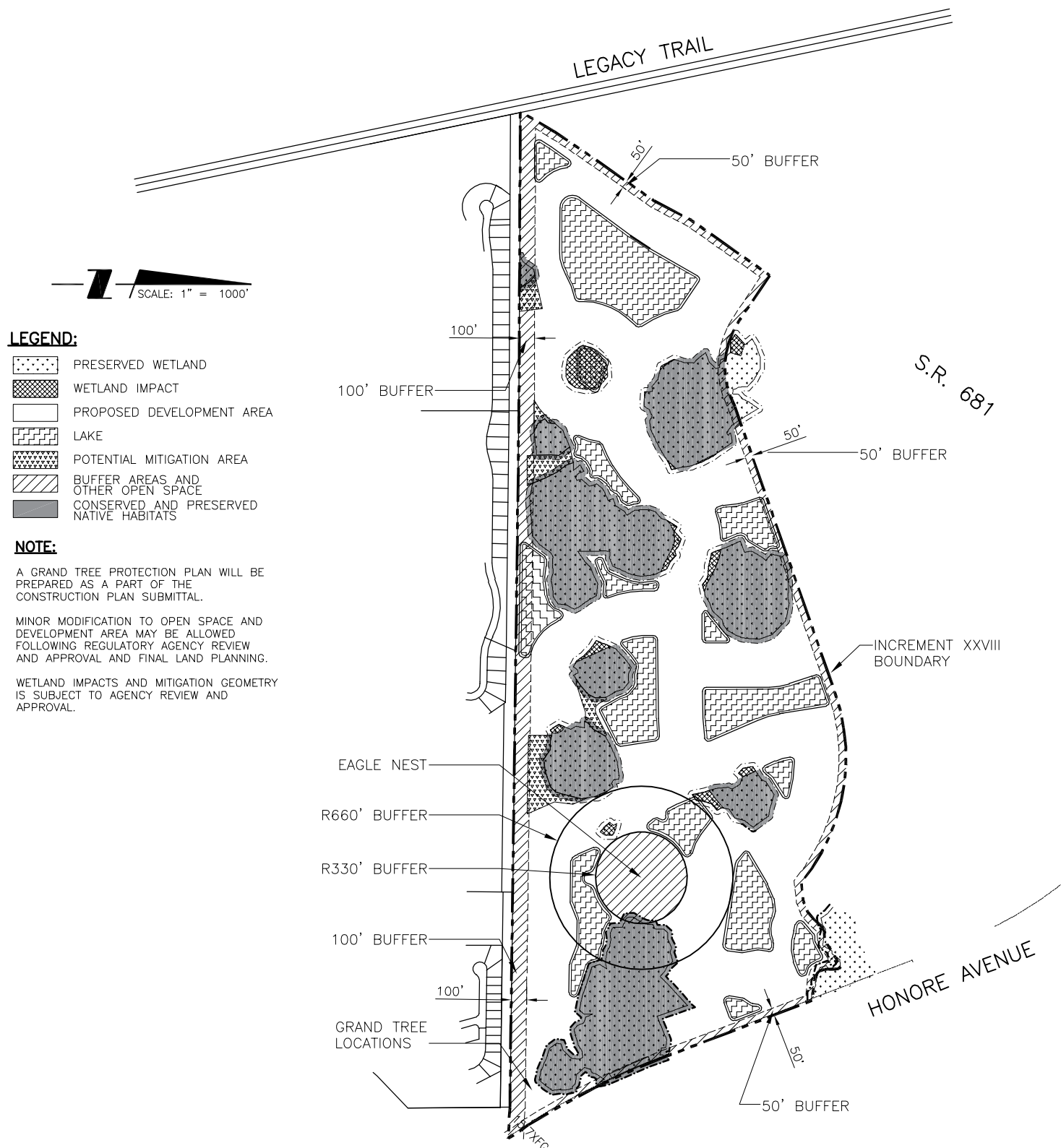

PROJECT: PALMER RANCH 6A — DRI INCREMENT XXVIII

CLIENT: DIVOSTA HOMES

EXHIBIT F2

**Stantec**

6900 Professional Parkway East, Sarasota, FL 34240-8414  
 Phone 941-907-6900 • Fax 941-907-6910  
 Certificate of Authorization #27013 • www.stantec.com

The Contractor shall verify and be responsible for all dimensions. DO NOT scale the drawing - any errors or omissions shall be reported to Stantec without delay. The Copyrights to all designs and drawings are the property of Stantec. Reproduction or use for any purpose other than that authorized by Stantec is forbidden.

**NATIVE HABITAT PRESERVATION  
 ALTERATION & MITIGATION PLAN**

SCALE:	1" = 1000'	DATE:	03/2018
SEC:	TWP: RGE:	REV NO:	
13,18	38S 18E,19E		
PROJECT NO:	INDEX NO:		
215614268	215614268-01C_903EX		
DRWN BY/EMP NO:	SHEET NO:		
DNS/103302	1 OF 1		

# Agenda Item

8

Consent Agenda

8

8

## Consent Agenda Summary

### **Agenda Item #8 (a) - Intergovernmental Coordination and Review**

The attached report summarizes the project notifications received from various governmental and non-governmental agencies seeking federal assistance or permits for the period beginning June 1, 2018 and ending August 31, 2018.

**RECOMMENDED ACTION:** Approval of the administrative action on Clearinghouse Review items

### **Agenda Item #8(b) – CEDS Annual Update**

The CEDS (Comprehensive Economic Development Strategy) Annual Update is meant to provide EDA with an update on any changes to the CEDS document. The report also provides an overview of economic development highlights in the region and provides statistics on regional performance measures.

**RECOMMENDED ACTION:** Approve the CEDS Annual Update for submittal to EDA



# --- Agenda --- Item

8a

Intergovernmental Coordination  
and Review

8a

8a

## Project Review and Coordination Regional Clearinghouse Review

The attached report summarizes the project notifications received from various governmental and non-governmental agencies seeking federal assistance or permits for the period beginning June 1, 2018 and ending August 31, 2018.

The staff of the Southwest Florida Regional Planning Council reviews various proposals, Notifications of Intent, Preapplications, permit applications, and Environmental Impact Statements for compliance with regional goals, objectives, and policies of the Regional Comprehensive Policy Plan. The staff reviews such items in accordance with the Florida Intergovernmental Coordination and Review Process (Chapter 29I-5, F.A.C.) and adopted regional clearinghouse procedures.

Council staff reviews projects under the following four designations:

Less Than Regionally Significant and Consistent - no further review of the project can be expected from Council.

Less Than Regionally Significant and Inconsistent - Council does not find the project to be of regional importance but notes certain concerns as part of its continued monitoring for cumulative impacts within the noted goal areas.

Regionally Significant and Consistent - Project is of regional importance and appears to be consistent with Regional goals, objectives and policies.

Regionally Significant and Inconsistent - Project is of regional importance and appears not to be consistent with Regional goals, objectives, and policies. Council will oppose the project as submitted but is willing to participate in any efforts to modify the project to mitigate the concerns.

The report includes the SWFRPC number, the applicant name, project description, location, funding or permitting agency, and the amount of federal funding, when applicable. It also includes the comments provided by staff to the applicant and to the FDEP-State Clearinghouse in Tallahassee.

**RECOMMENDED ACTION:** Approval of the administrative action on Clearinghouse Review items.

8/2018

## ICR Council 2018

SWFRPC #	Name 1	Name 2	Location	Project Description	Funding Agent	Council Com
2018-07	Julie Dennis	DEO	Collier County	Community Disaster Recovery Program: Housing Repair or Replacement for Collier County	DEO-CDBG	Regionally Significant
2018-08	Julie Dennis	DEO	Lee County	Community Disaster Recovery Program: Housing Repair or Replacement for Lee County	DEO-CDBG	Regionally Significant
2018-09	Maxine Brantley	City of Moore Haven	City of Moore Haven	City of Moore Haven - Water System Improvement Program, Phase 2 Project: Expansion of the existing WTP to increase treatment capacity, water quality, equipment redundancy and system pressure	USDA	Regionally Significant

# --- Agenda --- Item

8b

CEDS Annual Update

8b

8b

# CEDS 2018 Annual Report

## Southwest Florida Comprehensive Economic Development Strategy

2017-2022



Southwest Florida Regional Planning Council



# Southwest Florida Comprehensive Economic Development Strategy

2017-2022

2018 Annual Report

Grant Period: January 1, 2017 through December 31, 2019

This document was prepared under a financial assistance award (ED17ATL3020004) from the U.S. Economic Development Administration

United States Department of Commerce  
Economic Development Administration  
Atlanta Regional Office Suite 1820  
401 W. Peachtree, St, NW Atlanta, GA 30308-3510

Southwest Florida Regional Planning Council  
1400 Colonial Blvd, Suite 1  
Fort Myers, Florida 33907  
(239) 938-1813

## Highlights Within Our Region

### Charlotte County

#### **FL Governor announces major grant to boost infrastructure and job growth in Charlotte County**

Gov. Rick Scott announced on May 30 that Charlotte County will receive an \$800,000 grant as part of the Florida Job Growth Fund. The Job Growth Fund provides financial assistance for public infrastructure projects and job training. Grant recipients are selected by the governor following recommendations from the Florida Department of Economic Opportunity and Enterprise Florida, a public-private partnership created to spur economic development in the state.

In Charlotte County, grant funds will provide critical water line infrastructure to help complete the \$8 million Piper Road North Extension project designed to drive growth near Punta Gorda Interstate Airport Park. A closed loop water line will run 1.2 miles from Henry Street to U.S. 17 to facilitate commercial development on Piper Road North. Infrastructure includes 7,000 feet of 12-inch water main with fire hydrant assemblies every 1,000 feet.

With water infrastructure in place, attracting companies to the area will become significantly easier. That will help generate new jobs within the community.

#### **Babcock Ranch Houses Its First Residents**

The solar powered city of Babcock Ranch has been on the radar for a while now for their attempt to create a cutting-edge, self-sustaining community. The area features several organic-based restaurants and shops that utilize locally grown produce and food, reinforcing its green lifestyle and culture. Yet it was only recently that its first residents moved into the area.

#### **\$524K state grant promotes Cheney Brothers new hires**

Florida SouthWestern State College and Cheney Brothers Inc. have partnered together to receive a \$524,000 grant. The grant, part of FSW's Quick Response Training program, is funded through the Florida Economic Development Office and helps growing companies hire and train new employees.

"We have a lot of young employees with Cheney Brothers, so the grant helps us give them the extra training they need," said Punta Gorda Cheney Brothers president Shane Simmons. "The lengthy training programs often cost a lot of money but, this way, we get to invest in new employees." With the grant, Cheney Brothers hopes to continue to benefit Charlotte County by providing hundreds of job opportunities to the area. According to an FSW press release, the program will train up to 330 new hires.

## **Collier County**

### **Arthrex Expansions Leads to Over 1,700 New Jobs**

Arthrex has plans for growth. The medical device manufacturer is intending to build several new facilities, including an administrative and event center, hotel, and office building. This growth will add 560 new positions within the company, plus an additional 1,200 construction jobs.

### **Collier County Accelerators**

The Culinary Accelerator at Immokalee opens its doors on March 28th. The new business offers different membership levels where participants may select from a range of hours and plans to prepare, cook and package their own culinary creations and includes a commercial kitchen. They may also access funds and business assistance to see their product ideas come to life.

In addition to the Culinary Accelerator, the County also hosts a Business Accelerator in Naples. Community Health Partners of Iowa has set up shop at the Naples Accelerator to expand the health and wellness company's presence in Southwest Florida, which fits in with the county's interest in making a name for itself as a wellness destination and a community-wide Blue Zones well-being improvement initiative.

The Naples Chapter of SCORE, with more than 65 experienced advisers with varied business backgrounds, now offers counseling and workshops at the Naples Accelerator. Other like-minded groups are getting more involved too, providing services and hosting events at the accelerators, such as the Southwest Florida Regional Technology Partnership. Since it was founded, the Naples Accelerator has served 89 members. It has 37 active members, with plenty of room for more.

## **Glades and Hendry Counties**

### **Progress on the Glades County Regional Training Center Picks Up Speed**

For years there has been a widely held belief that education – training – is the way this long-time agricultural area will survive and thrive in the future. Although it is a standing goal to bring vocational training to Hendry and Glades on a large scale, the reality has been extremely difficult to accomplish.

For several years both Hendry and Glades have been systematically working toward that goal. The Glades County Regional Training Center (GCRTC) is at the core of the plan, the place where they hope to provide the training that will spark this area's economic rebirth by providing trained employees for manufacturing and logistics jobs.



The facility is currently offering GED and citizenship classes, provided by the Glades County School Board, and CDL classes, by Suncoast Trucking.

At a joint meeting April 5, commissioners, administrators and educators from both counties continued brainstorming about the future of GCRTC and its potential impact on the area. A successful training program like the one envisioned for the center could provide residents with good, solid employment and the county with economic stability.

### **Airglades Improvements**

A decade-long dream to transform a rural Florida airport into a multi-billion-dollar commercial hub for perishable cargo appears to be coming in for landing. It could be the catalyst Hendry County needs to pull it skyward from the depths of among the state's poorest counties. An Airport Executive expects the airport's cargo hub to employ about 1,000 people by 2021.

The Airglades project is estimated to cost \$650 million, with \$20 million already invested by Florida Cargo Fresh, a consortium of partners that includes U.S. Sugar, Hilliard Brothers (large agricultural companies and the county's two largest land owners, which own almost all the land surrounding the airport). If it comes to fruition, Airglades International Airport would become the first Federal Aviation Administration-sanctioned and privatized commercial cargo airport in the United States. Hendry County is looking to maximize the potential of Airglades by improving the infrastructure around the airport.

### **Lee County**

#### **Gartner Inc. Expansion Leads to 800 New Jobs**

Gartner Inc. is an international firm that specializes in research and consulting with plans for expansion. It's campus in south Fort Myers will be hiring up to 800 new employees.

#### **Newcastle Aviation Groundbreaking**

Construction has begun on the new world headquarters location for Newcastle Aviation, a global aviation company supporting the commercial airline, regional airline and general aviation industries. The company is moving its headquarters from Burnsville, Minnesota, to Southwest Florida due to the tax incentives provided by the county and state as well as the growing aviation industry in Florida.

Newcastle Aviation provides asset management, sales, acquisitions, leases and appraisals on aviation components and parts on a global scale. The 40,000-square-foot facility will house the executive and general office staff, storage area with rack system, conference rooms, break room and a 10,000-square-foot area for leasing with room for expansion. Construction began in June with the groundbreaking

ceremony on July 10 at the jobsite on Domestic Avenue in Fort Myers. The project is designed by Studio A.D. Architects and is slated to be complete by January 2019.

### **Sarasota County**

#### **Atlanta Braves Spring Training Facility in North Port**

The \$110 million spring training facility is a joint collaboration between the city, county, the Braves and West Villages. The Atlanta Braves Spring Training stadium is receiving credit for transforming the region already. The Florida Economic Development Council recently named the stadium its regional “Deal of the Year,” citing the 139 jobs and \$1.7 billion economic impact it is slated to bring to Southwest Florida.

The park will be completed ahead of the 2019 spring training season, but the Braves will play in Lake Buena Vista most of that season. The final game of the 2019 spring training season will be played in North Port. When completed, the stadium will have 6,500 fixed seats, luxury suites and room for another 2,500 for general admission on a berm, as well as a 360-degree concourse. A large grass parking field and entrance plaza will be available for public use. The county and the city will be able to use the stadium for 10 events every year.

### **SWFRPC**

#### **Brownfield Coalition Assessment Grant**

On June 25, 2018, EPA announced that the SWFRPC was awarded a 3 year, \$600,000 Brownfield Coalition Assessment Grant. The project area is the SWFL Promise Zone, which is comprised of Glades County, Hendry County, and the Immokalee CDP in Collier County. Each of these Counties serve on the Southwest Florida Brownfields Coalition. The grant funds up to 35 Phase 1 ESAs (Environmental Site Assessments), 14 Phase 2 ESAs, 1 General QAPP (Quality Assurance Project Plan), and 6 RAPs (Remedial Action Plans). The grant also allows for public outreach meetings and materials.

The assessments and plans created by the grant will prepare potentially contaminated sites for brownfield cleanup. Once cleanup occurs, these economically distressed communities will have new sites ready for commercial development. The communities within the Promise Zone are economically dependent on agriculture and have some of the worst unemployment and poverty rates in the State. The Coalition currently has 6 sites identified for assessment.

## Report Summary

The CEDS Annual Update Report shall discuss the following statements required by the Economic Development Administration (EDA). This report reflects 2018.

### I. Any changes in technical components of the CEDS as required by the EDA's CEDS Summary of Requirements

**Response:** There have been no changes to the technical component of the CEDS during 2018.

### II. Performance of the CEDS based upon the performance evaluation criteria established in the CEDS

Performance Measures, Page 22 of the CEDS Technical Report Document

#### 1. Number of Jobs Created After Implementation of the Comprehensive Economic Development Strategy

County	Total Employment				
	2008	2012	2017	10 Year Change	5 Year Change
Charlotte	63,728	59,630	67,028	5.2%	12.4%
Collier	137,814	139,903	164,974	19.7%	17.9%
Glades	4,345	5,263	4,782	10.1%	-9.1%
Hendry	15,619	14,832	14,518	-7.0%	-2.1%
Lee	262,214	266,573	322,180	22.9%	20.9%
Sarasota	154,823	153,880	178,650	15.4%	16.1%
Region	638,543	640,081	752,132	17.8%	17.5%
Florida	8,637,000	8,592,000	9,681,000	12.1%	12.7%

Source: Florida Department of Economic Opportunity (DEO)

#### 2. Number and Types of Public Sector Investments Undertaken in the Region

##### a. EDA Sponsored Investments

**Response:**

Disaster Recovery Coordinator- \$250,000

Agricultural Sustainability Implementation Study- \$206,545

**Total: \$456,545**

##### b. Significant State and Local Investments

**Response:**

\$73.9 million (SWFLA International Airport Improvements - Vital Project)

Immokalee TIGER Grant (Federal): \$13 million

Region-wide FAA Grants (Federal): \$7.65 million

Collier County Florida Job Growth Fund (Manufacturing Training) : \$3 million

Charlotte County Florida Job Growth Fund (Infrastructure): \$800,000

EPA Brownfield Coalition Assessment Grant (Federal): \$600,000

Cheney Brothers/FSW Quick Response Training Grant: \$524,000

**Total: \$99.5 million**

### 3. Number of Jobs Retained in the Region

#### a. Number of Jobs Retained as a Result of Federal Investments

**Response:** 585 jobs (SWFLA International Airport Improvements/Vital Project)

#### b. Number of Jobs Retained as a Result of Select State and Local Investments

**Response:** 43 jobs (SWFLA International Airport Improvements/Vital Project)

### 4..Amount of Private Sector Investment in the Region After Implementation of the Comprehensive Economic Development Strategy

**Response:** None

### 5. Changes in the Economic Environment of the Region

#### a. Housing Costs

County	Median Housing Value					Change
	2012	2013	2014	2015	2016	
Charlotte	154,300	143,700	140,900	145,700	154,400	0.1%
Collier	280,700	261,300	258,400	272,800	291,900	4.0%
Glades	84,400	87,700	84,100	84,500	79,200	-6.2%
Hendry	89,100	81,400	72,400	72,400	70,600	-20.8%
Lee	161,400	149,400	150,000	157,400	171,100	6.0%
Sarasota	191,600	175,000	172,800	181,400	196,800	2.7%
SWFL*	190,802	176,669	175,376	184,113	198,433	4.0%
Florida	170,800	160,200	156,200	159,000	166,800	-2.3%

\*SWFL value is estimated using weighted median values of each County

Source: census.gov

b. Educational Attainment

Educational Attainment						
County	2012	2013	2014	2015	2016	Change
Bachelor's Degree or Higher						
Charlotte	21.1%	21.2%	20.9%	20.8%	21.6%	0.5%
Collier	31.4%	31.7%	32.3%	33.2%	33.9%	2.5%
Glades	10.2%	12.2%	10.3%	8.4%	8.9%	-1.3%
Hendry	9.7%	9.9%	10.6%	9.8%	9.1%	-0.6%
Lee	24.6%	24.7%	25.3%	26.0%	26.7%	2.1%
Sarasota	29.9%	30.8%	31.1%	32.4%	33.1%	3.2%
SWFL	26.6%	26.9%	27.4%	28.1%	28.8%	2.2%
Florida	26.2%	26.4%	26.8%	27.3%	27.9%	1.7%
High School Graduate or Higher						
Charlotte	88.4%	88.8%	89.1%	89.3%	89.4%	1.0%
Collier	85.1%	85.8%	85.7%	86.0%	85.7%	0.6%
Glades	75.6%	78.0%	76.0%	76.9%	74.4%	-1.2%
Hendry	64.3%	64.4%	65.7%	63.0%	62.9%	-1.4%
Lee	87.1%	86.9%	86.9%	87.0%	87.0%	-0.1%
Sarasota	91.6%	91.9%	92.2%	92.4%	92.6%	1.0%
SWFL	87.4%	87.6%	87.7%	87.8%	87.8%	0.4%
Florida	85.8%	86.1%	86.5%	86.9%	87.2%	1.4%

Source: census.gov

c. Age Cohort Growth in Workforce Age

SWFL Population by Age Range						
Age Range	2012	2013	2014	2015	2016	Change
Under 20 Years	312,271	311,575	312,917	313,949	315,974	1.2%
20 to 54 Years	591,614	592,009	595,523	600,852	606,086	2.4%
55 and Over	636,298	654,389	675,233	699,421	726,595	14.2%

Source: census.gov

## d. Change in Commercial &amp; Residential Building Permits

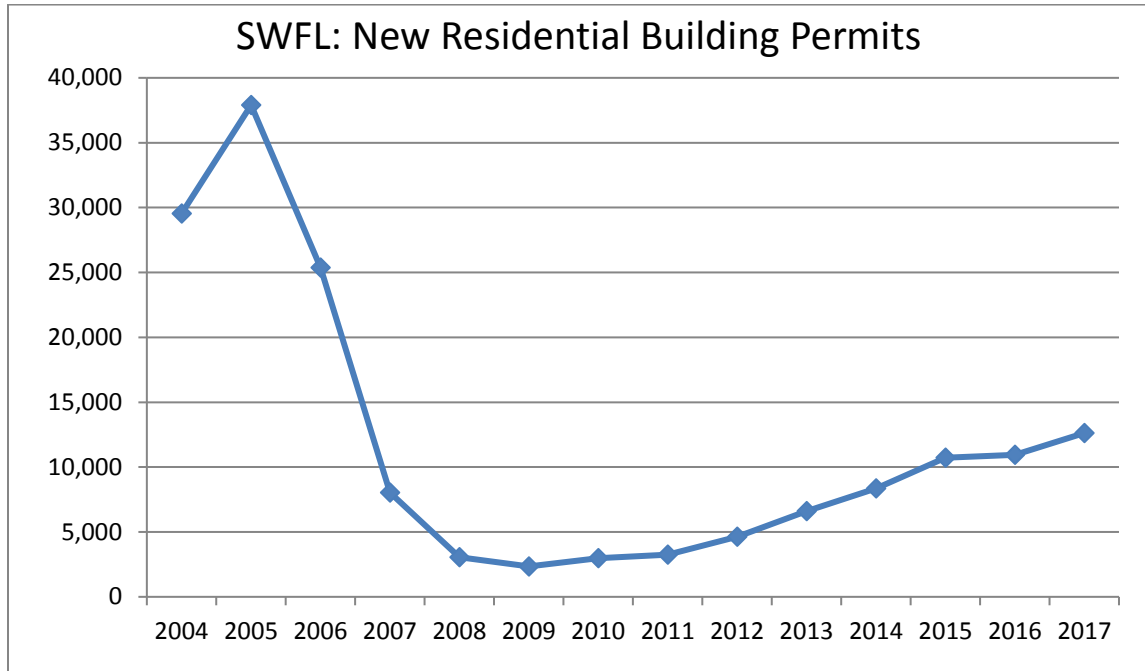

Source: census.gov

## e. Changes in Wage and Income

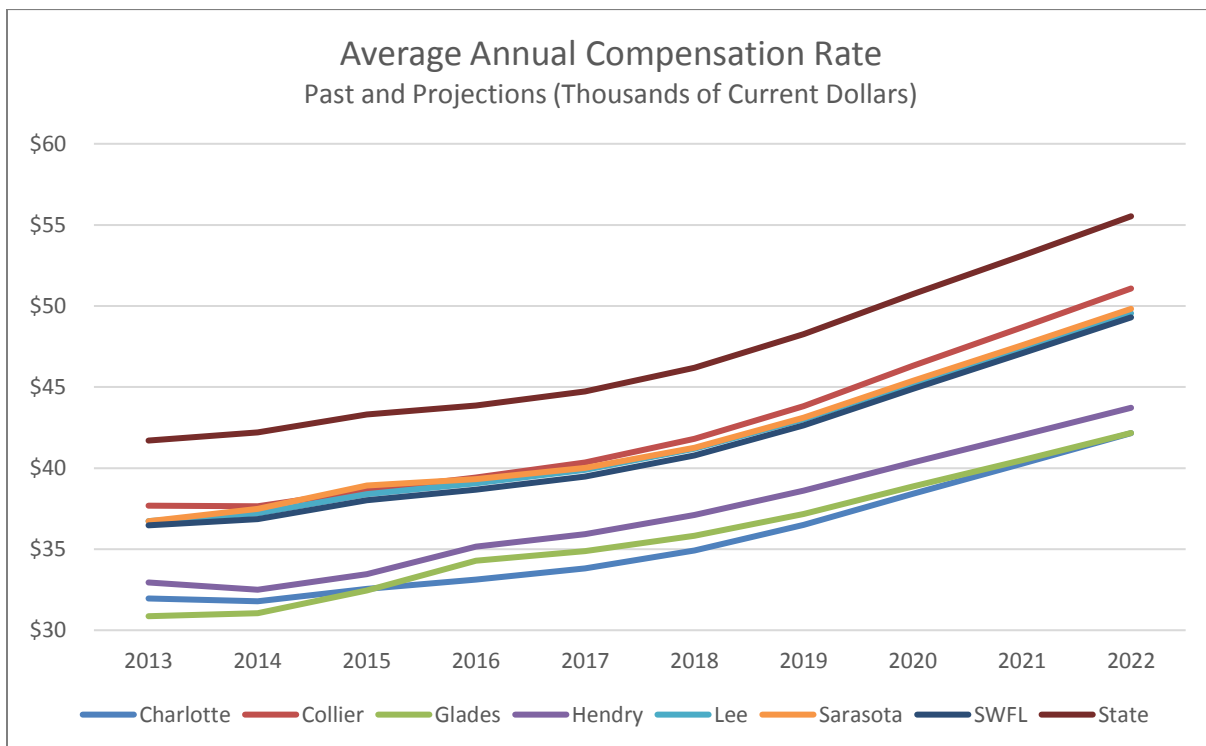

Source: Regional Economic Modeling, Inc., Policy Insight+, v2.2.2

## f. Change in Employment by industry

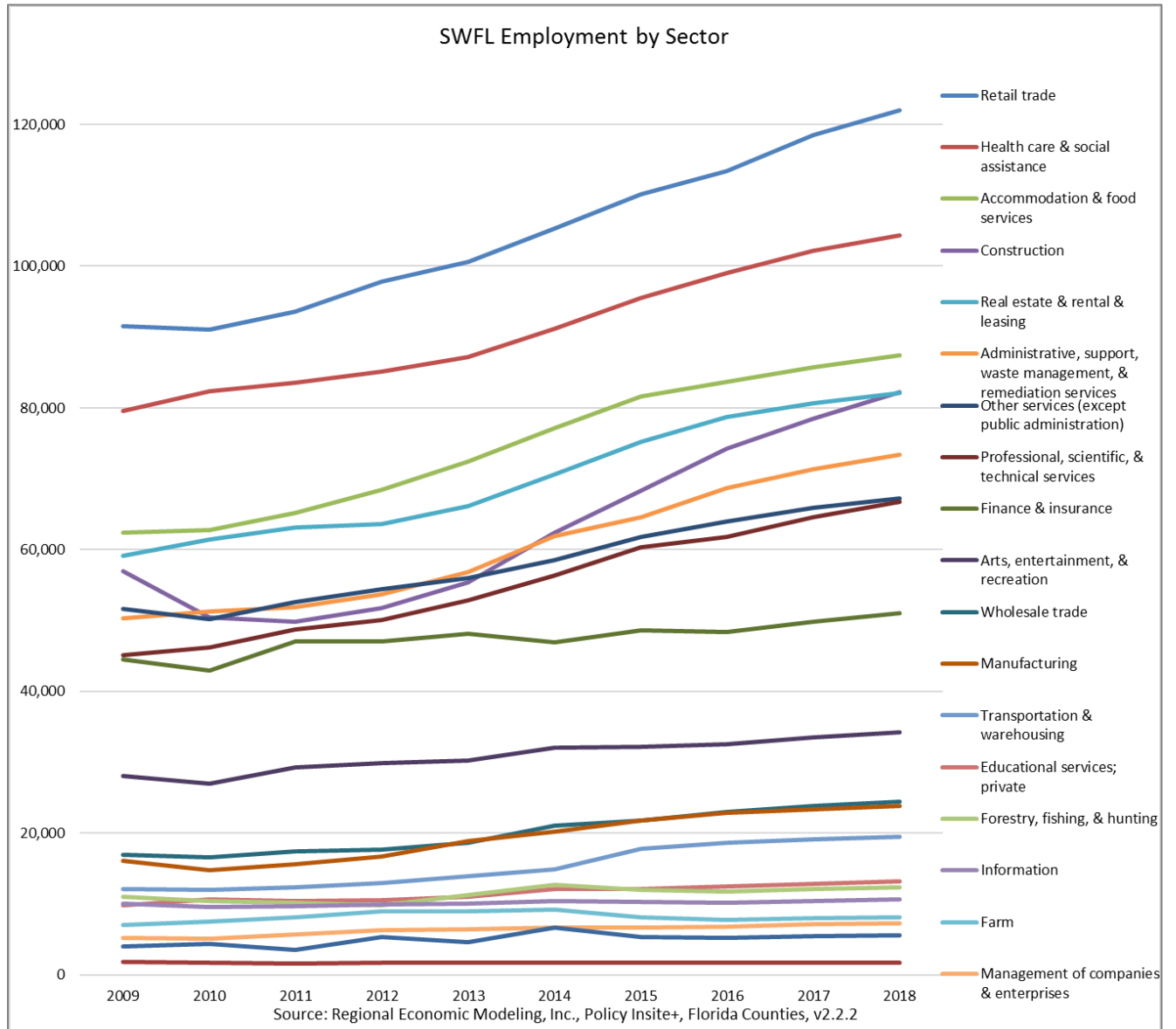

## Description of community involvement in the CEDS process

Staff continues to work closely with to actively engage participation from the community. The Council staff maintains the SWFRPC website and project portal where relevant information is available. For more information visit: [www.swfrpc.org](http://www.swfrpc.org)

The program page for Economic Development Planning (EDD) is located here:

[http://www.swfrpc.org/eco\\_dev.html](http://www.swfrpc.org/eco_dev.html)

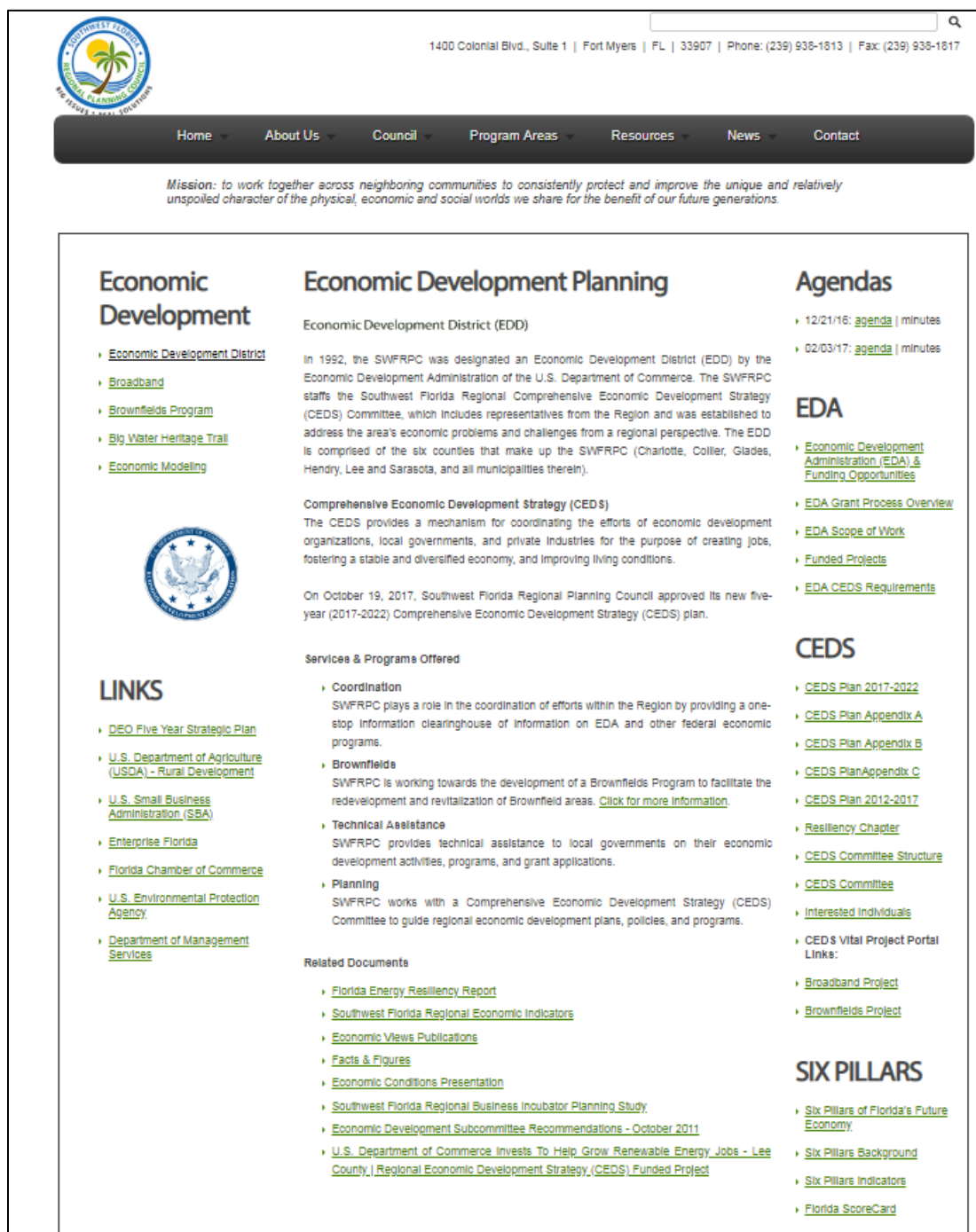

**Economic Development**

- [Economic Development District](#)
- [Broadband](#)
- [Brownfields Program](#)
- [Big Water Heritage Trail](#)
- [Economic Modeling](#)

**Economic Development Planning**

Economic Development District (EDD)

In 1992, the SWFRPC was designated an Economic Development District (EDD) by the Economic Development Administration of the U.S. Department of Commerce. The SWFRPC staffs the Southwest Florida Regional Comprehensive Economic Development Strategy (CEDS) Committee, which includes representatives from the Region and was established to address the area's economic problems and challenges from a regional perspective. The EDD is comprised of the six counties that make up the SWFRPC (Charlotte, Collier, Glades, Hendry, Lee and Sarasota, and all municipalities therein).

**Comprehensive Economic Development Strategy (CEDS)**

The CEDS provides a mechanism for coordinating the efforts of economic development organizations, local governments, and private industries for the purpose of creating jobs, fostering a stable and diversified economy, and improving living conditions.

On October 19, 2017, Southwest Florida Regional Planning Council approved its new five-year (2017-2022) Comprehensive Economic Development Strategy (CEDS) plan.

**Services & Programs Offered**

- **Coordination**  
SWFRPC plays a role in the coordination of efforts within the Region by providing a one-stop information clearinghouse of information on EDA and other federal economic programs.
- **Brownfields**  
SWFRPC is working towards the development of a Brownfields Program to facilitate the redevelopment and revitalization of Brownfield areas. [Click for more information.](#)
- **Technical Assistance**  
SWFRPC provides technical assistance to local governments on their economic development activities, programs, and grant applications.
- **Planning**  
SWFRPC works with a Comprehensive Economic Development Strategy (CEDS) Committee to guide regional economic development plans, policies, and programs.

**Related Documents**

- [Florida Energy Resiliency Report](#)
- [Southwest Florida Regional Economic Indicators](#)
- [Economic Views Publications](#)
- [Facts & Figures](#)
- [Economic Conditions Presentation](#)
- [Southwest Florida Regional Business Incubator Planning Study](#)
- [Economic Development Subcommittee Recommendations - October 2011](#)
- [U.S. Department of Commerce Invests To Help Grow Renewable Energy Jobs - Lee County, Regional Economic Development Strategy \(CEDS\) Funded Project](#)

**Agendas**

- 12/21/16: [agenda](#) | [minutes](#)
- 02/03/17: [agenda](#) | [minutes](#)

**EDA**

- [Economic Development Administration \(EDA\) & Funding Opportunities](#)
- [EDA Grant Process Overview](#)
- [EDA Scope of Work](#)
- [Funded Projects](#)
- [EDA CEDS Requirements](#)

**CEDS**

- [CEDS Plan 2017-2022](#)
- [CEDS Plan Appendix A](#)
- [CEDS Plan Appendix B](#)
- [CEDS Plan Appendix C](#)
- [CEDS Plan 2012-2017](#)
- [Resiliency Chapter](#)
- [CEDS Committee Structure](#)
- [CEDS Committee](#)
- [Interested Individuals](#)
- [CEDS Vital Project Portal Links:](#)
- [Broadband Project](#)
- [Brownfields Project](#)

**SIX PILLARS**

- [Six Pillars of Florida's Future Economy](#)
- [Six Pillars Background](#)
- [Six Pillars Indicators](#)
- [Florida ScoreCard](#)

**LINKS**

- [DEO Five Year Strategic Plan](#)
- [U.S. Department of Agriculture \(USDA\) - Rural Development](#)
- [U.S. Small Business Administration \(SBA\)](#)
- [Enterprise Florida](#)
- [Florida Chamber of Commerce](#)
- [U.S. Environmental Protection Agency](#)
- [Department of Management Services](#)



A status update of the projects listed in the CEDS. (Projects are listed by lead organization)

<b>Vital Project</b>	<b>Lead Organization</b>	<b>Status</b>
Charlotte County Incubator	Charlotte County	<b>In Progress</b>
Murdock Village	Charlotte County	<b>In Progress</b>
Charlotte Harbor Redevelopment Catalyst Project	Charlotte County	<b>In Progress</b>
Punta Gorda Interstate Airport Park (i.e. ECAP) - Piper Road Extension and Infrastructure Improvements	Charlotte County	<b>Planning</b>
Charlotte County Residential Centers / Employment Hubs - Vehicular and Pedestrian Interconnectivity	Charlotte County	<b>Planning</b>
Expansion of the Immokalee/Naples Business Development Center to include Incubators/Accelerators	Collier County	<b>In Progress</b>
Logistics Center (America Gateway Logistics - Phase 1)	Glades County	<b>In Progress</b>
Develop Material Handling Industry of America (MHIA) Training Center for Logistics/manufacturing	Glades/Hendry Counties	<b>In Progress</b>
AirGlades Airport Development	Hendry County	<b>In Progress</b>
Multi-Family Housing for Essential Service Employees	Hendry County	<b>Planning</b>
Four Corners Stormwater/Water Quality Project	Hendry County	<b>In Progress</b>
Wastewater Infrastructure on US27/SR80	Hendry County	<b>Planning</b>
Tiger Village	Hendry County	<b>Planning</b>
Warm Mineral Springs	City of North Port	<b>Planning</b>
West Villages	North Port	<b>In Progress</b>

Southwest Florida International Airport Improvements	Lee County Port Authority	<b>In Progress</b>
47th Terrace Improvements	City of Cape Coral	<b>Planning</b>
Academic Village	City of Cape Coral	<b>Planning</b>
Bimini Basin	City of Cape Coral	<b>Planning</b>
Burnt Store Rd. City Parcel	City of Cape Coral	<b>Planning</b>
Cape Coral UEP & Fiber Optic	City of Cape Coral	<b>Planning</b>
Festival Park	City of Cape Coral	<b>Planning</b>
Kismet Industrial Park	City of Cape Coral	<b>Planning</b>
Seven Islands	City of Cape Coral	<b>Planning</b>
Repositioning the talent delivery system in the Southwest Florida Region	SWF Workforce Development Board	<b>In Progress</b>
Preservation of the Rural Counties Tax Base	SWFRPC	<b>On Hold</b>
Regional Transportation Plan	SWFRPC/MPOs	<b>In Progress</b>
Regional Economic Development Opportunity Map	SWFRPC/Economic Development Directors	<b>On Hold</b>
Promise Zone	SWFRPC	<b>In Progress</b>
<b>Completed</b>		
Fort Myers Riverfront Redevelopment Project	Fort Myers/CRA/ Lee County	<b>Completed</b>
Establish partnerships for the creation of a Regional Economic Development Agency to promote centralized data and regional marketing efforts	Regional EDO's/FGCU	<b>Completed</b>
Regional Pre-Machining Training	SWF Workforce Development Board/I-Tech/Immokalee	<b>Completed</b>

CNC Training	SWF Workforce Development Board/I-Tech/Immokalee	<b>Completed</b>
Research and Enterprise Diamond	Lee County/FGCU	<b>Completed</b>
Prepare a regional plan and identify place-making projects that improve the quality of life	SWFRPC	<b>Completed</b>
Create an Ad-Hoc Committee to evaluate and recommend legal & regulatory reform to address government efficiency.	SWFRPC	<b>Completed</b>

The SWFRPC worked on the following projects also identified in the CEDS.

<b>Important Projects</b>	<b>Program</b>	<b>Status</b>
GrowFL - Economic Gardening	Regional Entrepreneurial Support	<b>In Progress</b>
Identify solutions to “food deserts”	Industry Cluster Development	<b>In Progress</b>
Regional Industry Cluster Study	Industry Cluster Development	<b>Pre-Planning</b>
VA Clinic & Development of Veteran’s Investment Zone	Regional Innovation	<b>In Progress</b>
Widening of Sumter Boulevard as a hurricane evacuation route – City of North Port	Regional Infrastructure	<b>In Progress</b>
Road Bond Project – City of North Port	Regional Infrastructure	<b>In Progress</b>
Water Expansion Pilot Program – City of North Port	Regional Infrastructure	<b>Pre-Planning</b>
Punta Gorda Interstate Airport Park	Innovation & Economic Development	<b>In Progress</b>
Downtown & Central Fort Myers Redevelopment (CRA)	Industry Cluster Development	<b>In Progress</b>
Future Makers	Southwest Florida Community Foundation	<b>In Progress</b>
Regional Broadband Plan	Regional Infrastructure	<b>Completed 2013 Collier, Charlotte and Lee</b>

Eastern Immokalee Sidewalk Project	Regional Infrastructure	<b>Pre-Planning</b>
Immokalee Sidewalk Improvement Project	Regional Infrastructure	<b>Pre-Planning</b>
Eleven Bridge Replacements Project-Collier County	Regional Infrastructure	<b>Pre-Planning</b>
Immokalee Stormwater Improvement Program	Regional Infrastructure	<b>Pre-Planning</b>
SR 29 (Main Street) Improvements-Immokalee	Regional Infrastructure	<b>Pre-Planning</b>

<b>Future Projects</b>	<b>Program</b>	<b>Status</b>
Prevent Childhood Obesity by Building Healthy Habits	Regional Education and Training Focus	<b>Pre-Planning</b>
Farmland preservation and sustainable agricultural practices	Regional Entrepreneurial Support	<b>Pre-Planning</b>
Agriculture Impact and Strategy Study	Industry Cluster Development	<b>Pre-Planning</b>

### **Council FY 2019 Budget**

Adopted: June, 21, 2018

[http://www.swfrpc.org/content/Budget\\_Finance/FY19\\_SWFRPC\\_Adopted\\_Budget\\_Packet.pdf](http://www.swfrpc.org/content/Budget_Finance/FY19_SWFRPC_Adopted_Budget_Packet.pdf)

# Agenda Item

9

Presentations

9

9

# --- Agenda --- Item

9a

Council Relevancy

9a

9a

# --- Agenda --- Item

9b

SWFL Full-Scale  
HazMat Exercise

9b

9b

# Agenda Item

10

Director's Report

10

10





## EXECUTIVE DIRECTOR'S REPORT: September 20, 2018

### **Mission Statement:**

*To work together across neighboring communities to consistently protect and improve the unique and relatively unspoiled character of the physical, economic and social worlds we share...for the benefit of our future generations.*

### **1. Management / Operations**

#### **a. Budget**

- May Financials
- June Financials
- July Financials

### **2. Resource Development and Capacity Building**

- Post-Disaster Coordinator Update- Sean McCabe
- Promise Zone Update – Margaret Wuerstle
- FRCA Monthly Report – attached
- VISTAs : Yvonne Hill and Michael Bennett

### **3. Fourth Quarter FY 2017-2018 (July 1, 2018 - September 30, 2018)**

- Grants Awarded:
  - ✓ DEO grant for \$30,000: Development of Food safety Plans
  - ✓ EDA grant for \$206,545: Regional Ag Sustainability Implementation
  - ✓ EDA- Disaster Coordinator; \$250,000
  - ✓ Brownfields grant \$600,000
- Grants Under Development
- Grants Pending: \$172,300 approximately
  - ✓ FHERO- RDG Grant: \$82,300
  - ✓ FDEP – Ecosystem Services – Aquatic Preserves Valuation: \$90,000



## MONTHLY ACTIVITY REPORT: July 2018

### **RESOURCE DEVELOPMENT/CAPACITY BUILDING and OUTREACH**

- Organized and distributed the June 2018 Florida Regional Councils Association (FRCA) Newsletter, *FRCA Forward*. Began collecting articles and formatting the July 2018 Newsletter. Continued to update the FRCA Facebook page.
- Continued to update and maintain the email listserv for the more than 2,500 individuals who receive *FRCA Forward*.
- Continued to work with the Florida Association of Counties to maintain and enhance the FRCA website: [www.flregionalcouncils.org](http://www.flregionalcouncils.org).
- To enhance partnerships and strengthen the relationship between regional planning councils and their state and federal partners, participated in or attended the Safe Mobility for Life Coalition Summer Meeting held in Tallahassee.

### **ASSOCIATION MANAGEMENT**

- Prepared for the August 16 and 17, 2018, Executive Directors Advisory Committee and Policy Board Meetings including developing agendas, preparing meeting materials and securing presenters.
- Coordinated FRCA participation with the following upcoming annual conferences:
  - Florida League of Cities, August 15 – 17<sup>th</sup>
  - American Planning Association, Florida Chapter, September 11 – 13<sup>th</sup>
  - Future of Florida Forum, September 26 – 28<sup>th</sup>
- Developed the 2019 meeting schedule and began coordinating logistics for those meetings.
- Distributed grant opportunities and information of interest from local, state and national organizations.

# Agenda Item

10a

Budget Amendments

10a

10a

# Southwest Florida Regional Planning Council

OCTOBER 1, 2016 TO SEPTEMBER 30, 2017

4th Amendment to 2016-2017 Approved Budget

## APPROVED BUDGET AMENDMENTS

Revenues	Adopted FY 2017 Budget	Proposed Changes	SWFRPC General Fund	SWFRPC Special Revenue	Proposed Budget Amendment FY2017
Assessments	\$ 485,948				485,948
Secured Federal/State Grants	414,471				414,471
*Program Development (Unsecured Grants/Contracts)	16,339	*			16,339
Secured Contractual	47,900				47,900
DRIs/NOPCs/Other Reviews	44,981				44,981
Interest/Misc	5,199				5,199
**Fund Balance from Audit YE 9/30/16	588,437	811,779 **			811,779
<b>Total Income (Revenue)</b>	<b>\$ 1,603,275</b>	<b>\$ 811,779</b>	<b>\$ -</b>	<b>\$ -</b>	<b>\$ 1,826,617</b>

Expenditures (Expenses)					
Direct:					
Salaries (A)	\$ 408,068				\$ 408,068
FICA	30,178				\$ 30,178
Unemployment	-				\$ -
Workers Compensation	2,140				\$ 2,140
Retirement	42,361				\$ 42,361
Health Insurance (B)	57,706				\$ 57,706
<b>Total Personnel Expenses</b>	<b>\$ 540,453</b>	<b>\$ -</b>	<b>\$ -</b>	<b>\$ -</b>	<b>\$ 540,453</b>

Expenses					
Consultants (C)	\$ 144,468				\$ 144,468
Grant/Consulting - Contractual (D)	44,848				\$ 44,848
Audit Fees	32,000				\$ 32,000
Travel	33,170				\$ 33,170
Telephone	4,422				\$ 4,422
Postage	1,628				\$ 1,628
Equipment Rental (E)	6,356				\$ 6,356
Insurance (F)	10,935				\$ 10,935
Repair/Maint. (Grounds/Bldg/Equip)	1,035				\$ 1,035
Printing/Reproduction	5,037				\$ 5,037
Utilities (Elec/Internet)	17,351				\$ 17,351
Advertising	2,543				\$ 2,543
Other Miscellaneous	186				\$ 186
Bank Service Charges	-				\$ -
Office Supplies	3,416				\$ 3,416
Computer Related Expenses (G)	22,684				\$ 22,684
Dues and Memberships (H)	24,367				\$ 24,367
Publications	-				\$ -
Professional Development	991				\$ 991
Meetings/Events	6,948				\$ 6,948
Capital Outlay-Operations	-				\$ -
Capital Outlay-Building	-				\$ -
Lease Long Term	43,750				\$ 43,750
**Fund Balance from Audit YE 9/30/16	588,437	811,779 ***			\$ 811,779
<b>Operational Expense</b>	<b>\$ 994,572</b>	<b>\$ 811,779</b>	<b>\$ -</b>	<b>\$ -</b>	<b>\$ 1,217,914</b>

<b>Fringe/Indirect Allocation</b>					\$ -
<b>Utilized Reserve</b>					
<b>Total Operational Expenses</b>	<b>994,572</b>	<b>811,779</b>	<b>0</b>	<b>0</b>	<b>1,217,914</b>
<b>Total Cash Outlays</b>	<b>\$ 1,535,025</b>	<b>\$ 811,779</b>	<b>\$ -</b>	<b>\$ -</b>	<b>\$ 1,758,367</b>

<b>Net Income/Loss</b>	<b>\$ 68,250</b>	<b>\$ -</b>	<b>\$ -</b>	<b>\$ -</b>	<b>\$ 68,259</b>
------------------------	------------------	-------------	-------------	-------------	------------------

\*Program Development (Unsecured Grants/Contracts) - additional funding secured in the amount of \$16,339 from March - September 2017.

\*\*Fund Balance from Audit YE 9/30/16 (FY15/16) - included in this fund is the investments, operating funds and net of all assets and liabilities.

\*\*\*The Fund Balance - End of Year Updated to reflect audited Fund Balance \$811,779.

\*\*\*\*The Council approved by resolution on 4/21/16 to include investments in the budget. Investments consist of Money Market and Government Pool. The balance will increase over time as interest accrues.

	Adopted FY 2016 Budget	Proposed Changes		SWFRPC General Fund	SWFRPC Special	Proposed Budget
Investments as of 9/30/17	-	-		\$ 852,347	\$ -	\$ 852,347

Council Approved 1st Amendment: 7/14/16

Council Approved 2nd Amendment: 3/16/17

Council Approved 3rd Amendment: 12/14/17

Council Proposed 4th Amendment: 9/20/18

# Agenda Item

10b

2018 Financials

10b

10b

# 2017 - 2018 Workplan & Budget Financial Snapshot

## Jul-18

### Revenues

Local Assessments  
Total Federal/State Grants  
Misc. Grants/Contracts  
Other Revenue Sources

Monthly Revenues

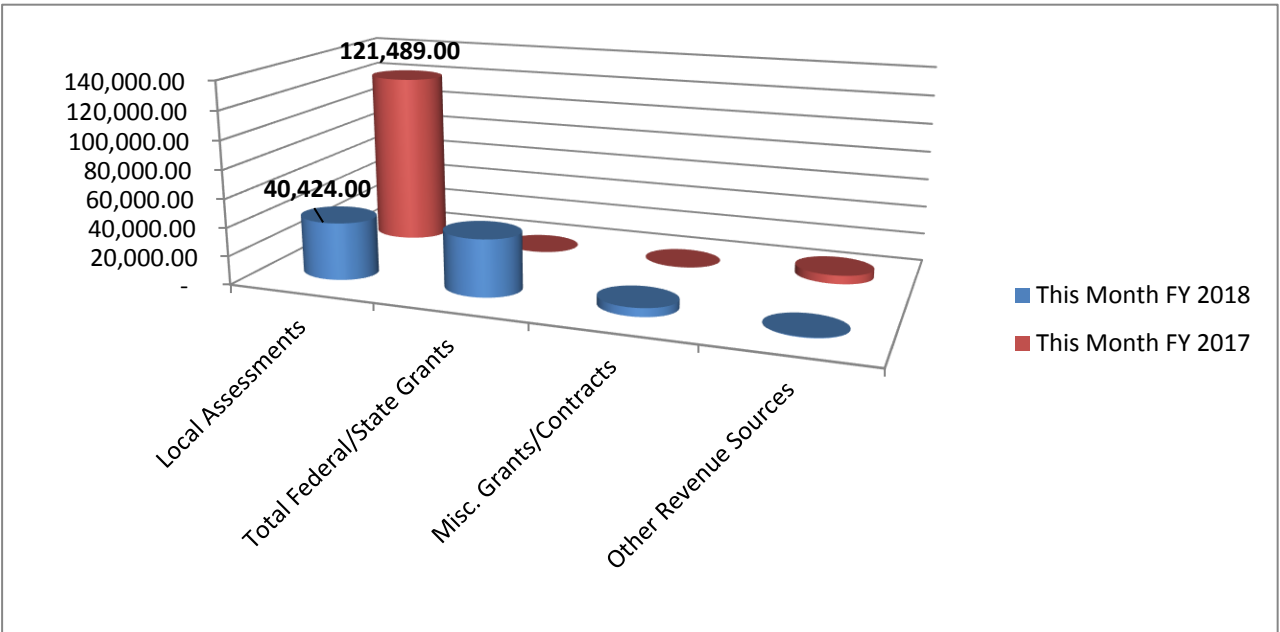

Notes: Local Assessments billed at the beginning of each quarter: October, January, April and July  
State/Federal Grants billed quarterly: LEPC, HMEP, TD, and EPA  
Federal Grants billed Semi Annually: Economic Development  
Misc. Grants/Contracts billed by deliverable: SQG, Interagency PO'S  
Other(DRI) billed /recorded monthly as cost reimbursement

Monthly Net Income

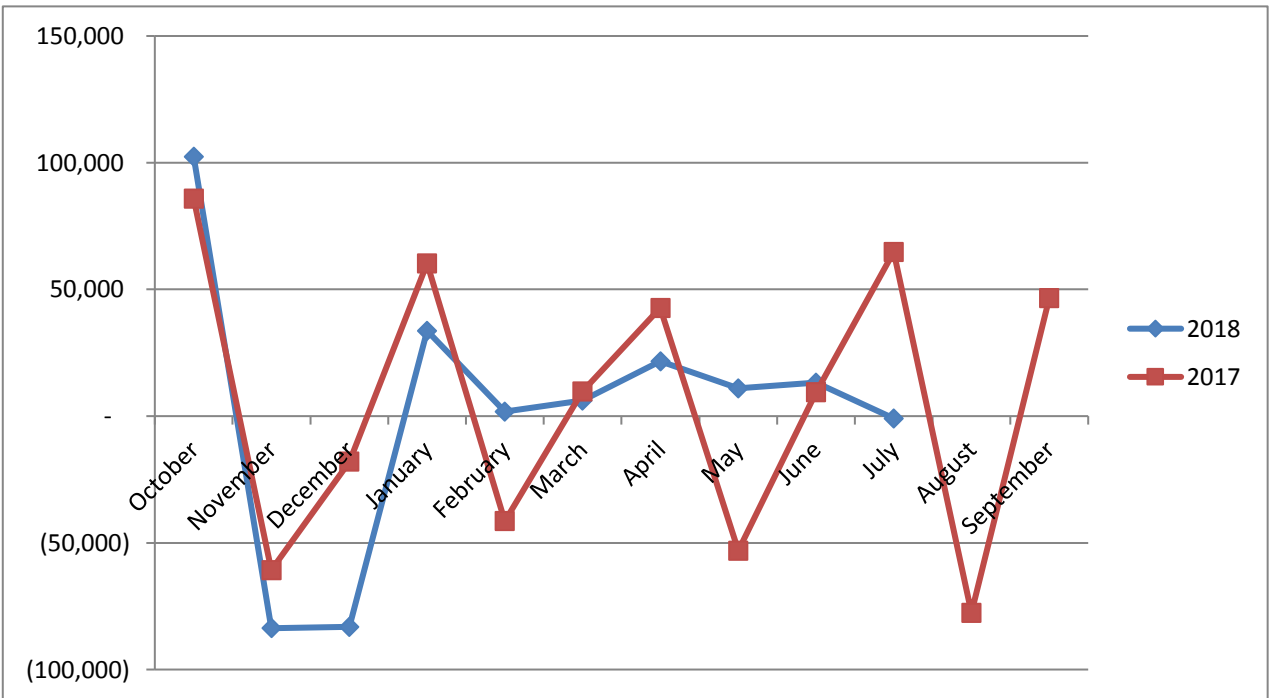

YTD: Net Income \$21,848 Unaudited

# SWFRPC

## Detail of Reserve

### As of JULY 31, 2018

***Cash and Cash Equivalents:***

Petty Cash	\$	200
FineMark Operating Funds		114,536
2016 Fiscal Year Carryover		22,258
		<hr/>
<b><i>Total Cash and Cash Equivalents</i></b>	<b>\$</b>	<b>136,994</b>

***Investments:***

FineMark Money Market	\$	488,181
Local government Surplus Trust Fund Investment Pool (Fund A)		139,822
		<hr/>
<b><i>Total Investments</i></b>	<b>\$</b>	<b>628,003</b>

Total Reserves	<hr/>	<hr/>
	<b>\$</b>	<b>764,997</b>
		<hr/>

**SWFRPC INCOME STATEMENT  
COMPARED WITH BUDGET**

84 of 124

**FOR THE ONE MONTH ENDING JULY 31, 2018**

**FY 2017-2018**

	<b>Current Month</b>	<b>Year to Date A</b>	<b>Approved Budget Amendments May 2018 - B</b>	<b>% Of Budget Year to Date</b>	<b>Budget Remaining</b>
<b>REVENUES</b>					
<b>LOCAL ASSESSMENTS</b>					
CHARLOTTE COUNTY	\$ -	\$ 38,351	\$ 38,351	100%	\$ -
COLLIER COUNTY	26,265	105,060	105,061	100%	\$ 1
GLADES COUNTY	979	3,916	3,914	100%	\$ (2)
HENDRY COUNTY	2,878	11,512	11,511	100%	\$ (1)
LEE COUNTY	-	83,859	83,858	100%	\$ (1)
CITY OF CAPE CORAL	-	30,771	51,142	60%	\$ 20,371
CITY OF FORT MYERS	5,708	22,832	22,832	100%	\$ -
TOWN OF FORT MYERS BEACH INC	471	1,884	1,883	100%	\$ (1)
BONITA SPRINGS	3,629	14,516	14,516	100%	\$ -
CITY OF SANIBEL	494	1,976	1,977	100%	\$ 1
SARASOTA COUNTY	-	29,965	29,965	100%	-
<b>TOTAL LOCAL ASSESSMENTS</b>	<b>\$ 40,424</b>	<b>\$ 344,642</b>	<b>\$ 365,010</b>	<b>94%</b>	<b>\$ 20,368</b>
<b>FEDERAL / STATE GRANTS</b>					
DEM - LEPC 17/18	26,869	63,961	80,000	80%	16,039
DEM - HMEP 16/17	-	23,680	23,871	99%	191
DEM - HMEP 17/18	13,313	41,553	60,349		
TD Glades/Hendry 17/18	-	29,148	18,367	159%	(10,781)
DEM - Collier Hazard Analysis 17/18	-	20,844	20,844	100%	-
Wetland Mitigation Strategy - EPA	-	82,500	110,000	75%	27,500
Promise Zone	-	1,476	-	N/A	(1,476)
DEO Agricultural Sustainability	-	30,000	30,000	100%	-
Disaster Recovery Coordinator	-	21,978	100,000	22%	78,022
National Community Service	-	-	30,000	0%	30,000
Economic Development Planning 17/19	-	37,316	70,000	53%	32,684
<b>TOTAL FEDERAL / STATE GRANTS</b>	<b>\$ 40,182</b>	<b>\$ 352,457</b>	<b>\$ 543,431</b>	<b>65%</b>	<b>\$ 155,948</b>
<b>MISC. GRANTS / CONTRACTS/CONTRACTUAL</b>					
GLADES SQG	-	-	4,500	0%	4,500
Bonita Springs Flooding	-	50,000	50,000	100%	-
Bonita Springs Affordable Housing	-	15,000	30,000	50%	15,000
HERO	6,000	6,000	6,000	100%	-
<b>TOTAL MISC. GRANTS/CONTRACTS</b>	<b>\$ 6,000</b>	<b>\$ 71,000</b>	<b>\$ 90,500</b>	<b>78%</b>	<b>\$ 19,500</b>
<b>DRIS/NOPCS/MONITORING</b>					
DRI MONITORING FEES	-	\$ 1,500	\$ -		\$ 1,500
DRIS/NOPCS INCOME		92,959	35,000	266%	(57,959)
<b>TOTAL</b>	<b>\$ -</b>	<b>\$ 94,459</b>	<b>\$ 35,000</b>	<b>270%</b>	<b>\$ (56,459)</b>



	FY 2017-2018				
	Current Month	Year to Date A	Approved Budget Amendments May 2018 - B	% Of Budget Year to Date	Budget Remaining
<b>Program Development (Unsecured Grants/Contract)</b>					
*Program Development (Unsecured	-	-	-		-
Clewiston Farmers Market	-	5,000	-	N/A	-
2018 Brownfields Symposium	-	9,651	-	N/A	-
<b>TOTAL PROGRAM DEVELOPMENT</b>	<b>\$ -</b>	<b>\$ 14,651</b>	<b>\$ -</b>	<b>N/A</b>	<b>\$ -</b>
<b>OTHER REVENUE SOURCES</b>					
ABM SPONSORSHIPS	-	-	-	N/A	-
CELA TEGA SPONSORSHIPS	-	-	-	N/A	-
Misc. Income	-	846	6,000	14%	5,154
INTEREST INCOME - Money Market	145	1,325	-	N/A	1,325
Fund A Investment Income	263	2,040	-	N/A	2,040
<b>TOTAL OTHER REVENUE SOURCES</b>	<b>\$ 408</b>	<b>\$ 4,211</b>	<b>\$ 6,000</b>	<b>70%</b>	<b>\$ 8,518</b>
<i>Fund Balance</i>	<i>\$ -</i>	<i>\$ -</i>	<i>\$ 811,779</i>		
<b>TOTAL REVENUES</b>	<b>\$ 87,014</b>	<b>\$ 881,422</b>	<b>\$ 1,851,720</b>		<b>\$ 147,875</b>
<b>EXPENSES</b>					
<b>PERSONNEL EXPENSES</b>					
SALARIES EXPENSE	\$ 37,410	\$ 386,210	\$ 503,603	77%	117,393
FICA EXPENSE	2,831	29,286	38,526	76%	9,240
RETIREMENT EXPENSE	4,290	38,735	52,278	74%	13,543
HEALTH INSURANCE EXPENSE	6,061	59,343	84,846	70%	25,503
WORKERS COMP. EXPENSE	-	1,815	3,687	49%	1,872
UNEMPLOYMENT COMP. EXPENSE	-	-	-	N/A	-
<b>TOTAL PERSONNEL EXPENSES</b>	<b>\$ 50,592</b>	<b>\$ 515,388</b>	<b>\$ 682,940</b>	<b>75%</b>	<b>167,552</b>
<b>OPERATIONAL EXPENSES</b>					
CONSULTANTS	\$ 6,088	\$ 72,727	\$ 58,598	124%	(14,129)
GRANT/CONSULTING EXPENSE	14,587	70,672	37,049	191%	(33,623)
AUDIT SERVICES EXPENSE	3,500	27,500	32,000	86%	4,500
TRAVEL EXPENSE	1,705	29,285	33,000	89%	3,715
TELEPHONE EXPENSE	315	3,381	4,600	74%	1,219
POSTAGE / SHIPPING EXPENSE	44	408	1,425	29%	1,017
EQUIPMENT RENTAL EXPENSE	1,245	5,488	6,695	82%	1,207
INSURANCE EXPENSE	1,366	10,749	12,026	89%	1,277
REPAIR/MAINT. EXPENSE	-	85	1,000	9%	915
PRINTING/REPRODUCTION EXPENSE	335	2,146	3,100	69%	954
UTILITIES (Elec, Internet)	3,798	17,556	24,900	71%	7,344

	FY 2017-2018				
	Current Month	Year to Date A	Approved Budget Amendments May 2018 - B	% Of Budget Year to Date	Budget Remaining
ADVERTISING/LEGAL NOTICES EXP	87	1,261	1,600	79%	339
OTHER MISC. EXPENSE	-	-	200	0%	200
BANK SERVICE CHARGES	-	-	-	N/A	N/A
OFFICE SUPPLIES EXPENSE	357	2,766	4,000	69%	1,234
COMPUTER RELATED EXPENSE	-	46,572	31,684	147%	(14,888)
DUES AND MEMBERSHIP	-	7,959	25,095	32%	17,136
PUBLICATION EXPENSE	-	-	100	0%	100
PROF. DEVELOP.	-	719	1,000	72%	281
MEETINGS/EVENTS EXPENSE	-	6,689	9,000	74%	2,311
CAPITAL OUTLAY - OPERATIONS	-	-	24,000	0%	24,000
LEASE LONG TERM	3,859	38,220	45,930	83%	7,710
UNCOLLECTABLE RECEIVABLES	-	-	-	N/A	N/A
FUND BALANCE			\$ 811,779		
<b>OPERATIONAL EXP.</b>	<b>\$ 37,287</b>	<b>\$ 344,184</b>	<b>\$ 1,168,781</b>	<b>29%</b>	<b>12,818</b>
ALLOCATION FOR FRINGE/INDIRECT (CAPTURED BY GRANTS)					
<b>TOTAL OPERATIONAL EXP.</b>			\$ 1,168,781		
<b>TOTAL CASH OUTLAY</b>	<b>\$ 87,878</b>	<b>\$ 859,572</b>	<b>\$ 1,851,721</b>		<b>\$ 180,370</b>
<b>NET INCOME (LOSS)</b>	<b>\$ (865)</b>	<b>\$ 21,848</b>			

SWFRPC  
Balance Sheet  
July 31, 2018

87 of 124

ASSETS

Current Assets		
Cash - Florida Prime	\$	139,822.16
Cash - FineMark Oper.		114,536.08
Cash - FineMark MM		488,181.18
Petty Cash		200.00
Accounts Receivable		153,488.66
		<hr/>
Total Current Assets		896,228.08
Property and Equipment		
Property, Furniture & Equip		237,172.31
Accumulated Depreciation		(197,201.57)
		<hr/>
Total Property and Equipment		39,970.74
Other Assets		
Amount t.b.p. for L.T.L.-Leave		40,634.44
FSA Deposit		2,881.29
Rental Deposits		3,500.00
Amt t.b.p. for L.T.Debt-OPEB		65,074.00
		<hr/>
Total Other Assets		112,089.73
		<hr/>
Total Assets	\$	<u><u>1,048,288.55</u></u>

LIABILITIES AND CAPITAL

Current Liabilities		
Accounts Payable	\$	113.28
Deferred NorthPoint NOPC_5328		662.23
Deferred Commons NOPC_5337		1,500.00
Deferred Pine Air NOPC_5343		1,437.12
Deferred Palmer Ranch 28_5349		24,896.73
FICA Taxes Payable		209.82
Federal W/H Tax Payable		24.96
United way Payable		242.00
Deferred Compensation Payable		(300.00)
FSA Payable		(708.43)
LEPC Contingency Fund		305.25
		<hr/>
Total Current Liabilities		28,382.96
Long-Term Liabilities		
Accrued Annual Leave		40,634.44
Long Term Debt - OPEB		65,074.00
		<hr/>
Total Long-Term Liabilities		105,708.44
		<hr/>
Total Liabilities		134,091.40
Capital		
Fund Balance-Unassigned		338,378.04
Fund Balance-Assigned		514,000.00
FB-Non-Spendable/Fixed Assets		39,970.74
Net Income		21,848.37
		<hr/>
Total Capital		914,197.15
		<hr/>
Total Liabilities & Capital	\$	<u><u>1,048,288.55</u></u>

Unaudited - For Management Purposes Only

# 2017 - 2018 Workplan & Budget Financial Snapshot Jun-18

## Revenues

Local Assessments  
Total Federal/State Grants  
Misc. Grants/Contracts  
Other Revenue Sources

Monthly Revenues

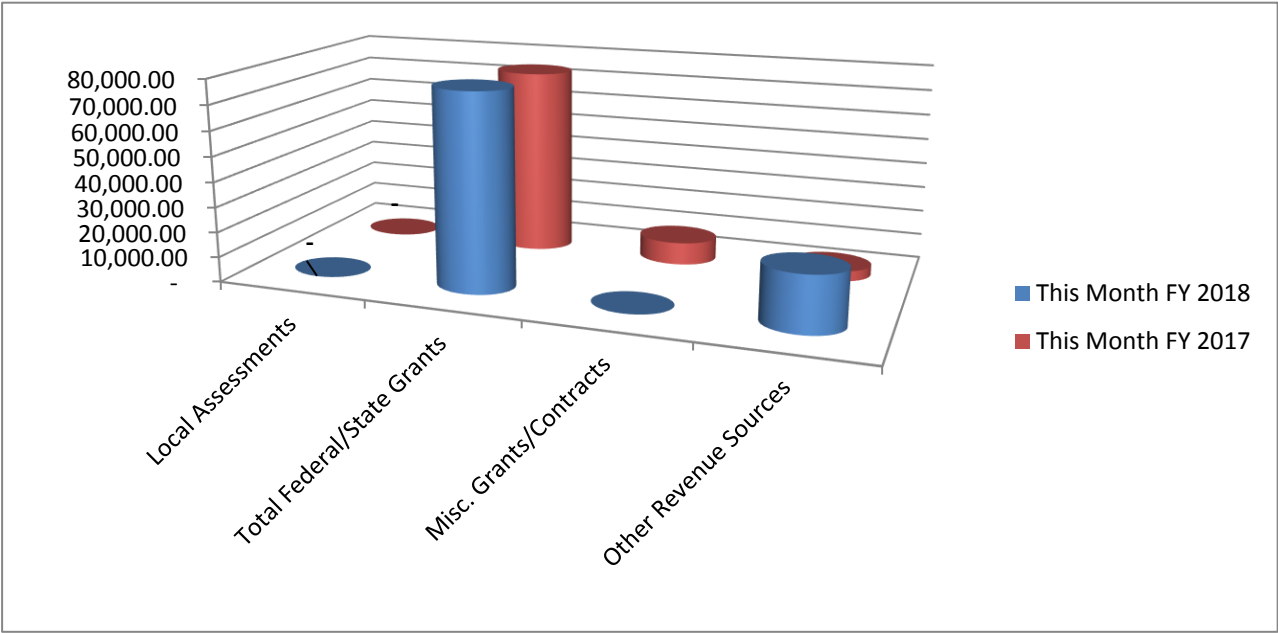

Notes: Local Assessments billed at the beginning of each quarter: October, January, April and July  
State/Federal Grants billed quarterly: LEPC, HMEP, TD, and EPA  
Federal Grants billed Semi Annually: Economic Development  
Misc. Grants/Contracts billed by deliverable: SQG, Interagency PO'S  
Other(DRI) billed /recorded monthly as cost reimbursement

Monthly Net Income

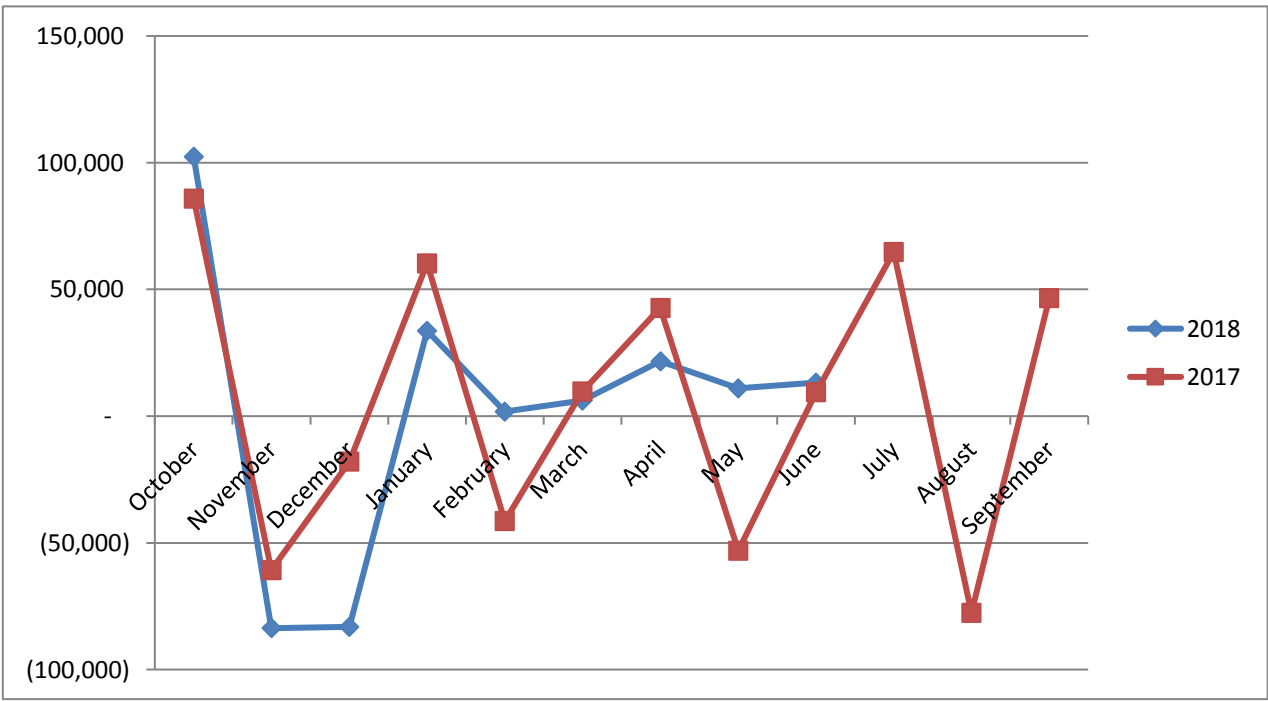

YTD: Net Income \$22,713 Unaudited

# SWFRPC

## Detail of Reserve

### As of JUNE 30, 2018

***Cash and Cash Equivalents:***

Petty Cash	\$	200
FineMark Operating Funds		84,782
2016 Fiscal Year Carryover		22,258
		<hr/>
<b><i>Total Cash and Cash Equivalents</i></b>	<b>\$</b>	<b>107,240</b>

***Investments:***

FineMark Money Market	\$	488,036
Local government Surplus Trust Fund Investment Pool (Fund A)		139,559
		<hr/>
<b><i>Total Investments</i></b>	<b>\$</b>	<b>627,595</b>

Total Reserves	<hr/>	<hr/>
	<b>\$</b>	<b>734,835</b>
		<hr/> <hr/>

**SWFRPC INCOME STATEMENT  
COMPARED WITH BUDGET**

90 of 124

**FOR THE ONE MONTH ENDING JUNE 30, 2018**

		FY 2017-2018			
	Current Month	Year to Date A	Approved Budget Amendments May 2018 - B	% Of Budget Year to Date	Budget Remaining
<b>REVENUES</b>					
<b>LOCAL ASSESSMENTS</b>					
CHARLOTTE COUNTY	\$	-	\$ 38,351	\$ 38,351	100% \$ -
COLLIER COUNTY		-	78,795	105,061	75% \$ 26,266
GLADES COUNTY		-	2,937	3,914	75% \$ 977
HENDRY COUNTY		-	8,634	11,511	75% \$ 2,877
LEE COUNTY		-	83,858	83,858	100% \$ -
CITY OF CAPE CORAL		-	30,771	51,142	60% \$ 20,371
CITY OF FORT MYERS		-	17,124	22,832	75% \$ 5,708
TOWN OF FORT MYERS BEACH INC		-	1,413	1,883	75% \$ 470
BONITA SPRINGS		-	10,887	14,516	75% \$ 3,629
CITY OF SANIBEL		-	1,482	1,977	75% \$ 495
SARASOTA COUNTY		-	29,965	29,965	100% -
<b>TOTAL LOCAL ASSESSMENTS</b>	<b>\$</b>	<b>-</b>	<b>\$ 304,217</b>	<b>\$ 365,010</b>	<b>83% \$ 60,793</b>
<b>FEDERAL / STATE GRANTS</b>					
DEM - LEPC 17/18		-	37,093	80,000	46% 42,907
DEM - HMEP 16/17		-	23,680	23,871	99% 191
DEM - HMEP 17/18		-	28,239	60,349	
TD Glades/Hendry 17/18	17,169		29,148	18,367	159% (10,781)
DEM - Collier Hazard Analysis 17/18	11,464		20,844	20,844	100% -
Wetland Mitigation Strategy - EPA	27,500		82,500	110,000	75% 27,500
Promise Zone	-		1,476	-	N/A (1,476)
DEO Agricultural Sustainability	-		30,000	30,000	100% -
Disaster Recovery Coordinator	21,978		21,978	100,000	22% 78,022
National Community Service	-		-	30,000	0% 30,000
Economic Development Planning 17/19	-		37,316	70,000	53% 32,684
<b>TOTAL FEDERAL / STATE GRANTS</b>	<b>\$ 78,111</b>	<b>\$ 312,275</b>	<b>\$ 543,431</b>	<b>57%</b>	<b>\$ 155,948</b>
<b>MISC. GRANTS / CONTRACTS/CONTRACTUAL</b>					
GLADES SQG	-	-	4,500	0%	4,500
Bonita Springs Flooding	-	50,000	50,000	100%	-
Bonita Springs Affordable Housing	-	15,000	30,000	50%	15,000
HERO	-	-	6,000	0%	6,000
<b>TOTAL MISC. GRANTS/CONTRACTS</b>	<b>\$ -</b>	<b>\$ 65,000</b>	<b>\$ 90,500</b>	<b>72%</b>	<b>\$ 25,500</b>
<b>DRIS/NOPCS/MONITORING</b>					
DRI MONITORING FEES	-	\$ 1,500	\$ -		\$ 1,500
DRIS/NOPCS INCOME	20,352	92,959	35,000	266%	(57,959)
<b>TOTAL</b>	<b>\$ 20,352</b>	<b>\$ 94,459</b>	<b>\$ 35,000</b>	<b>270%</b>	<b>\$ (56,459)</b>

	FY 2017-2018				
	Current Month	Year to Date A	Approved Budget Amendments May 2018 - B	% Of Budget Year to Date	Budget Remaining
<b>Program Development (Unsecured Grants/Contract)</b>					
*Program Development (Unsecured	-	-	-		-
Clewiston Farmers Market	-	5,000	-	N/A	-
2018 Brownfields Symposium	1,620	9,651	-	N/A	-
<b>TOTAL PROGRAM DEVELOPMENT</b>	<b>\$ 1,620</b>	<b>\$ 14,651</b>	<b>\$ -</b>	<b>N/A</b>	<b>\$ -</b>
<b>OTHER REVENUE SOURCES</b>					
ABM SPONSORSHIPS	-	-	-	N/A	-
CELA TEGA SPONSORSHIPS	-	-	-	N/A	-
Misc. Income	-	846	6,000	14%	5,154
INTEREST INCOME - Money Market	133	1,179	-	N/A	1,179
Fund A Investment Income	242	1,777	-	N/A	1,777
<b>TOTAL OTHER REVENUE SOURCES</b>	<b>\$ 375</b>	<b>\$ 3,803</b>	<b>\$ 6,000</b>	<b>63%</b>	<b>\$ 8,110</b>
<i>Fund Balance</i>	<i>\$ -</i>	<i>\$ -</i>	<i>\$ 811,779</i>		
<b>TOTAL REVENUES</b>	<b>\$ 100,458</b>	<b>\$ 794,407</b>	<b>\$ 1,851,720</b>		<b>\$ 193,892</b>
<b>EXPENSES</b>					
<b>PERSONNEL EXPENSES</b>					
SALARIES EXPENSE	\$ 37,179	\$ 348,800	\$ 503,603	69%	154,803
FICA EXPENSE	2,813	26,455	38,526	69%	12,071
RETIREMENT EXPENSE	6,090	34,445	52,278	66%	17,833
HEALTH INSURANCE EXPENSE	6,417	53,281	84,846	63%	31,565
WORKERS COMP. EXPENSE	121	1,815	3,687	49%	1,872
UNEMPLOYMENT COMP. EXPENSE	-	-	-	N/A	-
<b>TOTAL PERSONNEL EXPENSES</b>	<b>\$ 52,620</b>	<b>\$ 464,797</b>	<b>\$ 682,940</b>	<b>68%</b>	<b>218,143</b>
<b>OPERATIONAL EXPENSES</b>					
CONSULTANTS	\$ 6,788	\$ 66,639	\$ 58,598	114%	(8,041)
GRANT/CONSULTING EXPENSE	9,075	56,085	37,049	151%	(19,036)
AUDIT SERVICES EXPENSE	5,000	24,000	32,000	75%	8,000
TRAVEL EXPENSE	1,149	27,580	33,000	84%	5,420
TELEPHONE EXPENSE	269	3,066	4,600	67%	1,534
POSTAGE / SHIPPING EXPENSE	44	364	1,425	26%	1,061
EQUIPMENT RENTAL EXPENSE	25	4,243	6,695	63%	2,452
INSURANCE EXPENSE	423	9,383	12,026	78%	2,643
REPAIR/MAINT. EXPENSE	-	85	1,000	9%	915
PRINTING/REPRODUCTION EXPENSE	-	1,810	3,100	58%	1,290
UTILITIES (Elec, Internet)	1,560	13,758	24,900	55%	11,142

	FY 2017-2018				
	Current Month	Year to Date A	Approved Budget Amendments May 2018 - B	% Of Budget Year to Date	Budget Remaining
ADVERTISING/LEGAL NOTICES EXP	150	1,174	1,600	73%	426
OTHER MISC. EXPENSE	-	-	200	0%	200
BANK SERVICE CHARGES	-	-	-	N/A	N/A
OFFICE SUPPLIES EXPENSE	398	2,410	4,000	60%	1,590
COMPUTER RELATED EXPENSE	4,675	46,572	31,684	147%	(14,888)
DUES AND MEMBERSHIP	1,035	7,959	25,095	32%	17,136
PUBLICATION EXPENSE	-	-	100	0%	100
PROF. DEVELOP.	-	719	1,000	72%	281
MEETINGS/EVENTS EXPENSE	136	6,689	9,000	74%	2,311
CAPITAL OUTLAY - OPERATIONS	-	-	24,000	0%	24,000
LEASE LONG TERM	3,859	34,361	45,930	75%	11,569
UNCOLLECTABLE RECEIVABLES	-	-	-	N/A	N/A
FUND BALANCE			\$ 811,779		
<b>OPERATIONAL EXP.</b>	<b>\$ 34,586</b>	<b>\$ 306,897</b>	<b>\$ 1,168,781</b>	<b>26%</b>	<b>50,105</b>
ALLOCATION FOR FRINGE/INDIRECT (CAPTURED BY GRANTS)					
<b>TOTAL OPERATIONAL EXP.</b>			<b>\$ 1,168,781</b>		
<b>TOTAL CASH OUTLAY</b>	<b>\$ 87,206</b>	<b>\$ 771,694</b>	<b>\$ 1,851,721</b>		<b>\$ 268,248</b>
<b>NET INCOME (LOSS)</b>	<b>\$ 13,252</b>	<b>\$ 22,713</b>			



SWFRPC  
Balance Sheet  
June 30, 2018

93 of 124

ASSETS

Current Assets		
Cash - Florida Prime	\$	139,559.22
Cash - FineMark Oper.		84,781.78
Cash - FineMark MM		488,036.08
Petty Cash		200.00
Accounts Receivable		187,136.35
		<hr/>
Total Current Assets		899,713.43
Property and Equipment		
Property, Furniture & Equip		237,172.31
Accumulated Depreciation		(197,201.57)
		<hr/>
Total Property and Equipment		39,970.74
Other Assets		
Amount t.b.p. for L.T.L.-Leave		40,634.44
FSA Deposit		2,881.29
Rental Deposits		3,500.00
Amt t.b.p. for L.T.Debt-OPEB		65,074.00
		<hr/>
Total Other Assets		112,089.73
		<hr/>
Total Assets	\$	1,051,773.90
		<hr/> <hr/>

LIABILITIES AND CAPITAL

Current Liabilities		
Accounts Payable	\$	113.28
Deferred NorthPoint NOPC_5328		662.23
Deferred Commons NOPC_5337		1,500.00
Deferred Pine Air NOPC_5343		1,437.12
Deferred Palmer Ranch 28_5349		24,896.73
FICA Taxes Payable		1,625.40
Federal W/H Tax Payable		1,017.98
United way Payable		154.00
FSA Payable		(708.43)
LEPC Contingency Fund		305.25
		<hr/>
Total Current Liabilities		31,003.56
Long-Term Liabilities		
Accrued Annual Leave		40,634.44
Long Term Debt - OPEB		65,074.00
		<hr/>
Total Long-Term Liabilities		105,708.44
		<hr/>
Total Liabilities		136,712.00
Capital		
Fund Balance-Unassigned		338,378.04
Fund Balance-Assigned		514,000.00
FB-Non-Spendable/Fixed Assets		39,970.74
Net Income		22,713.12
		<hr/>
Total Capital		915,061.90
		<hr/>
Total Liabilities & Capital	\$	1,051,773.90
		<hr/> <hr/>

Unaudited - For Management Purposes Only

## 2017 - 2018 Workplan & Budget Financial Snapshot May-18

### Revenues

Local Assessments  
Total Federal/State Grants  
Misc. Grants/Contracts  
Other Revenue Sources

**Monthly Revenues**

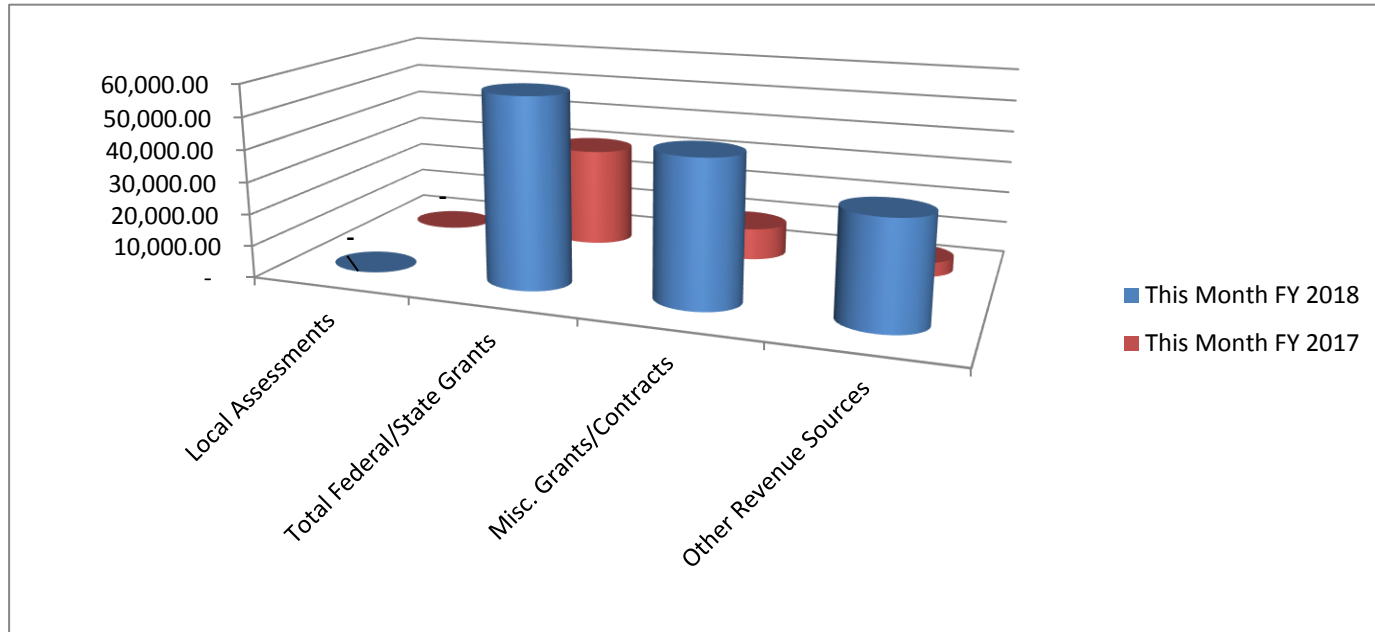

Notes: Local Assessments billed at the beginning of each quarter: October, January, April and July  
State/Federal Grants billed quarterly: LEPC, HMEP, TD, and EPA  
Federal Grants billed Semi Annually: Economic Development  
Misc. Grants/Contracts billed by deliverable: SQG, Interagency PO'S  
Other(DRI) billed /recorded monthly as cost reimbursement

**Monthly Net Income**

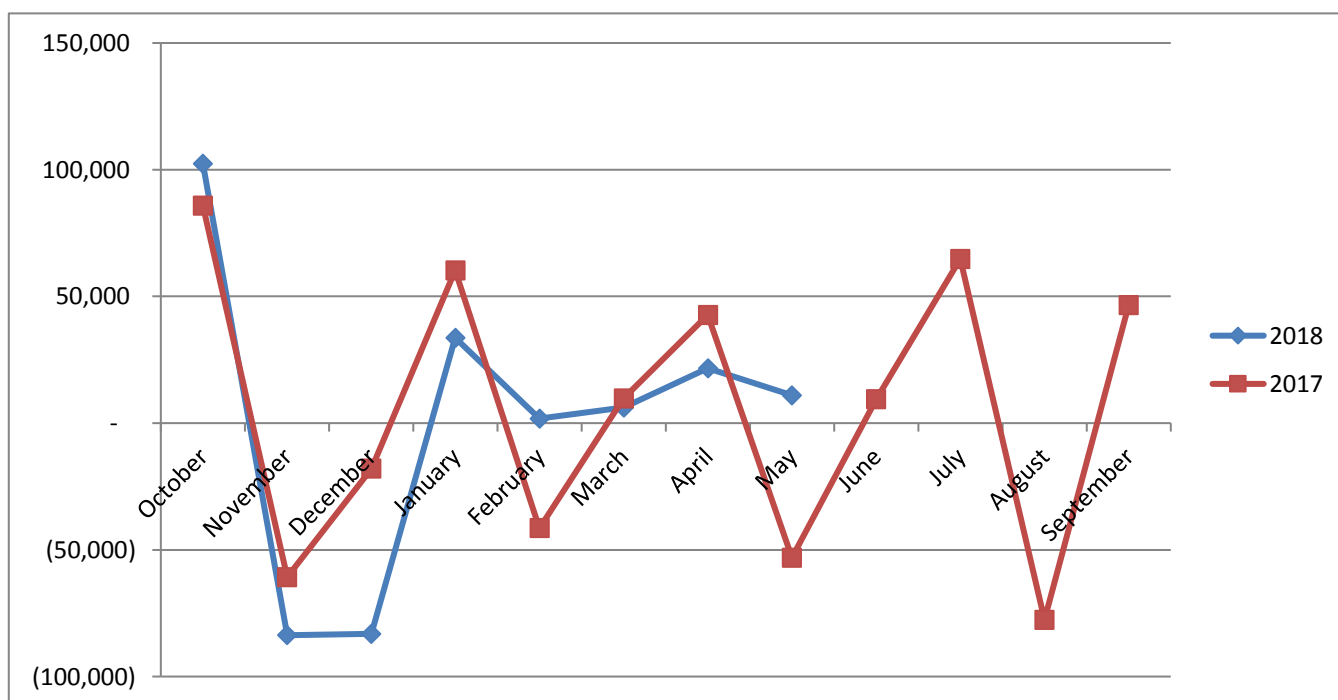

**YTD: Net Income \$9,462 Unaudited**

# SWFRPC

## Detail of Reserve

### As of MAY 31, 2018

***Cash and Cash Equivalents:***

Petty Cash	\$ 200
FineMark Operating Funds	80,095
2016 Fiscal Year Carryover	<u>22,258</u>
<b><i>Total Cash and Cash Equivalents</i></b>	<b>\$ 102,553</b>

***Investments:***

FineMark Money Market	\$ 487,903
Local government Surplus Trust Fund Investment Pool (Fund A)	<u>139,317</u>
<b><i>Total Investments</i></b>	<b>\$ 627,220</b>

Total Reserves	<u><u>\$ 729,774</u></u>
----------------	--------------------------

**SWFRPC INCOME STATEMENT  
COMPARED WITH BUDGET**

96 of 124

**FOR THE ONE MONTH ENDING MAY 31, 2018**

		FY 2017-2018			
	Current Month	Year to Date A	Approved Budget Amendments May 2018 - B	% Of Budget Year to Date	Budget Remaining
<b>REVENUES</b>					
<b>LOCAL ASSESSMENTS</b>					
CHARLOTTE COUNTY	\$ -	\$ 38,351	\$ 38,351	100%	\$ -
COLLIER COUNTY	-	78,795	105,061	75%	\$ 26,266
GLADES COUNTY	-	2,937	3,914	75%	\$ 977
HENDRY COUNTY	-	8,634	11,511	75%	\$ 2,877
LEE COUNTY	-	83,858	83,858	100%	\$ -
CITY OF CAPE CORAL	-	30,771	51,142	60%	\$ 20,371
CITY OF FORT MYERS	-	17,124	22,832	75%	\$ 5,708
TOWN OF FORT MYERS BEACH INC	-	1,413	1,883	75%	\$ 470
BONITA SPRINGS	-	10,887	14,516	75%	\$ 3,629
CITY OF SANIBEL	-	1,482	1,977	75%	\$ 495
SARASOTA COUNTY	-	29,965	29,965	100%	-
<b>TOTAL LOCAL ASSESSMENTS</b>	<b>\$ -</b>	<b>\$ 304,217</b>	<b>\$ 365,010</b>	<b>83%</b>	<b>\$ 60,793</b>
<b>FEDERAL / STATE GRANTS</b>					
DEM - LEPC 17/18	16,097	37,093	80,000	46%	42,907
DEM - HMEP 16/17	-	23,680	23,871	99%	191
DEM - HMEP 17/18	28,239	28,239	60,349		
TD Glades/Hendry 17/18	4,392	11,979	18,367	65%	6,388
DEM - Collier Hazard Analysis 17/18		9,380	20,844	45%	11,464
Wetland Mitigation Strategy - EPA		55,000	110,000	50%	55,000
Promise Zone		1,476	-	N/A	(1,476)
DEO Agricultural Sustainability	10,000	30,000	30,000	100%	-
Disaster Recovery Coordinator		-	100,000	0%	100,000
National Community Service		-	30,000	0%	30,000
Economic Development Planning 17/19		37,316	70,000	53%	32,684
<b>TOTAL FEDERAL / STATE GRANTS</b>	<b>\$ 58,729</b>	<b>\$ 234,164</b>	<b>\$ 543,431</b>	<b>43%</b>	<b>\$ 234,059</b>
<b>MISC. GRANTS / CONTRACTS/CONTRACTUAL</b>					
GLADES SQG	-	-	4,500	0%	4,500
Bonita Springs Flooding	30,000	50,000	50,000	100%	-
Bonita Springs Affordable Housing	15,000	15,000	30,000	50%	15,000
HERO	-	-	6,000	0%	6,000
<b>TOTAL MISC. GRANTS/CONTRACTS</b>	<b>\$ 45,000</b>	<b>\$ 65,000</b>	<b>\$ 90,500</b>	<b>72%</b>	<b>\$ 25,500</b>
<b>DRIS/NOPCS/MONITORING</b>					
DRI MONITORING FEES	-	\$ 1,500	\$ -		\$ 1,500
DRIS/NOPCS INCOME	19,588	72,607	35,000	207%	(37,607)
<b>TOTAL</b>	<b>\$ 19,588</b>	<b>\$ 74,107</b>	<b>\$ 35,000</b>	<b>212%</b>	<b>\$ (36,107)</b>

	FY 2017-2018				
	Current Month	Year to Date A	Approved Budget Amendments May 2018 - B	% Of Budget Year to Date	Budget Remaining
<b>Program Development (Unsecured Grants/Contract)</b>					
*Program Development (Unsecured	-	-	-	-	-
Clewiston Farmers Market	5,000	5,000	-	N/A	-
2018 Brownfields Symposium	8,031	8,031	-	N/A	-
<b>TOTAL PROGRAM DEVELOPMENT</b>	<b>\$ 13,031</b>	<b>\$ 13,031</b>	<b>\$ -</b>	<b>N/A</b>	<b>\$ -</b>
<b>OTHER REVENUE SOURCES</b>					
ABM SPONSORSHIPS	-	-	-	N/A	-
CELA TEGA SPONSORSHIPS	-	-	-	N/A	-
Misc. Income	-	846	6,000	14%	5,154
INTEREST INCOME - Money Market	129	1,046	-	N/A	1,046
Fund A Investment Income	240	1,535	-	N/A	1,535
<b>TOTAL OTHER REVENUE SOURCES</b>	<b>\$ 369</b>	<b>\$ 3,428</b>	<b>\$ 6,000</b>	<b>57%</b>	<b>\$ 7,735</b>
<i>Fund Balance</i>	<i>\$ -</i>	<i>\$ -</i>	<i>\$ 811,779</i>		
<b>TOTAL REVENUES</b>	<b>\$ 136,717</b>	<b>\$ 693,949</b>	<b>\$ 1,851,720</b>		<b>\$ 291,980</b>
<b>EXPENSES</b>					
<b>PERSONNEL EXPENSES</b>					
SALARIES EXPENSE	\$ 50,511	\$ 311,622	\$ 503,603	62%	191,981
FICA EXPENSE	3,826	23,641	38,526	61%	14,885
RETIREMENT EXPENSE	4,174	28,355	52,278	54%	23,923
HEALTH INSURANCE EXPENSE	7,192	46,865	84,846	55%	37,981
WORKERS COMP. EXPENSE	-	1,694	3,687	46%	1,993
UNEMPLOYMENT COMP. EXPENSE	-	-	-	N/A	-
<b>TOTAL PERSONNEL EXPENSES</b>	<b>\$ 65,702</b>	<b>\$ 412,176</b>	<b>\$ 682,940</b>	<b>60%</b>	<b>270,764</b>
<b>OPERATIONAL EXPENSES</b>					
CONSULTANTS	\$ 10,288	\$ 59,852	\$ 58,598	102%	(1,254)
GRANT/CONSULTING EXPENSE	8,435	47,010	37,049	127%	(9,961)
AUDIT SERVICES EXPENSE	18,000	19,000	32,000	59%	13,000
TRAVEL EXPENSE	643	26,431	33,000	80%	6,569
TELEPHONE EXPENSE	333	2,797	4,600	61%	1,803
POSTAGE / SHIPPING EXPENSE	44	319	1,425	22%	1,106
EQUIPMENT RENTAL EXPENSE	886	4,218	6,695	63%	2,477
INSURANCE EXPENSE	273	8,960	12,026	75%	3,066
REPAIR/MAINT. EXPENSE	-	85	1,000	9%	915
PRINTING/REPRODUCTION EXPENSE	192	1,810	3,100	58%	1,290
UTILITIES (Elec, Internet)	1,554	12,199	24,900	49%	12,701

	FY 2017-2018				
	Current Month	Year to Date A	Approved Budget Amendments May 2018 - B	% Of Budget Year to Date	Budget Remaining
ADVERTISING/LEGAL NOTICES EXP	-	1,023	1,600	64%	577
OTHER MISC. EXPENSE	-	-	200	0%	200
BANK SERVICE CHARGES	-	-	-	N/A	N/A
OFFICE SUPPLIES EXPENSE	148	2,012	4,000	50%	1,988
COMPUTER RELATED EXPENSE	15,385	41,897	31,684	132%	(10,213)
DUES AND MEMBERSHIP	-	6,924	25,095	28%	18,171
PUBLICATION EXPENSE	-	-	100	0%	100
PROF. DEVELOP.	-	719	1,000	72%	281
MEETINGS/EVENTS EXPENSE	24	6,552	9,000	73%	2,448
CAPITAL OUTLAY - OPERATIONS	-	-	24,000	0%	24,000
LEASE LONG TERM	3,859	30,503	45,930	66%	15,428
UNCOLLECTABLE RECEIVABLES	-	-	-	N/A	N/A
FUND BALANCE			\$ 811,779		
<b>OPERATIONAL EXP.</b>	<b>\$ 60,063</b>	<b>\$ 272,311</b>	<b>\$ 1,168,781</b>	<b>23%</b>	<b>84,691</b>
ALLOCATION FOR FRINGE/INDIRECT (CAPTURED BY GRANTS)					
<b>TOTAL OPERATIONAL EXP.</b>			<b>\$ 1,168,781</b>		
<b>TOTAL CASH OUTLAY</b>	<b>\$ 125,765</b>	<b>\$ 684,487</b>	<b>\$ 1,851,721</b>		<b>\$ 355,455</b>
<b>NET INCOME (LOSS)</b>	<b>\$ 10,952</b>	<b>\$ 9,462</b>			

SWFRPC  
Balance Sheet  
May 31, 2018

99 of 124

ASSETS

Current Assets		
Cash - Florida Prime	\$	139,317.33
Cash - FineMark Oper.		80,095.31
Cash - FineMark MM		487,903.06
Petty Cash		200.00
Accounts Receivable		205,285.44
		<hr/>
Total Current Assets		912,801.14
Property and Equipment		
Property, Furniture & Equip		237,172.31
Accumulated Depreciation		(197,201.57)
		<hr/>
Total Property and Equipment		39,970.74
Other Assets		
Amount t.b.p. for L.T.L.-Leave		40,634.44
FSA Deposit		2,881.29
Rental Deposits		3,500.00
Amt t.b.p. for L.T.Debt-OPEB		65,074.00
		<hr/>
Total Other Assets		112,089.73
		<hr/>
Total Assets	\$	1,064,861.61
		<hr/> <hr/>

LIABILITIES AND CAPITAL

Current Liabilities		
Accounts Payable	\$	113.28
Deferred NorthPoint NOPC_5328		662.23
Deferred Commons NOPC_5337		1,500.00
Deferred Pine Air NOPC_5343		1,437.12
Deferred PR XXVII DRI_5344		6,011.03
Deferred PR XXVI DRI_5345		6,762.21
Deferred Deep Lagoon NOPC_5346		1,842.78
Deferred Fiddlers NOPC_5347		1,235.87
Deferred Palmer Ranch 28_5349		24,896.73
Deferred Murdock Center_5351		1,500.00
Deferred BRC NOPC Incr 1_5354		3,000.00
FICA Taxes Payable		4,853.72
Federal W/H Tax Payable		3,265.26
United way Payable		66.00
Deferred Compensation Payable		600.00
FSA Payable		(708.43)
LEPC Contingency Fund		305.25
		<hr/>
Total Current Liabilities		57,343.05
Long-Term Liabilities		
Accrued Annual Leave		40,634.44
Long Term Debt - OPEB		65,074.00
		<hr/>
Total Long-Term Liabilities		105,708.44
		<hr/>
Total Liabilities		163,051.49
Capital		
Fund Balance-Unassigned		338,378.04
Fund Balance-Assigned		514,000.00

Unaudited - For Management Purposes Only

SWFRPC  
Balance Sheet  
May 31, 2018

100 of 124

FB-Non-Spendable/Fixed Assets	39,970.74	
Net Income	<u>9,461.34</u>	
Total Capital		<u>901,810.12</u>
Total Liabilities & Capital	\$	<u><u>1,064,861.61</u></u>



# Agenda Item

10c

Promise Zone Update

10c

10c

# Agenda Item

10d

Disaster Recovery  
Coordinator Update

10d

10d

# Agenda Item

10e

Biosolids Resolution

10e

10e

## RESOLUTION #2018-03

**A RESOLUTION OF THE SOUTHWEST FLORIDA REGIONAL PLANNING COUNCIL SUPPORTING COLLABORATION WITH THE FLORIDA REGIONAL COUNCILS ASSOCIATION, FLORIDA ASSOCIATION OF COUNTIES, FLORIDA LEAGUE OF CITIES, FLORIDA SMALL COUNTY COALITION, FLORIDA DEPARTMENT OF ENVIRONMENTAL PROTECTION, FLORIDA DEPARTMENT OF AGRICULTURE AND CONSUMER SERVICES, AND OTHER PARTNERS TO INCREASE AWARENESS OF BIOSOLIDS MANAGEMENT ISSUES IN FLORIDA, PRIORITIZE THE REDUCTION AND EVENTUAL ELIMINATION OF THE LAND APPLICATION OF HUMAN WASTEWATER BIOSOLIDS, AND ESTABLISH A PILOT PROJECTS PROGRAM FOR FUNDING NEW STATE OF THE ART WASTEWATER TECHNOLOGIES TO IMPROVE RECOVERY AND AFFORD MORE EFFICIENT USE OF HUMAN WASTEWATER BIOSOLIDS**

**WHEREAS**, the Southwest Florida Regional Planning Council's (SWFRPC) geographical area is comprised of Charlotte, Collier, Glades, Hendry, Lee and Sarasota counties and the municipalities contained therein; and

**WHEREAS**, the SWFRPC is a multi-purpose regional governmental entity with policy responsibility in the areas of affordable housing, economic development, emergency preparedness, energy, regional health, natural resources and regional transportation, and

**WHEREAS**, it is time to work together as a region and state to increase awareness of current and future biosolids management issues, examine potential water quality impacts from our current practices, and explore new wastewater treatment technologies to improve biosolids resource recovery and management options; and

**WHEREAS**, the SWFRPC wishes to collaborate with Florida Regional Councils Association, Florida Association of Counties, Florida League of Cities, Florida Small County Coalition, Florida Department of Environmental Protection, Florida Department of Agriculture and Consumer Services, and other partners to accomplish these objectives and rethink 21<sup>st</sup> Century human wastewater management practices for Florida.

**NOW, THEREFORE, BE IT RESOLVED THE SOUTHWEST FLORIDA REGIONAL PLANNING COUNCIL ENCOURAGES THAT:**

1. The State of Florida and its local governments prioritize the reduction and eventual elimination of the land application of human wastewater biosolids; and
2. The State of Florida establish a Pilot Projects Program for funding local utilities to implement new state of the art wastewater treatment technologies to improve recovery and afford more efficient use of human wastewater biosolids resources.

**DULY ADOPTED** by the Southwest Florida Regional Planning Council this \_\_\_\_ day of September, 2018.

---

Thomas Perry  
Chair

---

Margaret Wuerstle  
Executive Director

**RESOLUTION #18-03**

**A RESOLUTION OF THE TREASURE COAST REGIONAL PLANNING COUNCIL SUPPORTING COLLABORATION WITH THE FLORIDA REGIONAL COUNCILS ASSOCIATION, FLORIDA ASSOCIATION OF COUNTIES, FLORIDA LEAGUE OF CITIES, FLORIDA SMALL COUNTY COALITION, FLORIDA DEPARTMENT OF ENVIRONMENTAL PROTECTION, FLORIDA DEPARTMENT OF AGRICULTURE AND CONSUMER SERVICES, AND OTHER PARTNERS TO INCREASE AWARENESS OF BIOSOLIDS MANAGEMENT ISSUES IN FLORIDA, PRIORITIZE THE REDUCTION AND EVENTUAL ELIMINATION OF THE LAND APPLICATION OF HUMAN WASTEWATER BIOSOLIDS, AND ESTABLISH A PILOT PROJECTS PROGRAM FOR FUNDING NEW STATE OF THE ART WASTEWATER TECHNOLOGIES TO IMPROVE RECOVERY AND AFFORD MORE EFFICIENT USE OF HUMAN WASTEWATER BIOSOLIDS**

**WHEREAS**, the Treasure Coast Regional Planning Council's (TCRPC) geographical area is comprised of Indian River, Martin, St. Lucie, and Palm Beach counties and the 52 Municipalities contained therein; and

**WHEREAS**, the TCRPC is a multi-purpose regional governmental entity with policy responsibility in the areas of affordable housing, economic development, emergency preparedness, energy, regional health, natural resources and regional transportation, and

**WHEREAS**, it is time to work together as a region and state to increase awareness of current and future biosolids management issues, examine potential water quality impacts from our current practices, and explore new wastewater treatment technologies to improve biosolids resource recovery and management options; and

**WHEREAS**, the TCRPC wishes to collaborate with Florida Regional Councils Association, Florida Association of Counties, Florida League of Cities, Florida Small County Coalition, Florida Department of Environmental Protection, Florida Department of Agriculture and Consumer Services, and other partners to accomplish these objectives and rethink 21<sup>st</sup> Century human wastewater management practices for Florida.

**NOW, THEREFORE, BE IT RESOLVED THE TREASURE COAST REGIONAL PLANNING COUNCIL ENCOURAGES THAT:**

1. The State of Florida and its local governments prioritize the reduction and eventual elimination of the land application of human wastewater biosolids; and
2. The State of Florida establish a Pilot Projects Program for funding local utilities to implement new state of the art wastewater treatment technologies to improve recovery and afford more efficient use of human wastewater biosolids resources.

**DULY ADOPTED** by the Treasure Coast Regional Planning Council this 20th of July, 2018.

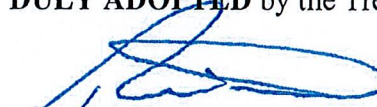
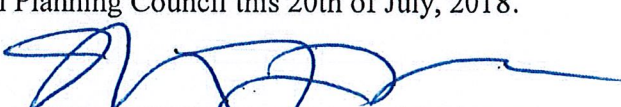
  
\_\_\_\_\_  
Reece J. Parrish  
Chair  
\_\_\_\_\_  
Michael J. Busha  
Executive Director

## **Prioritize Consideration of Alternatives to the Land Application of Treated Human Waste From Central Sewer Wastewater Biosolids**

**PROBLEM:** Excess nutrients from land application of human waste from wastewater treatment effluent termed “biosolids”, reach surface waters as a result of rainfall runoff and continues to increase the occurrence of chronic harmful algal blooms (HABs).

**BACKGROUND:** Today Florida’s central sewer wastewater treatment facilities produce approximately 340,000 dry tons of biosolids. Approximately 100,000 dry tons of biosolids qualify as Class B biosolids which are treated sewage sludge meeting U.S. EPA guidelines for land application as fertilizer with restrictions and are allowed to have detectable levels of pathogens. Another 100,000 dry tons of biosolids are deposited in various landfills throughout the state. The final 140,000 dry tons of biosolids are further processed, dried, and composted with material from the landscape industry to produce approximately 200,000 tons of Class AA biosolids, which can then be distributed and marketed as fertilizer. This class of biosolid is completely unregulated and land-applied mainly on pasture and to a lesser extent citrus. However, citrus fertilized with human biosolids seldom qualify for overseas export.

Bahia grass pastures in Florida can generally produce satisfactorily without total Phosphorous (TP) fertilization, and every crop in Florida can be grown economically without the use of biosolids as a fertilizer. Biosolids provide an inefficient form of fertilization that provides only a fraction (less than 40%) of plant available nitrogen that can result in both total Nitrogen (TN) and TP over fertilization, which may negatively affect surface and other coastal waters. Of additional concern are compounds found in human wastewater biosolids which may include: hormones; steroids; bacteria; viruses; polychlorinated biphenyls (PCBs); pharmaceuticals; antibodies; polybrominated diphenyl ethers (PBDE fire retardants); polyfluoroalkyl substances (PFAS) like Teflon, polishes, waxes, paints, and household cleaning products; organics; metals; and artificial sweeteners. Although these materials are applied in a manner that may not be harmful to humans according to EPA “guidelines,” their accumulated secondary impacts are not entirely known.

Both Class B biosolids and Class AA biosolid fertilizers contain approximately 5.5 % TN and 2.2% TP. Therefore, land application of 300,000 dry tons of Class AA and Class B biosolids deposits over 33 million pounds of TN and 13.2 million pounds of TP on agricultural lands each year. Peer reviewed studies, such as those related to the Lake Okeechobee drainage basins, estimate that +/- 12% of both TN and TP imports will find their way to surface waters. This basin currently receives over 1,000 dry tons of TP from Class AA biosolids which, could amount to 120 dry tons or 240,000 pounds of TP to surface waters. Large areas within Florida such as the basins draining into Lake Okeechobee already exhibit enough legacy phosphorus to last for the next 25 to 60 years. While the practice of land-applying Class B biosolids was recently banned in the Lake Okeechobee, Caloosahatchee, St. Lucie River and Everglades watersheds, the St. Johns River Upper Basin in 2016 received nearly 74,000 tons of Class B biosolids, or approximately 74% of the Class B produced in Florida, in its watershed.

**SOLUTION:** Agricultural crops can be grown profitably without land applying this inefficient nutrient source. There are alternative technologies that should be considered such as: pyrolysis; vapor recompression distillation; boiler technology electric generation; and supercritical water oxidation to improve recovery of resources and sustainable management of biosolids.

**RECOMMENDATION:** Prioritize the reduction and eventual elimination of the land application of human wastewater biosolids. Establish a “Pilot Projects Program” for funding new state of the art wastewater technologies to improve recovery and afford more efficient use of human wastewater biosolids resources.

## TREASURE COAST REGIONAL PLANNING COUNCIL

MEMORANDUM

To: Council Members

AGENDA ITEM 6

From: Staff

Date: July 20, 2018 Council Meeting

Subject: Management Alternatives for Human Wastewater Biosolids -- Resolution

Introduction

One of the by-products or residuals of the wastewater treatment process is called biosolids or the wet sludge that is left behind after initial processing, which is then collected for further treatment and processing. In Florida, biosolids are either land-applied as a soil amendment to improve agricultural productivity or disposed of in landfills. Either way it is an important source of water, energy, nitrogen, and phosphorous resources that some suggest could be recovered and used more efficiently. There is also concern statewide that excess nutrients from land application of human waste biosolids reach surface waters as a result of rainfall runoff and continue to increase the occurrence of chronic harmful algal blooms (HABs). The purpose of this item and the attached resolution is to inform Council's member counties, municipalities, and their associations about this regional issue and potential solutions.

Background

Today, Florida's central sewer wastewater treatment facilities produce approximately 340,000 dry tons of biosolids. Approximately 100,000 dry tons of biosolids qualify as Class B biosolids, which are treated sewage sludge meeting U.S. Environmental Protection Agency (EPA) guidelines for land application as fertilizer with restrictions, and are allowed to have detectable levels of pathogens. Another 100,000 dry tons of biosolids are deposited in various landfills throughout the state. The final 140,000 dry tons of biosolids are further processed, dried, and composted with material from the landscape industry to produce approximately 200,000 tons of Class AA biosolids, which can then be distributed and marketed as fertilizer. This class of biosolids is unregulated and land-applied mainly on pasture and, to a lesser extent, citrus.

Bahia grass pastures in Florida can generally produce satisfactorily without total Phosphorous (TP) fertilization, and every crop in Florida can be grown economically without the use of biosolids as fertilizer. Biosolids provide an inefficient form of fertilization that provides only a fraction (less than 40%) of plant available nitrogen that can result in both total Nitrogen (TN) and TP over fertilization, which may negatively affect surface and other coastal waters. Of additional concern are compounds found in human wastewater biosolids which may include: hormones; steroids; bacteria; viruses; polychlorinated biphenyls (PCBs); pharmaceuticals; antibodies; polybrominated diphenyl ethers (PBDE fire retardants); polyfluoroalkyl substances

Recommendation

Council should approve Resolution No. 18-03 and authorize its distribution to local government associations and involved state agencies.

Attachments



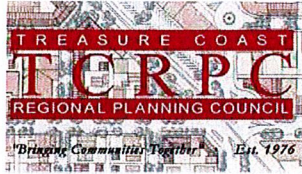

## Executive Summary

### Treasure Coast Regional Planning Council Regional Biosolids Symposium Charting the Future of Biosolids Management June 08, 2018



On Friday June 08, 2018 the Treasure Coast Regional Planning Council and the Indian River Lagoon National Estuaries Program sponsored a “Regional Biosolids Symposium” at the Indian River State College Chastain Campus, Wolf High-Technology Center in Stuart Florida.

With 170 people in attendance, Martin County Commissioner Doug Smith welcomed everyone and put forth a purpose and challenge for the attendees to listen to one another and find a better, more sustainable path forward on how we manage and reuse our biosolids resources.

Henry Dean, St. Johns County Commissioner and former Executive Director for both the St. Johns River Water Management District and the South Florida Water Management District provided opening remarks encouraging that with open minds and cooperative efforts, we can solve any problem.

Jennifer Smith, the Director of the Southeast District, Florida Department of Environmental Protection announced the creation of its Biosolids Technical Advisory Committee to evaluate current management practices and potential opportunities for enhancements to better protect Florida’s water resources.

The event included presentations by wastewater utility representatives from Palm Beach, Martin, St. Lucie, and Indian River counties and the Florida Department of Environmental Protection about standard utility practices and current challenges, programs, and regulations related to providing wastewater services cost effectively to the public and managing disposal of human waste biosolids.

Today, Florida’s central sewer wastewater treatment facilities produce approximately 340,000 tons of biosolids which are the human waste effluents from central sewer wastewater treatment facilities. Approximately 100,000 dry tons of biosolids are designated as Class B biosolids which are treated sewage sludge that meets U.S. Environmental Protection Agency guidelines for land application as fertilizer, and are allowed to have detectable levels of pathogens. Another 100,000 dry tons of biosolids are deposited in various landfills throughout the state. The final 140,000 dry tons of biosolids are further processed, dried, and composted with material from the landscape industry to produce approximately 200,000 tons of Class AA biosolids. These biosolids can then be distributed and marketed as fertilizer. This class of biosolids is unregulated and land-applied mainly on pasture lands, and to a lesser extent on citrus.

Both Class B biosolids and Class AA biosolid fertilizers contain approximately 5.5% Total Nitrogen (TN) and 2.2% Total Phosphorus (TP). Therefore, the 300,000 dry tons of land-applied Class AA and Class B biosolids contribute over 33 million pounds of TN and 13.2 million pounds of TP to agricultural lands each year. While the practice of land-applying

management. His presentation was immediately followed by a panel on the technologies and future trends in biosolids management.

The symposium audience was given a look into the future of biosolids management. Instead of depositing biosolids into the landfill or using agricultural lands to dispose of human biosolid wastes, there are alternatives that allow for improved recovery and sustainable management. The future of biosolids management was discussed by a panel chaired by Fred Mussari, Ph.D., Vice President of Technology at BCR Solid Solutions and included three new technologies.

Although each process is different, all three processes recover useful byproducts from human biosolids and capture its stored energy, water, and nutrients.

Kobe Nagar, P.E., Senior Process Engineer, Pratt School of Engineering at Duke University, presented Supercritical Water Oxidation or SCWO, which is a process that occurs in water at temperatures and pressures above a mixture's thermodynamic critical point. Under these conditions water becomes a fluid with unique properties that can be used to quickly convert biosolids and other hazardous wastes into hot water, electricity,  $\text{CO}_2$ ,  $\text{N}_2$ ,  $\text{O}_2$ , inorganic minerals and distilled water. Duke's vision for the future of SCWO technology is decentralized SCWO treatment facilities that can be housed in a standard 40 foot long container capable of servicing 6,000 people a day. Duke has developed a working industrial scale prototype (A) capable of treating the fecal waste of 1,000 people per day. A new prototype (B) is under design. Its current focus is on technology transfer and commercialization, with the establishment of a spinoff company to bring the first units to the market in 2020.

The Advanced Pyrolysis Technology system was presented by Steve Wirtel, P.E., Executive Vice President of Business Development at Kore Infrastructure. This technology is made up of individual processes that operate in series: material handling, drying, lower-temperature pyrolysis, and gas conversion into renewable natural gas, methane and hydrogen for power generation. These gases can be used to power the process, with the excess sold on the open market. The process produces a crystallized form of carbon termed "biochar." Biochar sequesters carbon in the soil and can be used as a soil supplement to provide soil structure that helps retain key nutrients and water. It does not contain nitrogen or phosphorus. The equipment used in each step is modular, mobile, and compact to enable multiple system configurations and ease in siting requirements.

Peter Janicki, P.E., of Janicki Industries and Bioenergy provided information on Vapor Recompression Distillation (VRD) and Boiler Technology Electric Generation. The combination of these two technologies are also made up of individual components and processes that can operate in series to produce electricity and fresh distilled water. TN is converted to aqueous ammonium, and the TP ends up in its elemental form in the final ash. The aqueous ammonium can be made available as a more efficient N source for fertilizer. The electricity produced provides the power needed to operate the facility with excess electricity sold back to the power grid. The TP in the reduced volume of final ash can now be transported economically to areas that are currently depleted of nutrients such as the "bread basket region" in middle North America from years of corn, wheat, and soy bean production, or the Caribbean which has seen soil nutrient depletion from years of sugar cane production and other practices.



**From:** Florida Department of Environmental Protection [mailto:FloridaDEP@public.govdelivery.com]  
**Sent:** Friday, June 08, 2018 4:12 PM  
**To:** Michael Busha  
**Subject:** DEP Announces Creation of Biosolids Technical Advisory Committee

The Florida Department of Environmental Protection is committed to protecting Florida's water and natural resources. Vital to our mission is working cooperatively with state, local and federal agencies, local communities as well as various stakeholder and interest groups that provide key input, local knowledge and additional data and information to help inform our regulatory and restoration programs.

DEP is aware of an increased interest in better understanding the nutrient impacts of the land application of biosolids. Because the Department remains committed to using science to guide our efforts, we are creating a Biosolids Technical Advisory Committee (TAC) to evaluate current management practices and potential opportunities for enhancements to better protect Florida's water resources.

DEP is currently seeking nominations for membership on the committee, which will include agricultural interests, environmental groups, local governments, academia and research entities, representatives from large and small wastewater utilities (including the Florida Rural Water Association), biosolids haulers and the Florida Onsite Wastewater Association. The deadline for nominations is 5 p.m., July 6, 2018. Any person interested in learning more about the TAC or submitting a nomination may email [BIOSOLIDS\\_TAC@floridadep.gov](mailto:BIOSOLIDS_TAC@floridadep.gov).



SUBSCRIBER SERVICES:

[Manage Preferences](#) | [Delete Profile](#) | [Help](#)

This email was sent using GovDelivery Communications Cloud on behalf of: Florida Department of Environmental Protection · 3900 Commonwealth Boulevard · Tallahassee, FL 32399-3000 · 850.245.2118



# --- Agenda --- Item

11

Staff Summaries

11

11

# Agenda Item

11a

# Grant Activity Sheet (Information Only)

11a

11a

Type	Awarded	Job ID	Funding Agency	Project Manager	Project Name	App Due Date	Date Submitted	Date Awarded/Denied	Date Contract Signed	Project Total	RPC Amt	Start Date	End Date	Status	Total Match Amt-RPC
Grant	Pending	4007	DEO - FL Dept. of Economic Opportunity	C.J. Kammerer	FHERO 2018 RDG Grant		9/11/2018			\$82,300.00	\$6,000.00			Submitted	
Contract	Pending		FDEP - FL Dept. of Environmental Protection	Jim Beever	Ecosystem Services- Aquatic Preserves Valuation		5/1/2018			\$90,000.00	\$90,000.00			Submitted	
Grant	Yes		DEO - FL Dept. of Economic Opportunity	Margaret Wuerstle	Food Safety Plans for SWFL Small-Mid-sized Growers	43227	5/4/2018	9/7/2018		\$30,000.00	\$30,000.00			Not Started	
Grant	Yes	3424	EDA - US Economic Development Administration	Margaret Wuerstle	Regional Sustainability Implementation Study for SWFL Small to Mid-Sized Farms		5/8/2018	8/9/2018	8/13/2018	\$258,182.00	\$113,182.00			Not Started	\$51,637.00
Grant	Yes	3680	EPA - US Environmental Protection Agency	C.J. Kammerer	Brownfields Assessment	11/16/2017	11/16/2017	4/25/2018		\$600,000.00	\$40,000.00	10/1/2018	9/30/2021	Not Started	
Grant	Yes	3723	DEM - FL Div. of Emergency Management	Margaret Wuerstle	FY18-19 Collier_Lee Hazard Analysis			7/31/2018	8/27/2018	\$19,615.00	\$19,615.00	9/1/2018	5/15/2019	In Progress	
Grant	Yes	3180	DEM - FL Div. of Emergency Management	C.J. Kammerer	FY18-19 LEPC Agreement			8/14/2018		\$80,000.00	\$80,000.00	7/1/2018	6/30/2019	In Progress	
Grant	Yes	3900	USDA - US Dept. of Agriculture	Margaret Wuerstle	Rural Promise Zone Designation			5/1/2016		\$0.00	\$0.00			In Progress	
Grant	Yes	3422	EDA - US Economic Development Administration	Sean McCabe	SWFL Disaster Recovery Coordinator		10/31/2017			\$250,000.00	\$200,000.00	1/1/2018	12/31/2019	In Progress	\$50,000.00
Contract	Yes	4101	Glades County	Tim Walker	Glades County SQG 2017-2022				6/6/2017	\$22,500.00	\$22,500.00	6/6/2017	6/6/2022	In Progress	
Grant	Yes		DEM - FL Div. of Emergency Management	C.J. Kammerer	FY17-18 HMEP Agreement			10/1/2017		\$65,161.00	\$65,161.00	10/1/2017	9/30/2018	In Progress	
Grant	Yes	3676	EPA - US Environmental Protection Agency	Jim Beever	Master Wetland Mitigation Strategy			11/3/2016	11/3/2016	\$220,000.00	\$220,000.00	10/1/2016	12/31/2018	In Progress	\$10,000.00
Grant	Yes	3420	EDA - US Economic Development Administration	C.J. Kammerer	FY17-19 EDA Planning Grant			1/1/2017		\$300,000.00	\$210,000.00	1/1/2017	12/31/2019	In Progress	\$90,000.00
Contract	Yes	4212	City of Bonita Springs	Jim Beever	City of Bonita Springs Flood Reduction Project			10/4/2017		\$50,000.00	\$50,000.00	10/4/2017	12/31/2017	Completed	
Grant	Yes		DEO - FL Dept. of Economic Opportunity	Margaret Wuerstle	Regional Strategy for Agriculture Sustainability	6/30/2017		8/17/2017		\$30,000.00	\$30,000.00			Completed	
Grant	Yes	3178	DEM - FL Div. of Emergency Management	Sean McCabe	FY17-18 LEPC Agreement	7/1/2017	7/18/2017			\$80,000.00	\$80,000.00	7/1/2017	6/30/2018	Completed	
Grant	Yes	3722	DEM - FL Div. of Emergency Management	Tim Walker	FY17-18 Collier_Lee Hazard Analysis			7/19/2017	9/13/2017	\$20,844.00	\$20,844.00	7/1/2017	6/30/2018	Completed	
Grant	Yes	4005	DEO - FL Dept. of Economic Opportunity	C.J. Kammerer	2017 FHERO RDG Grant		2/16/2017			\$79,744.00	\$6,000.00		4/30/2018	Completed	
Contract	Yes	3730	SFRPC	C.J. Kammerer	Train the Trainers					\$10,000.00	\$10,000.00	1/1/2016	3/31/2017	Completed	
Contract	Yes	4211	Sarasota County	Jim Beever	Sarasota Climate Change Adaptation Plan					\$20,000.00	\$20,000.00	10/1/2016	5/30/2017	Completed	
	Yes	4210	City of Cape Coral	Jim Beever	Cape Coral Climate Change Resiliency Strategy					\$15,000.00	\$15,000.00		6/30/2017	Completed	
	Yes	3304	DEO - FL Dept. of Economic Opportunity	Margaret Wuerstle	DEO - Labelle Tourism Marketing					\$20,000.00	\$20,000.00	1/1/2017	5/30/2017	Completed	
Grant	Yes	3203	DEM - FL Div. of Emergency Management	Nichole Gwinnett	FY16-17 HMEP Grant	10/1/2016	10/1/2016	10/1/2016	10/1/2016	\$60,349.00	\$60,349.00	10/1/2016	12/31/2017	Completed	
Contract	Yes	4004	Hendry County	Margaret Wuerstle	Clewiston RGBD Grant TA					\$3,000.00	\$3,000.00			Completed	
Contract	Yes	4006	USDA - US Dept. of Agriculture	Margaret Wuerstle	City of Clewiston - Utilities Relocation -- Grant Writing	9/8/2017	9/13/2017	8/10/2017	8/10/2017	\$3,000.00	\$3,000.00	8/10/2017	9/13/2017	Completed	

Type	Awarded	Job ID	Funding Agency	Project Manager	Project Name	App Due Date	Date Submitted	Date Awarded/De nied	Date Contract Signed	Project Total	RPC Amt	Start Date	End Date	Status	Total Match Amt-RPC
Contract	Yes	3525-12	Glades County	Tim Walker	Glades County Small Quantity Generators (SQG)				5/17/2012	\$3,900.00	\$3,900.00	5/17/2012	5/16/2017	Completed	\$0.00
Grant	Yes	3414	EDA - US Economic Development	Margaret Wuerstle	EDA Planning Grant	1/22/2013	12/18/2013	4/18/2014	4/21/14	\$270,000.00	\$189,000.00	1/1/2014	12/31/2016	Completed	\$81,000.00
Grant	Yes	3177	DEM - FL Div. of Emergency Management	Nichole Gwinnett	FY16-17 LEPC Agreement	6/30/2016	4/6/2016	7/1/2016		\$59,000.00	\$59,000.00	7/1/2016	6/30/2017	Completed	\$0.00
Grant	Yes	3399	CTD - FL Commission for the Transportation	Nichole Gwinnett	FY16-17 TD Planning Agreement		5/19/2016	7/1/2016		\$38,575.00	\$38,575.00	7/1/2016	6/30/2017	Completed	\$0.00
Contract	Yes	3721	DEM - FL Div. of Emergency Management	Tim Walker	Collier County Hazard Analysis - FY16-17					\$8,054.00	\$8,054.00	7/1/2016	6/30/2017	Completed	\$0.00
Grant	Yes	3302	DEO - FL Dept. of Economic Opportunity	Margaret Wuerstle	DEO - City of Fort Myers - MLK Corridor	5/31/2015	5/1/2015		11/17/2015	\$30,000.00	\$30,000.00	1/1/2016	7/30/2016	Completed	
Contract	Yes	3534	City of Bonita Springs	Jim Beever	City of Bonita Springs - Spring Creek Restoration Plan	7/1/2014	7/1/2014	8/11/2014	8/11/2014	\$50,000.00	\$50,000.00	8/11/2014		Completed	
Contract	Yes	3201	DEM - FL Div. of Emergency Management	Nichole Gwinnett	FY15-16 HMEP Planning	9/28/2015	9/28/2015	9/28/2015	9/28/2015	\$15,500.00	\$15,500.00	10/1/2015	9/30/2016	Completed	
Grant	Yes	3419	Charlotte County	Margaret Wuerstle	DEO - Charlotte County			3/30/2016	3/30/2016	\$500.00	\$500.00			Completed	
Contract	Yes	3170	DOE - US Dept. of Energy	Rebekah Harp	Solar Ready II		3/22/2013	7/18/2013		\$140,000.00	\$90,000.00	7/1/2013	1/1/2016	Completed	\$50,000.00
Grant	Yes	3673	EPA - US Environmental Protection Agency	Jim Beever	A Unified Conservation Easement Mapping and Database for the State of	4/15/2013	4/8/2013	6/3/2013		\$294,496.00	\$148,996.00	10/1/2013	9/30/2015	Completed	\$145,500.00
Contract	Yes	3674	EPA/CHNEP - Charlotte Harbor National Estuary Program	Jim Beever	Mangrove Loss Project	4/4/2014	4/4/2014	12/19/2014		\$243,324.00	\$60,000.00	12/1/2014	9/30/2016	Completed	
Grant	Yes	3397	CTD - FL Commission for the Transportation	Nichole Gwinnett	Glades-Hendry TD Planning Agreement FY2014-15			5/16/2014		\$38,573.00	\$38,573.00	7/1/2014	6/30/2015	Completed	\$0.00
Grant	Yes	3725	Visit Florida	Tim Walker	OUR CREATIVE ECONOMY Marketing	2/9/2015	2/9/2015	6/25/2015	6/26/2015	\$5,000.00	\$2,500.00	7/1/2015	6/15/2016	Completed	\$2,500.00
Grant	Yes	3164	DEM - FL Div. of Emergency Management	Nichole Gwinnett	FY14-15 HMEP Planning				2/4/2015	\$22,000.00	\$22,000.00	10/1/2014	9/30/2015	Completed	\$0.00
Grant	Yes	3675	EPA - US Environmental Protection Agency	Jim Beever	Developing a Method to Use Ecosystem Services to	5/15/2015	5/5/2015	9/29/2015	9/29/2015	\$234,071.00	\$174,071.00	10/1/2015	9/30/2016	Completed	\$60,000.00
Grant	Yes	3171	DEM - FL Div. of Emergency Management	Nichole Gwinnett	FY15-16 LEPC Agreement	6/30/2015	5/15/2015	6/11/2015	6/11/2015	\$48,000.00	\$48,000.00	7/1/2015	6/30/2016	Completed	\$0.00
Grant	Yes	3398	CTD - FL Commission for the Transportation Disadvantaged	Nichole Gwinnett	FY15-16 Glades-Hendry TD Agreement	6/30/2015	6/1/2015	7/1/2015	7/1/2015	\$38,573.00	\$38,753.00	7/1/2015	6/30/2016	Completed	\$0.00
Grant	Yes	3202	DEM - FL Div. of Emergency Management	Nichole Gwinnett	FY14-15 HMEP Planning Grant Modification			9/11/2015		\$50,000.00	\$50,000.00	10/1/2015	12/15/2015	Completed	\$0.00
Contract	Yes	3173	DEM - FL Div. of Emergency Management	Nichole Gwinnett	FY15-16 HMEP Training Contract	10/1/2015	9/30/2015	9/28/2015	9/28/2015	\$58,422.00	\$58,422.00	10/1/2015	9/30/2016	Completed	\$0.00
Contract	Yes	3418	Collier County	Rebekah Harp	Marketing & Data Research					\$1,200.00	\$1,200.00	12/4/2015	1/29/2016	Completed	
Grant	Yes	3176	DOE - US Dept. of Energy	Rebekah Harp	NARC - SM3 - 2016 Data Surveys			2/11/2016		\$1,000.00	\$1,000.00	2/1/2016	3/31/2016	Completed	
PO	Yes	3005	Collier County	Margaret Wuerstle	Collier County EDC - USDA Grant Application			3/15/2016	3/22/2016	\$3,000.00	\$3,000.00	3/23/2016	3/31/2016	Completed	
Grant	Yes	3301	DEO - FL Dept. of Economic Opportunity	Margaret Wuerstle	Clewiston Mainstreet Revitalization			12/8/2015		\$30,000.00	\$30,000.00	12/14/2015	6/30/2016	Completed	

Type	Awarded	Job ID	Funding Agency	Project Manager	Project Name	App Due Date	Date Submitted	Date Awarded/Denied	Date Contract Signed	Project Total	RPC Amt	Start Date	End Date	Status	Total Match Amt-RPC
Grant	Yes	3303	DEO - FL Dept. of Economic Opportunity	Margaret Wuerstle	DEO - MPO Rail Study						\$39,000.00	10/7/2015	5/31/2016	Completed	
PO	Yes	4002	NEFRC - Northeast Florida Regional Council	Tim Walker	2016 SRESP Update					\$14,200.00	\$14,200.00	4/28/2016	7/19/2016	Completed	
PO	Yes	4003	Rural Neighborhoods	Tim Walker	Rural Neighborhoods Mapping					\$750.00	\$750.00	6/1/2016	6/30/2016	Completed	
Contract	Yes	3720	DEM - FL Div. of Emergency Management	Tim Walker	Collier Hazard Analysis FY15-16					\$9,693.00	\$9,693.00	7/1/2015	6/30/2016	Completed	
Contract	Yes	3520	TBRPC - Tampa Bay Regional Planning Council	Rebekah Harp	2016 Disaster Planning Guide					\$4,000.00	\$4,000.00	2/1/2016	4/30/2016	Completed	
PO	Yes	3006	SWFEC - Southwest Florida Enterprise Center	Margaret Wuerstle	SWFEC PRIME - Grant Application/Technical Assistance					\$5,000.00	\$5,000.00	5/1/2016	5/30/2016	Completed	
Contract	Yes	3004	NARC - National Association of Regional Councils	Rebekah Harp	MARC Travel SRII					\$379.58	\$379.58	10/1/2015	5/31/2016	Completed	
PO	Yes	4001	Collier County	Margaret Wuerstle	Collier County EDA TA					\$5,000.00	\$5,000.00	4/18/2016	5/30/2016	Completed	
Contract	Yes	6200	FDEP - FL Dept. of Environmental Protection	Margaret Wuerstle	2016 Brownfields Event					\$6,887.61	\$6,887.61	4/1/2016	10/30/2016	Completed	
Grant	No		EPA - US Environmental Protection Agency	Jim Beever	WPDG- CHNEP Wetland Connectivity		5/8/2018			\$204,120.00	\$145,246.00			Denied	
Grant	No		DEO - FL Dept. of Economic Opportunity	Tim Walker	Storm Surge Evac Routes & Shelters Interactive GIS Web Map	5/7/2018	5/4/2018	9/7/2018		\$35,000.00	\$35,000.00			Denied	
Grant	No		DEO - FL Dept. of Economic Opportunity	Margaret Wuerstle	Affordable Housing Directory of Resources	5/7/2018	5/1/2018	9/7/2018		\$40,000.00	\$40,000.00			Denied	
Grant	No		DEO - FL Dept. of Economic Opportunity	Margaret Wuerstle	SWFL Opioid Resource Guide	5/7/2018	5/1/2018	9/7/2018		\$40,000.00	\$40,000.00			Denied	
Grant	No		Bloomberg Philanthropies	Margaret Wuerstle	Bloomberg - City of Bonita Springs Mitigation	10/20/2017	10/19/2017			\$1,000,000.00	\$60,000.00			Denied	
Grant	No		SWFL Community Foundation	Margaret Wuerstle	Community Impact Grants - MLK Corridor	11/3/2017	11/2/2017			\$50,000.00				Denied	
Grant	No		DEO - FL Dept. of Economic Opportunity	Jennifer Pellechio	Economic Opportunity Map		4/27/2016	6/28/2016		\$40,000.00				Denied	
Grant			DEO - FL Dept. of Economic Opportunity	Margaret Wuerstle	Florida Ocean Alliance		5/2/2016	6/28/2016		\$28,000.00				Denied	
Grant	No		DEO - FL Dept. of Economic Opportunity	Margaret Wuerstle	Clewiston Downtown District Facade Program		5/2/2016	6/28/2016		\$30,000.00				Denied	
Grant	No		AETNA	Jason Stoltzfus	Cultivating Healthy Communities	4/15/2016	4/13/2016			\$100,000.00	\$100,000.00			Denied	
Grant	No		EPA - US Environmental Protection Agency	Jason Stoltzfus	2016 Brownfield Assessment		12/18/2015			\$280,000.00	\$46,900.00			Denied	
Grant	No		USDA - US Dept. of Agriculture	Margaret Wuerstle	Mobile Market: A Nutritional Oasis for Food Markets of SWFL	3/31/2014	3/31/2014	10/1/2014		\$599,549.00	\$298,605.00	10/1/2014	9/30/2017	Denied	
Grant	No		EDA - US Economic Development Administration	Rebekah Harp	Mote Marine Programming	8/31/2012	8/31/2012	8/31/2012		\$270,000.00	\$189,000.00	1/1/2014	12/31/2016	Denied	\$81,000.00
Grant	No		USDA - US Dept. of Agriculture	Nichole Gwinnett	Opportunity Buy Program Coordinator	4/23/2013	4/23/2013	11/20/2013		\$99,667.00	\$15,000.00	11/1/2013	10/31/2015	Denied	\$53,621.00



# --- Agenda --- Item

12

SWFRPC Committee Reports

12

12

# Agenda Item

12a

12a

# Executive Committee

12a

# --- Agenda --- Item

12b

12b

Promise Zone Steering  
Committee

12b

# --- Agenda --- Item

12c

12c

Estero Bay Agency  
on Bay Management

12c

# --- Agenda --- Item

12d

12d

Quality of Life  
and Safety Committee

12d

# Agenda Item

12e

12e

# Regional Transportation Committee

12e

# Agenda Item

12f

12f

Council Relevancy and  
Restructuring Committee

12f

# Agenda Item

12g

12g

Water Quality and Water  
Resources Management  
Committee

12g